

TEL: 770.452.7849 FAX: 770.452.0086
2951 FLOWERS RD S, STE 119
ATLANTA, GEORGIA 30341
WWW.EBERLY.NET

LAND PLANNING

CIVIL ENGINEERING

LANDSCAPE ARCHITECTURE

GLOCK 5040

LAND LOT 545
17TH DISTRICT
COBB COUNTY, GEORGIA
5040 HIGHLAND PARKWAY

PROJECT:

REVISIONS:

1/26/2023	CITY COMMENTS 1
2/14/2023	REGRADE WALL
2/20/2023	IFC SET
4/06/2023	FENCE COORD.

LAYOUT & STAKING
PLAN

PROJECT NO.

22-100

SHEET NO.

C3.0

ISSUED FOR
CONSTRUCTION

IMPERVIOUS NOTES

PRE DEVELOPED CONDITIONS: 2.8 ACRES OF IMPERVIOUS AREA
DEVELOPED CONDITIONS: 3.0 ACRES OF IMPERVIOUS AREA

CITY OF SMYRNA PUBLIC WORKS NOTE

ALL STRIPING WITHIN RIGHT OF WAY SHALL BE THERMOPLASTIC

PAVING LEGEND

	CONCRETE PAVING
	L.D. ASPHALT
	CITY OF SMYRNA ASPHALT
	CONCRETE S/W
	CONCRETE S/W

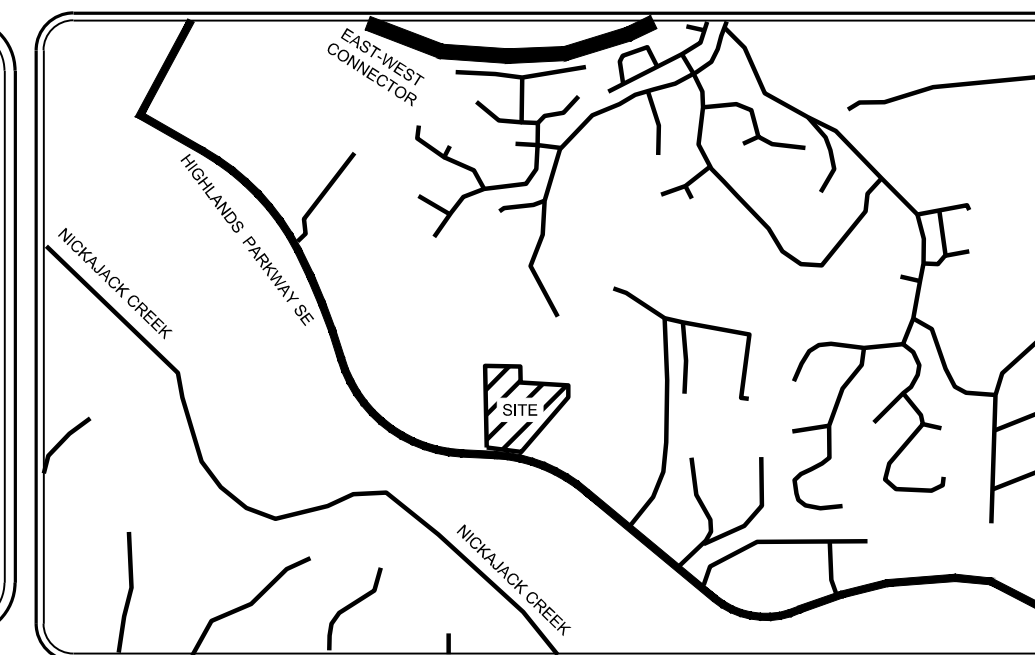

LOCATION MAP
N.T.S.

NOTES

- USE ARCHITECTURAL PLANS FOR BUILDING STAKE OUT.
- ALL DIMENSIONS SHOWN ARE FROM FACE OF BUILDING, CURB, OR WALL UNLESS OTHERWISE NOTED.

PROJECT INFORMATION

SITE DATA

ZONING USE: LI
TOTAL ACREAGE: 5.515
DISTURBED ACREAGE: 2.5
COBB COUNTY, GA
LAND LOT 545, 17TH DISTRICT
PARCEL #: 17054500180
SETBACKS:
FRONT: 30 ft.
SIDE: 20 ft.
BACK: 20 ft.

BUILDING DATA

BUILDING SQUARE FOOTAGE: 65,206 sq. ft.

PARKING DATA

REQUIRED PARKING
PARKING: 4 SPACES MINIMUM
+ 1 SPACE / 2000 SQ FT
= 33 SPACES
PARKING PROVIDED:
60 TOTAL SPACES
4 HANDICAP SPACES EXISTING

UTILITY PROVIDERS

WATER: CITY OF SMYRNA SERVICES
SEWER: CITY OF SMYRNA SERVICES

OWNER/DEVELOPER (PRIMARY PERMITTEE)

GERMAN RODRIGUEZ
6000 HIGHLANDS PARKWAY
SMYRNA, GA 30082
(678) 285-4471
GERMAN.RODRIGUEZ@GLOCK.US

ENGINEER

BRIAN BRUMFIELD, P.E.
EBERLY & ASSOCIATES, INC.
2951 FLOWERS ROAD SOUTH
SUITE 119
ATLANTA, GEORGIA 30341
(770) 452-7849
BBRUMFIELD@EBERLY.NET

24 HOUR CONTACT

GERMAN RODRIGUEZ
(678) 285-4471
GERMAN.RODRIGUEZ@GLOCK.US



GRAPHIC SCALE

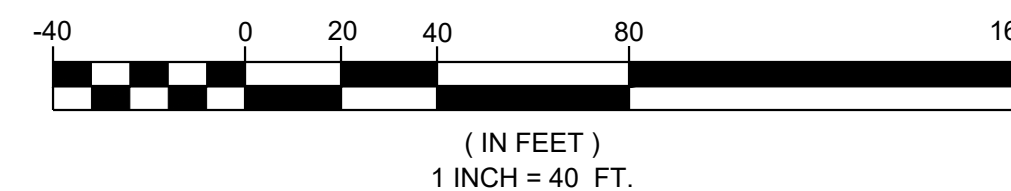

CALL 811

FREE THROUGHTOUT
THE U.S.A.

THREE WORKING DAYS
BEFORE YOU DIG.



Know what's below.
Call before you dig.

