

# Smyrna Market Village

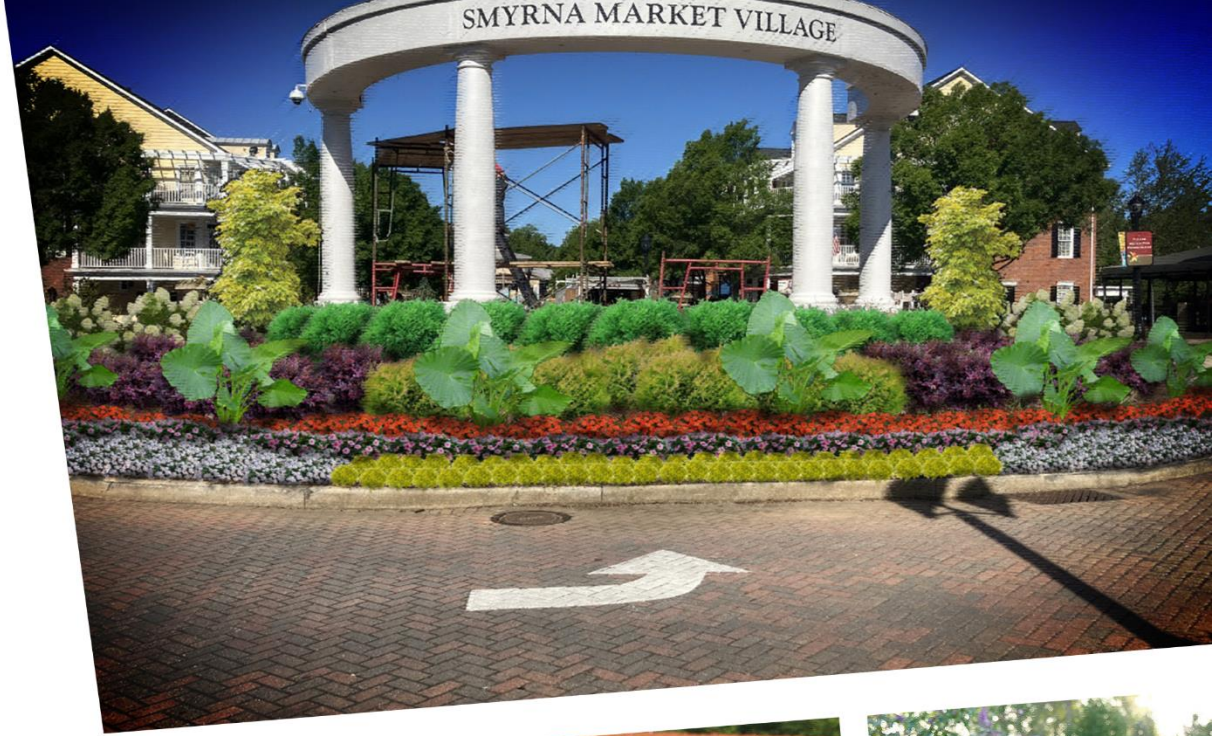

LANDSCAPE CONCEPTUAL DESIGN

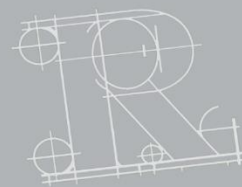

**RUSSELL**  
LANDSCAPE





## AREA KEY

- A.1 – Market Village Sign
- A.2 – Entry Island
- A.3 – Large Entry Island
- A.4 – Interior Island
- A.5 – Interior Island
- A.6 – Interior Island
- A.7 – Median Island
- A.8 – Direction Sign
- A.9 – Pavilion





# Market Village Sign



Before



Enhance entry sign to Market Village with seasonal color and an array of evergreen and deciduous plant material providing color and interest. Frame the signage using Green Mountain Boxwood.

After



Designer  
Jai Means  
4300 Woodward Way  
Sugar Hill, GA 30518  
470.371.4138  
jaim@russelllandscape.com

Branch: Cobb

Property Address:  
Spring Street  
Smyrna, GA 30080

Manager: Ryan Woolridge

Smyrna Market Village

Date: 6.14.23

Designed By: Jai Means

# A.1



# Entry Island Planting



Before



Matching the Market Village Sign – Boxwood, Loropetalum, Butterfly Bush and Distylium – greet each vehicle as it arrives onto the site.

After



Designer  
Jai Means  
4300 Woodward Way  
Sugar Hill, GA 30518  
470.371.4138  
jaim@russelllandscape.com

Branch: Cobb

Property Address:  
Spring Street  
Smyrna, GA 30080

Manager: Ryan Woolridge

Smyrna Market Village

Date: 6.14.23

Designed By: Jai Means

# A.2



# Entry Island Planting



Before



After

Frame columns and architecture using Summer Gold Dogwoods. Create an evergreen background for seasonal color using Globe Cryptomeria, Fire Chief Arborvitae and Crimson Fire Loropetalum. Little Lime Hydrangeas provide additional summer color and interest.



Designer  
Jai Means  
4300 Woodward Way  
Sugar Hill, GA 30518  
470.371.4138  
jaim@russelllandscape.com

Branch: Cobb

Property Address:  
Spring Street  
Smyrna, GA 30080

Manager: Ryan Woolridge

Smyrna Market Village

Date: 6.14.23

Designed By: Jai Means

A.3



## Interior Island Planting



Before



Add interest, color and texture using Hydrangeas, Loropetalum, Distylium and Carex around the walls of seating and turf areas. This combination of plant material creates an inviting and welcoming feeling while providing year-round interest.

After



Designer  
Jai Means  
4300 Woodward Way  
Sugar Hill, GA 30518  
470.371.4138  
jaim@russelllandscape.com

Branch: Cobb

Property Address:  
Spring Street  
Smyrna, GA 30080

Manager: Ryan Woolridge

Smyrna Market Village

Date: 6.14.23

Designed By: Jai Means

# A.4



## Interior Island Planting



Before



After

In smaller planting beds add use Coppertone Distylium and Ice Dance Carex to soften the brick walls and paving.



Designer  
Jai Means  
4300 Woodward Way  
Sugar Hill, GA 30518  
470.371.4138  
jaim@russelllandscape.com

Branch: Cobb

Property Address:  
Spring Street  
Smyrna, GA 30080

Manager: Ryan Woolridge

Smyrna Market Village

Date: 6.14.23

Designed By: Jai Means

# A.5



# Interior Island Planting



Before



Add Spring Bouquet Viburnum on the outside walls providing year round color and seasonal flowering.

After



Designer  
Jai Means  
4300 Woodward Way  
Sugar Hill, GA 30518  
470.371.4138  
jaim@russelllandscape.com

Branch: Cobb

Property Address:  
Spring Street  
Smyrna, GA 30080

Manager: Ryan Woolridge

Smyrna Market Village

Date: 6.14.23

Designed By: Jai Means

# A.6



# Median Island Planting



Before



In the central median island add Green Mountain Boxwood, Pugster Butterfly Bush and Carex to break up the long linear island.

After



Designer  
Jai Means  
4300 Woodward Way  
Sugar Hill, GA 30518  
470.371.4138  
jaim@russelllandscape.com

Branch: Cobb

Property Address:  
Spring Street  
Smyrna, GA 30080

Manager: Ryan Woolridge

Smyrna Market Village

Date: 6.14.23

Designed By: Jai Means

A.7



# Signage Planting



Before



After

Remove existing plant material from behind sign and replace with an array of plant material providing color in both foliage and bloom. Loropetalum, Butterfly Bush, Viburnum, and Hydrangea will provide year-round interest and ties the area to the rest of the site.



Designer  
Jai Means  
4300 Woodward Way  
Sugar Hill, GA 30518  
470.371.4138  
jaim@russelllandscape.com

Branch: Cobb

Property Address:  
Spring Street  
Smyrna, GA 30080

Manager: Ryan Woolridge

Smyrna Market Village

Date: 6.14.23

Designed By: Jai Means

A.8



# Pavilion Island Planting



Before



Weeping Redbuds are a focal point and frame the entrance to the pavilion. A mass planting of Fire Chief Arborvitae and Switch Grass provide color and texture. Ajuga creates a ground level planting full of color.

After



Designer  
Jai Means  
4300 Woodward Way  
Sugar Hill, GA 30518  
470.371.4138  
jaim@russelllandscape.com

Branch: Cobb

Property Address:  
Spring Street  
Smyrna, GA 30080

Manager: Ryan Woolridge

Smyrna Market Village

Date: 6.14.23

Designed By: Jai Means

# A.9