

**SIGN-24-74****Sign Permit**

Status: Active

Submitted On: 3/28/2024

Primary Location0 ATLANTA RD SE
SMYRNA, GA 30080**Owner**PARKLANE CAPITAL II LLC
VILLAGE PKY BUILDING 2 111
MARIETTA, GA 30067**Applicant**

Michael Fitzgerald



678-571-8889



fitzgeraldland@gmail.com



3162 Johnson Ferry Rd, Ste

260-441

Marietta, GA 30062

Internal Only

Additional Comments/Notes**Work without Permit**

—

Non-conforming Sign

—

Type of Sign Permit

Sign Type*

Monument

Is this an illuminated sign?*

Yes

Is the sign internally or externally illuminated?*

External

Monument Sign Permit Information

Type of Sign*

Freestanding (General)

Sign Area (sq. ft.)*

375

Height of Sign* ?

40

Number of Sign Faces*

2

Construction Cost of Sign (\$)*

57000

Will sign have electronic messaging?*

Yes

Brief Description of Work*

Install Freestanding Off-Premise Advertising Sign with LED Digital Faces

Property Owner Information

Full Name (i.e., First and Last Name, or Name of Entity):*

Michael B. Fitzgerald, Manager Atlantic Billboards, LLC

Street Address*

3162 Johnson Ferry Rd #260-441

City*

Marietta

State*

GA

Zip Code*

30062

Phone Number

678-571-8889

Email

mike@atlanticbillboards.com

Registered Engineer

Name*

Alexander Ginn

Business Name*

Ginn Engineering Services

Business License Number* ?

OC45301

State License Number*

PE045301

Sign Contractor

Business Name*

Bowen Auger Service, Inc.

Contact Person*

Alishia Bragg

Street Address*

PO Box 178

City*

Adairsville

State*

GA

Zip Code*

30103

Phone Number*

770-386-9724

Email Address*

bowenauger@aol.com

Business License Number* ?

H014

License Expiration Date*

01/01/2025

Insurance Policy Expiration Date*

07/14/2024

Electrical Contractor Information

Business Name*

Paragon Electric, LLC

Contact Person*

John Blue

Street Address*

137 Siena Dr

City*

Cartersville

State*

GA

Zip Code*

30120

Phone Number*

404-409-6597

Email Address*

paragonelectric@gmail.com

GA Contractor License Number*

EN211757

GA Contractor License Expiration Date*

06/30/2024

Certification

Owner and/or agent hereby agrees that he or she will comply with all requirements of the City of Smyrna's Sign Ordinance currently in effect. Also, that the sign will not be located within the street right-of-way or block the view of any intersection.

Applicant Signature*

☒ Michael B Fitzgerald
Mar 28, 2024

I have read and understand Chapter 82 of the City's Code of Ordinances and I agree to comply with its regulations.

Applicant Signature*

✓ Michael B Fitzgerald
Mar 28, 2024

Acknowledgement

Applicant Signature*

✓ Michael B Fitzgerald
Mar 28, 2024

Attachments



Addendum to Sign Permit Application non rail.pdf
Addendum to Sign Permit Application non rail.pdf
Uploaded by Michael Fitzgerald on Mar 28, 2024 at 3:07 PM



Pat Mell Atlanta Rd.pdf
Pat Mell Atlanta Rd.pdf
Uploaded by Michael Fitzgerald on Mar 28, 2024 at 3:07 PM



Formetco 10 6 x 36 package.pdf
Formetco 10 6 x 36 package.pdf
Uploaded by Michael Fitzgerald on Mar 28, 2024 at 3:07 PM



FORMAL RESPONSE_SIGN-24-74_LETTER.pdf
FORMAL RESPONSE_SIGN-24-74_LETTER.pdf
Uploaded by Joey Staubes on May 6, 2024 at 10:31 AM



Property Owner Authorization REQUIRED
Pat Mell and Atlanta Rd signed.pdf
Uploaded by Michael Fitzgerald on Mar 28, 2024 at 3:06 PM



Sign Contractor Proof of Insurance REQUIRED
ACORD Form 20240213-100115.pdf
Uploaded by Michael Fitzgerald on Mar 28, 2024 at 3:06 PM

**Sign Contractor Business License**

REQUIRED

Contractor Biz License.pdf

Uploaded by Michael Fitzgerald on Mar 28, 2024 at 3:06 PM

**Dimensioned Sign Rendering**

REQUIRED

1 AG-076 10'x36' FF 15'V 40'T LED Smyrna GA 110 IBC_Stamped Letter.pdf

Uploaded by Michael Fitzgerald on Mar 28, 2024 at 3:06 PM

**Engineering Plan**

REQUIRED

1 AG-076 10'x36' FF 15'V 40'T LED Smyrna GA 110 IBC_Stamped Letter.pdf

Uploaded by Michael Fitzgerald on Mar 28, 2024 at 3:06 PM

History

Date	Activity
5/6/2024, 10:37:02 AM	Joey Staubes altered Record SIGN-24-74, changed status from Stopped to Active
5/6/2024, 10:37:02 AM	Joey Staubes altered approval step Review of Sign Permit Application , changed status from Rejected to On Hold on Record SIGN-24-74
5/6/2024, 10:31:14 AM	Joey Staubes altered Record SIGN-24-74, changed status from Active to Stopped
5/6/2024, 10:31:14 AM	Joey Staubes altered approval step Review of Sign Permit Application , changed status from Active to Rejected on Record SIGN-24-74
3/28/2024, 3:59:57 PM	approval step Review of Sign Permit Application was assigned to Joey Staubes on Record SIGN-24-74
3/28/2024, 3:59:56 PM	Michael Fitzgerald submitted Record SIGN-24-74
3/28/2024, 2:24:10 PM	Michael Fitzgerald altered Record SIGN-24-74, changed ownerPhoneNo from "" to "770-226-1000"
3/28/2024, 2:24:10 PM	Michael Fitzgerald altered Record SIGN-24-74, changed ownerStreetName from "111 VILLAGE PKY BUILDING 2" to "VILLAGE PKY BUILDING 2"
3/28/2024, 2:24:10 PM	Michael Fitzgerald altered Record SIGN-24-74, changed ownerStreetNo from "" to "111"
3/28/2024, 2:24:10 PM	Michael Fitzgerald altered Record SIGN-24-74, changed ownerEmail from "" to "tmorris@tierraco.com"

Date	Activity
3/28/2024, 2:22:01 PM	Michael Fitzgerald started a draft of Record SIGN-24-74

Timeline

Label	Activated	Completed	Assignee	Due Date	Status
✓ Review of Sign Permit Application	3/28/2024, 3:59:56 PM	-	Joey Staubes	-	On Hold
💰 Payment of Permit Fees	-	-	Michael Fitzgerald	-	Inactive
📄 Issuance of Sign Permit	-	-	-	-	Inactive
🔧 Building Inspection-Sign- Electrical	-	-	-	-	Inactive
🔧 Building Inspection-Sign- Footing	-	-	-	-	Inactive
🔧 Building Inspection-Sign- Final	-	-	-	-	Inactive
✓ Completion of Permit	-	-	-	-	Inactive



City of Smyrna, GA

Jul 12, 2024

SIGN-24-74

Review of Sign Permit Application

Sign Permit

Status: On Hold**Became Active:** Mar 28, 2024**Assignee:** Joey Staubes**Completed:** May 6, 2024

Applicant

Michael Fitzgerald
fitzgeraldland@gmail.com
3162 Johnson Ferry Rd, Ste 260-441
Marietta, GA 30062
678-571-8889

Primary Location

O ATLANTA RD SE
SMYRNA, GA 30080

Owner:

PARKLANE CAPITAL II LLC
111 VILLAGE PKY BUILDING 2 MARIETTA, GA
30067

Comments

Joey Staubes , May 6, 2024

This sign permit is denied based on the non-compliance with the regulations established in Chapter 82, Section 15 of the Smyrna Code of Ordinances. The proposed sign exceeds both the maximum area (32 square feet) and maximum height (8 feet) specified by the ordinance, is not a ground based monument sign as required by the ordinance and is a pole sign as prohibited by the ordinance.

A formal response is attached.

Addendum to Sign Permit Application

1. Please note that the online permit submittal portal located at <https://smyrnaga.portal.opengove.com> did not offer an option that matches the type of sign requested. The proposed sign is commonly called a “freestanding sign” or an “off-premise sign.”



Note: All portions of proposed sign to be over 10 feet from any sidewalk, over 15 feet from the edge of the road if no sidewalk exists, and over 25 feet from any point where right-of-way lines intersect for two streets or roads. No reduction in parking.

Diagram of Proposed Sign

Size of Subject Parcel: 0.324 +/- Acres

Project Address
 NW Corner Pat Mell
 and Atlanta Road
 Smyrna Georgia

Project Contact
 Mike Fitzgerald
 (678) 571-8889
Mike@AtlanticBillboards.com

ATLANTIC

STANDARD CONFIGURATION

DESIGN PARAMETERS PER REQUIREMENTS OF
IBC 2018/IBC 2020/ASCE 7-16, 175 mph

MAXIMUM UPRIGHT SPACING: 8'-4 1/8" (2560mm)
ALLOWABLE CANTILEVER: 4'-2 3/8" (1280mm) MAX.
CONTINUOUS 4"x4"x3/8" S.A. LEDGER OR EQUIVALENT

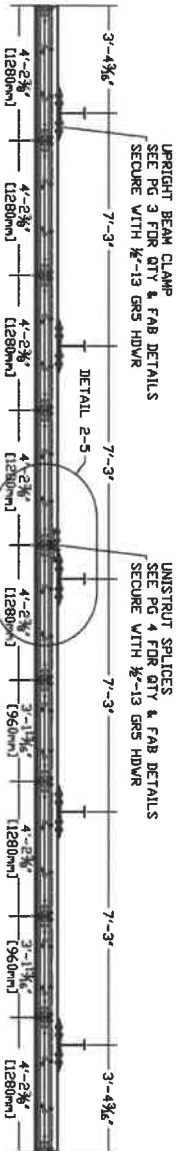

- ON-SITE SERVICE REQUIREMENTS
- 1) THE DISPLAY MUST BE ACCESSIBLE THROUGH USE OF A 20 FOOT OR SHORTER LADDER
 - 2) THERE MUST BE A SECURE CATWALK OR BASE FROM WHICH SERVICE MAY BE PERFORMED
 - 3) ALL REAR SERVICED DIGITALS REQUIRE CATWALK SPACED AT NO GREATER THAN 7'-6" IN HEIGHT
 - 4) THERE MUST BE A GUARD RAIL OR A SAFETY LIFELINE SECURELY ATTACHED TO THE SUPPORT STRUCTURE IF THE DISPLAY IS OVER 6 FEET ABOVE THE GROUND (COLLECTIVELY KNOWN AS AN ACCESSIBLE SITE). THE CUSTOMER IS RESPONSIBLE FOR THE COST OF A BUCKET OR BOOM TRUCK CAPABLE OF PROVIDING SAFE ACCESS TO THE DISPLAY. SERVICE WILL BE PERFORMED ONLY IF THERE IS SAFE ON-SITE ACCESS IN COMPLIANCE WITH APPLICABLE FEDERAL AND LOCAL LAWS AND REGULATIONS.

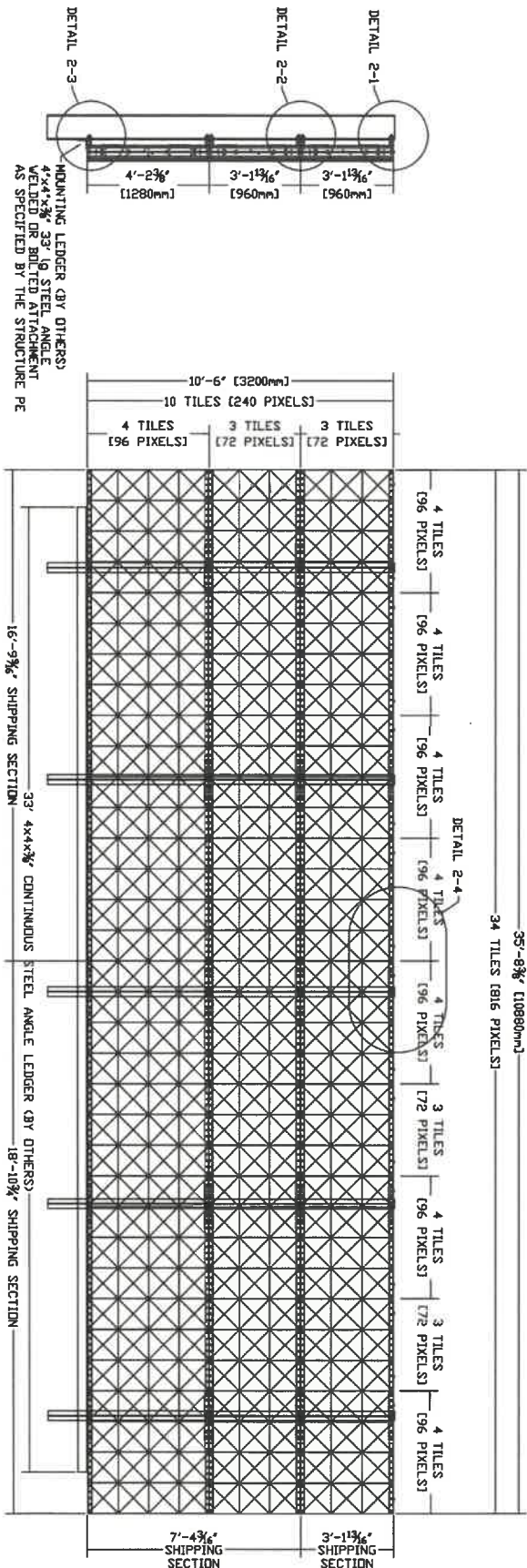

SEE B-2830 FOR POWER RISER AND DATA LAYOUT

PRODUCTION NOTES:
1) CABINET POWER PRE-WIRED BY COLUMN
2) TRIM COLOR - AS REQ'D
3) USE 1/2"-13 GRADE 5 SERRATED FLANGE BOLTS
AND NUTS UNLESS OTHERWISE NOTED
4) ALL FABRICATED ALUMINUM AND STEEL PARTS
TO BE PAINTED SATIN BLACK.

APPROXIMATE 13.3mm, 16mm, 20mm SIGN WEIGHT - NO TRIM

	10mm	13.3mm	16mm	20mm
QUANTITY	759#	759#	759#	759#
WEIGHT	150#	150#	150#	150#
PRICE	3,935#	3,749#	3,749#	3,749#
TOTAL	4,844#	4,658#	4,658#	4,658#

REVISIONS			
REV	DESCRIPTION	DATE	APPD
A	MISC. UPDATES AND CORRECTIONS	6-29-21	RFV
REV	DESCRIPTION	DATE	APPD
1	13.3mm 240 x 816 DBB U-STRUT MT	08-23	RFV
2	10'-6" x 35'-8" 13.3mm FTX-A DBB	08-23	RFV

THIS MATERIAL IS THE EXCLUSIVE CONFIDENTIAL PROPERTY OF FORMETCO, INC.
ALL RIGHTS, INCLUDING COPYRIGHT AND PATENT RIGHTS, ARE RESERVED BY FORMETCO, INC.

PART NUMBER: FTX-A DBB
2963 Pleasant Hill Rd. Duluth, GA 30096-3811
13.3mm 240 x 816 DBB U-STRUT MT
10'-6" x 35'-8" 13.3mm FTX-A DBB

ALL CONFIGURATIONS

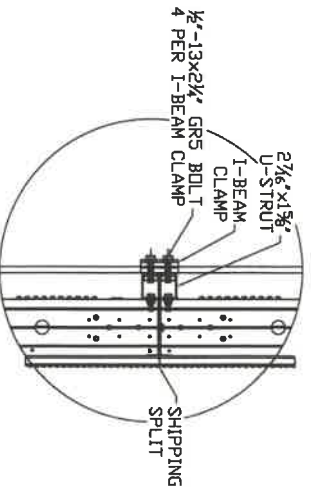
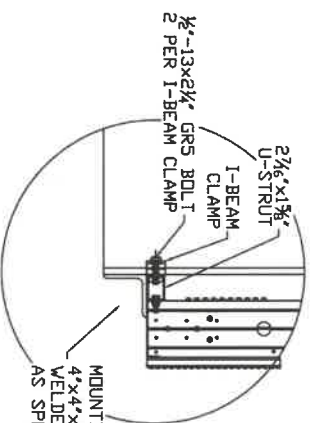
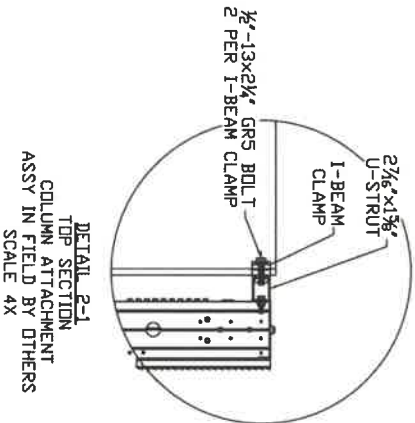
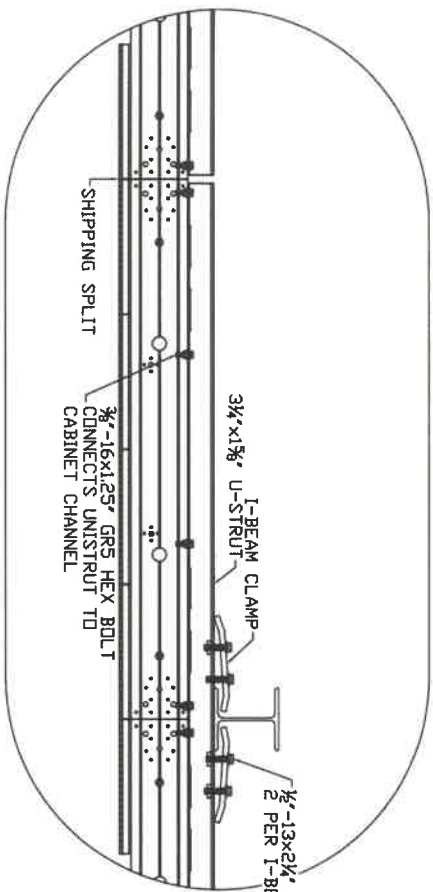
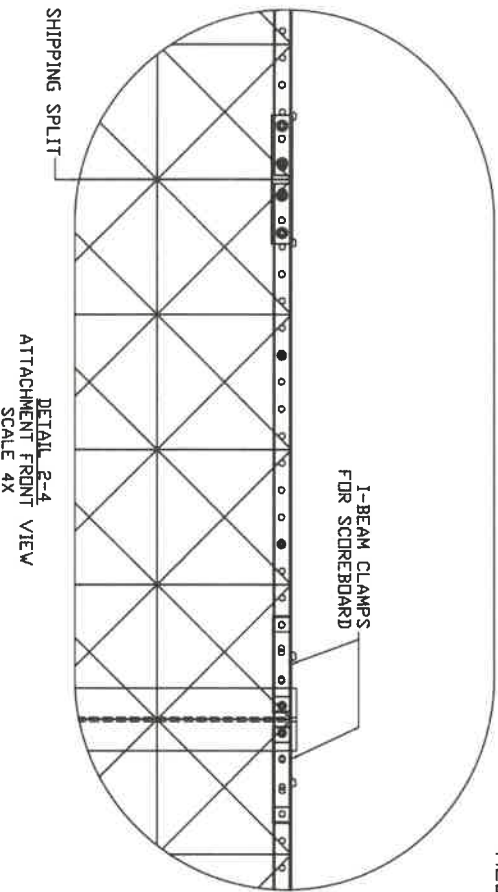

1 3/4" x 2-3/4" U-STRUT
12ga GALVANIZED
STRUCTURAL STEEL OR EQUIV
NOT TO SCALE

2 7/16" 1 3/8" 1 3/8" 0.105" 1 3/8" 1 3/8" 1 3/8"

DETAIL 2-5
TYP. ATTACHMENT AT UPRIGHTS
ASSY IN FIELD BY OTHERS
SCALE 4X

REV	DESCRIPTION	DATE	APPD	REV	DATE	APPD
A	MISC. UPDATES AND CORRECTIONS	6-29-21	RPV			

REVISIONS

THIS MATERIAL IS THE EXCLUSIVE CONFIDENTIAL PROPERTY OF FORMETCO, INC.
ALL RIGHTS, INCLUDING COPYRIGHT AND PATENT RIGHTS, ARE RESERVED BY FORMETCO, INC.

PART NUMBER
FTX-A DBB

APPROVALS
DATE 08-23
DATE 8-22-23

U-STRUT UPRIGHT CONNECTION DETAIL
10'-6" x 35'-8" 13.3mm FTX-A DBB

2963 Pleasant Hill Rd. Duluth, GA 30096-3801

2063 Pleasant Hill Rd. Duluth, GA 30096-3801

STANDARD CONFIGURATION

18'-10" STUCK LENGTH

18'-10" USE FULL LENGTH - NO CUT

UNISTRUT CUT PLAN 18 TILES
6 REQUIRED

18'-10" STUCK LENGTH

16'-8 13/16" CUT LENGTH

UNISTRUT CUT PLAN 16 TILES
6 REQUIRED

2'-13 1/16" DROP

1 1/8" x 2-3/16" U-STRUT
12ga GALVANIZED
UNISTRUT P-5500 DR EQUI
NOT TO SCALE

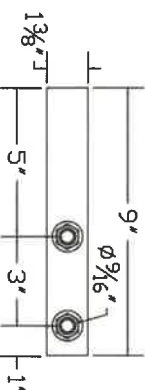
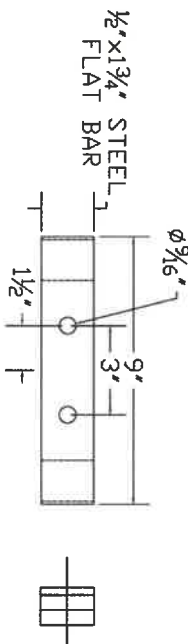
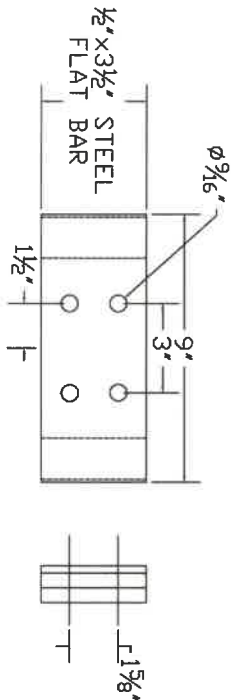
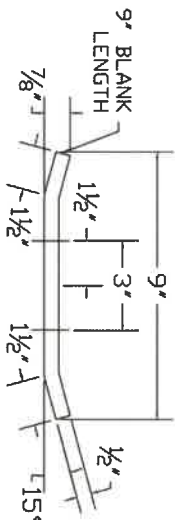
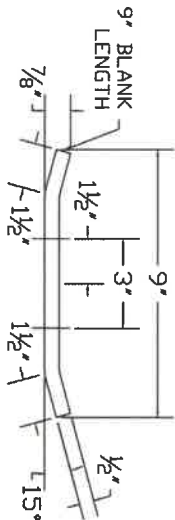
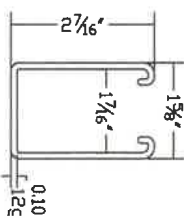

FORMED I-BEAM CLAMP

DOUBLE WIDTH

3 1/2" x 1/2" FLAT BAR

PAINT GRAY

SCALE 4X

QTY = 20 REQ'D

FORMED I-BEAM CLAMP

SINGLE WIDTH

1 3/4" x 1/2" FLAT BAR

PAINT GRAY

SCALE 4X

QTY = 20 REQ'D

UNISTRUT CLAMP BOLT PLATE

1.375" x 9" FLAT

12ga GALVANNEAL

SCALE 4X

QTY = 60 REQ'D

NOTE:
GRAY UPRIGHT BEAM CLAMP - 1/2" THICK

PART NUMBER			
FTX-A DBB			
REVISIONS			
REV	DESCRIPTION	DATE	APPD
A	MISC. UPDATES AND CORRECTIONS	6-29-21	RFV
REV	DESCRIPTION	DATE	APPD
1	REVISIONS	08-23	RFV
2	REVISIONS	08-23	RFV
3	REVISIONS	08-23	RFV
4	REVISIONS	08-23	RFV
5	REVISIONS	08-23	RFV
6	REVISIONS	08-23	RFV
7	REVISIONS	08-23	RFV
8	REVISIONS	08-23	RFV
9	REVISIONS	08-23	RFV
10	REVISIONS	08-23	RFV
11	REVISIONS	08-23	RFV
12	REVISIONS	08-23	RFV
13	REVISIONS	08-23	RFV
14	REVISIONS	08-23	RFV
15	REVISIONS	08-23	RFV
16	REVISIONS	08-23	RFV
17	REVISIONS	08-23	RFV
18	REVISIONS	08-23	RFV
19	REVISIONS	08-23	RFV
20	REVISIONS	08-23	RFV
21	REVISIONS	08-23	RFV
22	REVISIONS	08-23	RFV
23	REVISIONS	08-23	RFV
24	REVISIONS	08-23	RFV
25	REVISIONS	08-23	RFV
26	REVISIONS	08-23	RFV
27	REVISIONS	08-23	RFV
28	REVISIONS	08-23	RFV
29	REVISIONS	08-23	RFV
30	REVISIONS	08-23	RFV
31	REVISIONS	08-23	RFV
32	REVISIONS	08-23	RFV
33	REVISIONS	08-23	RFV
34	REVISIONS	08-23	RFV
35	REVISIONS	08-23	RFV
36	REVISIONS	08-23	RFV
37	REVISIONS	08-23	RFV
38	REVISIONS	08-23	RFV
39	REVISIONS	08-23	RFV
40	REVISIONS	08-23	RFV
41	REVISIONS	08-23	RFV
42	REVISIONS	08-23	RFV
43	REVISIONS	08-23	RFV
44	REVISIONS	08-23	RFV
45	REVISIONS	08-23	RFV
46	REVISIONS	08-23	RFV
47	REVISIONS	08-23	RFV
48	REVISIONS	08-23	RFV
49	REVISIONS	08-23	RFV
50	REVISIONS	08-23	RFV
51	REVISIONS	08-23	RFV
52	REVISIONS	08-23	RFV
53	REVISIONS	08-23	RFV
54	REVISIONS	08-23	RFV
55	REVISIONS	08-23	RFV
56	REVISIONS	08-23	RFV
57	REVISIONS	08-23	RFV
58	REVISIONS	08-23	RFV
59	REVISIONS	08-23	RFV
60	REVISIONS	08-23	RFV
61	REVISIONS	08-23	RFV
62	REVISIONS	08-23	RFV
63	REVISIONS	08-23	RFV
64	REVISIONS	08-23	RFV
65	REVISIONS	08-23	RFV
66	REVISIONS	08-23	RFV
67	REVISIONS	08-23	RFV
68	REVISIONS	08-23	RFV
69	REVISIONS	08-23	RFV
70	REVISIONS	08-23	RFV
71	REVISIONS	08-23	RFV
72	REVISIONS	08-23	RFV
73	REVISIONS	08-23	RFV
74	REVISIONS	08-23	RFV
75	REVISIONS	08-23	RFV
76	REVISIONS	08-23	RFV
77	REVISIONS	08-23	RFV
78	REVISIONS	08-23	RFV
79	REVISIONS	08-23	RFV
80	REVISIONS	08-23	RFV
81	REVISIONS	08-23	RFV
82	REVISIONS	08-23	RFV
83	REVISIONS	08-23	RFV
84	REVISIONS	08-23	RFV
85	REVISIONS	08-23	RFV
86	REVISIONS	08-23	RFV
87	REVISIONS	08-23	RFV
88	REVISIONS	08-23	RFV
89	REVISIONS	08-23	RFV
90	REVISIONS	08-23	RFV
91	REVISIONS	08-23	RFV
92	REVISIONS	08-23	RFV
93	REVISIONS	08-23	RFV
94	REVISIONS	08-23	RFV
95	REVISIONS	08-23	RFV
96	REVISIONS	08-23	RFV
97	REVISIONS	08-23	RFV
98	REVISIONS	08-23	RFV
99	REVISIONS	08-23	RFV
100	REVISIONS	08-23	RFV
101	REVISIONS	08-23	RFV
102	REVISIONS	08-23	RFV
103	REVISIONS	08-23	RFV
104	REVISIONS	08-23	RFV
105	REVISIONS	08-23	RFV
106	REVISIONS	08-23	RFV
107	REVISIONS	08-23	RFV
108	REVISIONS	08-23	RFV
109	REVISIONS	08-23	RFV
110	REVISIONS	08-23	RFV
111	REVISIONS	08-23	RFV
112	REVISIONS	08-23	RFV
113	REVISIONS	08-23	RFV
114	REVISIONS	08-23	RFV
115	REVISIONS	08-23	RFV
116	REVISIONS	08-23	RFV
117	REVISIONS	08-23	RFV
118	REVISIONS	08-23	RFV
119	REVISIONS	08-23	RFV
120	REVISIONS	08-23	RFV
121	REVISIONS	08-23	RFV
122	REVISIONS	08-23	RFV
123	REVISIONS	08-23	RFV
124	REVISIONS	08-23	RFV
125	REVISIONS	08-23	RFV
126	REVISIONS	08-23	RFV
127	REVISIONS	08-23	RFV
128	REVISIONS	08-23	RFV
129	REVISIONS	08-23	RFV
130	REVISIONS	08-23	RFV
131	REVISIONS	08-23	RFV
132	REVISIONS	08-23	RFV
133	REVISIONS	08-23	RFV
134	REVISIONS	08-23	RFV
135	REVISIONS	08-23	RFV
136	REVISIONS	08-23	RFV
137	REVISIONS	08-23	RFV
138	REVISIONS	08-23	RFV
139	REVISIONS	08-23	RFV
140	REVISIONS	08-23	RFV
141	REVISIONS	08-23	RFV
142	REVISIONS	08-23	RFV
143	REVISIONS	08-23	RFV
144	REVISIONS	08-23	RFV
145	REVISIONS	08-23	RFV
146	REVISIONS	08-23	RFV
147	REVISIONS	08-23	RFV
148	REVISIONS	08-23	RFV
149	REVISIONS	08-23	RFV
150	REVISIONS	08-23	RFV
151	REVISIONS	08-23	RFV
152	REVISIONS	08-23	RFV
153	REVISIONS	08-23	RFV
154	REVISIONS	08-23	RFV
155	REVISIONS	08-23	RFV
156	REVISIONS	08-23	RFV
157	REVISIONS	08-23	RFV
158	REVISIONS	08-23	RFV
159	REVISIONS	08-23	RFV
160	REVISIONS	08-23	RFV
161	REVISIONS	08-23	RFV
162	REVISIONS	08-23	RFV
163	REVISIONS	08-23	RFV
164	REVISIONS	08-23	RFV
165	REVISIONS	08-23	RFV
166	REVISIONS	08-23	RFV
167	REVISIONS	08-23	RFV
168	REVISIONS	08-23	RFV
169	REVISIONS	08-23	RFV
170	REVISIONS	08-23	RFV
171	REVISIONS	08-23	RFV
172	REVISIONS	08-23	RFV
173	REVISIONS	08-23	RFV
174	REVISIONS	08-23	RFV
175	REVISIONS	08-23	RFV
176	REVISIONS	08-23	RFV
177	REVISIONS	08-23	RFV
178	REVISIONS	08-23	RFV
179	REVISIONS	08-23	RFV
180	REVISIONS	08-23	RFV
181	REVISIONS	08-23	RFV
182	REVISIONS	08-23	RFV
183	REVISIONS	08-23	RFV
184	REVISIONS	08-23	RFV
185	REVISIONS	08-23	RFV
186	REVISIONS	08-23	RFV
187	REVISIONS	08-23	RFV
188	REVISIONS	08-23	RFV
189	REVISIONS	08-23	RFV
190	REVISIONS	08-23	RFV
191	REVISIONS	08-23	RFV
192	REVISIONS	08-23	RFV
193	REVISIONS	08-23	RFV
194	REVISIONS	08-23	RFV
195	REVISIONS	08-23	RFV
196	REVISIONS	08-23	RFV
197	REVISIONS	08-23	RFV
198	REVISIONS	08-23	RFV
199	REVISIONS	08-23	RFV
200	REVISIONS	08-23	RFV
201	REVISIONS	08-23	RFV
202	REVISIONS	08-23	RFV
203	REVISIONS	08-23	RFV
204	REVISIONS	08-23	RFV
205	REVISIONS	08-23	RFV
206	REVISIONS	08-23	RFV
207	REVISIONS	08-23	RFV
208	REVISIONS	08-23	RFV
209	REVISIONS	08-23	RFV
210	REVISIONS	08-23	RFV
211	REVISIONS	08-23	RFV
212	REVISIONS	08-23	RFV
213	REVISIONS	08-23	RFV
214	REVISIONS	08-23	RFV
215	REVISIONS	08-23	RFV
216	REVISIONS	08-23	RFV
217	REVISIONS	08-23	RFV
218	REVISIONS	08-23	RFV
219	REVISIONS	08-23	RFV
220	REVISIONS	08-23	RFV
221	REVISIONS	08-23	RFV
222	REVISIONS	08-23	RFV
223	REVISIONS	08-23	RFV
224	REVISIONS	08-23	RFV
225	REVISIONS	08-23	RFV
226	REVISIONS	08-23	RFV
227	REVISIONS	08-23	RFV
228	REVISIONS	08-23	RFV
229	REVISIONS	08-23	RFV
230	REVISIONS	08-23	RFV
231	REVISIONS	08-23	RFV
232	REVISIONS	08-23	RFV
233	REVISIONS	08-23	RFV
234	REVISIONS	08-23	RFV
235	REVISIONS	08-23	RFV
236	REVISIONS	08-23	RFV
237	REVISIONS	08-23	RFV
238	REVISIONS	08-23	RFV
239	REVISIONS	08-23	RFV
240	REVISIONS	08-23	RFV
241	REVISIONS	08-23	RFV
242	REVISIONS	08-23	RFV
243	REVISIONS	08-23	RFV
244	REVISIONS	08-23	RFV
245	REVISIONS	08-23	RFV
246	REVISIONS	08-23	RFV
247	REVISIONS	08-23	RFV
248	REVISIONS	08-23	RFV
249	REVISIONS	08-23	RFV
250	REVISIONS	08-23	RFV
251	REVISIONS	08-23	RFV
252	REVISIONS	08-23	RFV
253	REVISIONS	08-23	RFV
254	REVISIONS	08-23	RFV
255	REVISIONS	08-23	RFV
256	REVISIONS	08-23	RFV
257	REVISIONS	08-23	RFV
258	REVISIONS	08-23	RFV
259	REVISIONS	08-23	RFV
260	REVISIONS	08-23	RFV
261	REVISIONS	08-23	RFV
262	REVISIONS	08-23	RFV
263	REVISIONS	08-23	RFV
264	REVISIONS	08-23	RFV
265	REVISIONS	08-23	RFV
266	REVISIONS	08-23	RFV

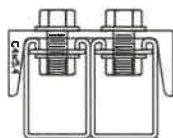
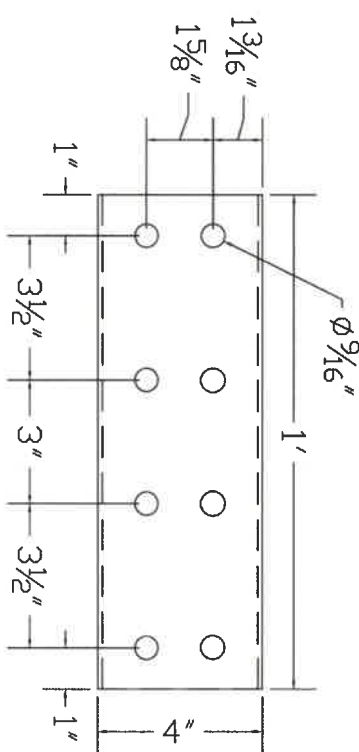
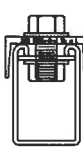
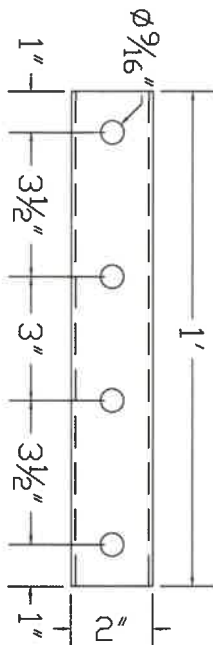

TOP/BOT UNISTRUT SPLICE
 2"x1"x3/16" BAR CHANNEL
 SCALE 4X
 QTY = 2 REQ'D

MID DBL UNISTRUT SPLICE
 C4 x 5.4 CHANNEL
 SCALE 4X
 QTY = 2 REQ'D

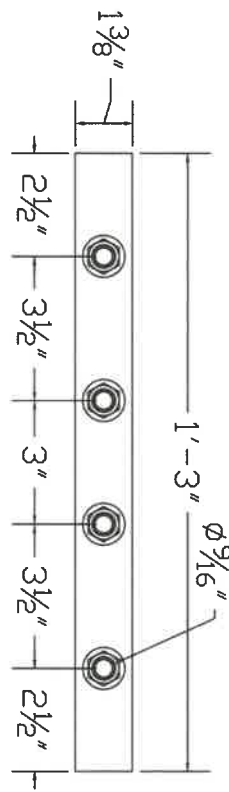

UNISTRUT SPLICE BOLT PLATE
 1.375" x 15" FLAT
 12ga GALVANNEAL
 SCALE 4X
 QTY = 6 REQ'D

PART NUMBER		FTX-A DBB	
DESCRIPTION		U-STRUT SPLICES FABRICATION	
REV	DATE	APPD	DATE
1	08-23	08-23	08-23
REVISIONS		APPROVALS	
THIS MATERIAL IS THE EXCLUSIVE CONFIDENTIAL PROPERTY OF FORMETCO, INC.		2963 Pleasant Hill Rd. Duluth, GA 30096-38	
ALL RIGHTS, INCLUDING COPYRIGHT AND PATENT RIGHTS, ARE RESERVED BY FORMETCO, INC.		FORMETCO	

STANDARD CONFIGURATION

(27) F-TILE CABINETS

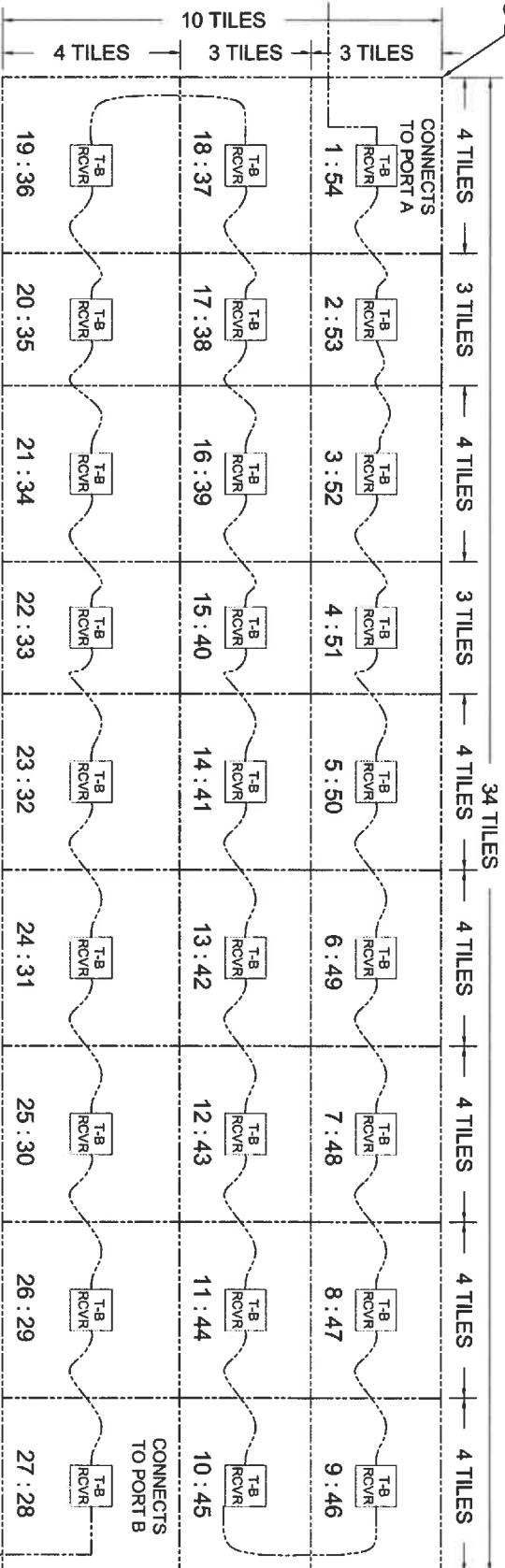

NOTE: CABINETS SHOWN AS VIEWED FROM THE REAR

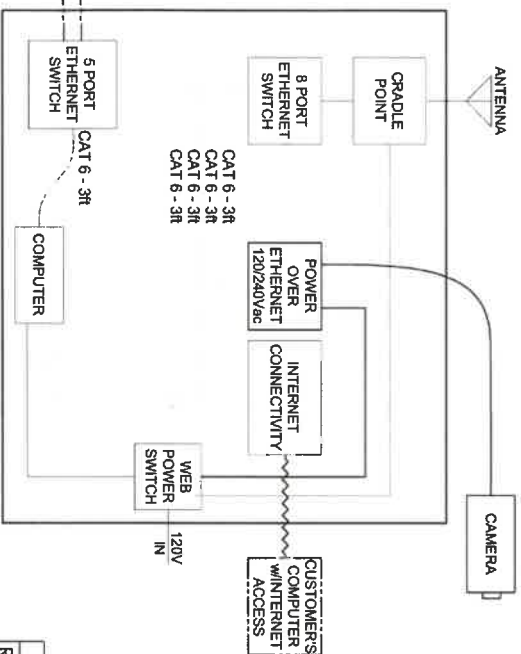

REV		DESCRIPTION		DATE		APPD	
REV		DESCRIPTION		DATE		APPD	
REV		DESCRIPTION		DATE		APPD	

THIS MATERIAL IS THE EXCLUSIVE CONFIDENTIAL PROPERTY OF FORMETCO, INC.
ALL RIGHTS, INCLUDING COPYRIGHT AND PATENT RIGHTS, ARE RESERVED BY FORMETCO, INC.

2963 Pleasant Hill Rd. Duluth, GA 30096-381

FORMETCO

The diagram illustrates a system layout with two main sections of tiles. The left section is a 3x18 grid, and the right section is a 3x16 grid. The left grid is labeled with '4 TILES', '3 TILES', and '18 TILES'. The right grid is labeled with '4 TILES', '4 TILES', and '16 TILES'. A 'CABLE BY MFGR' is shown at the top left, and a 'DIMMER' is shown at the bottom left. A 'POWER IN 240V/20a' is shown at the bottom right.

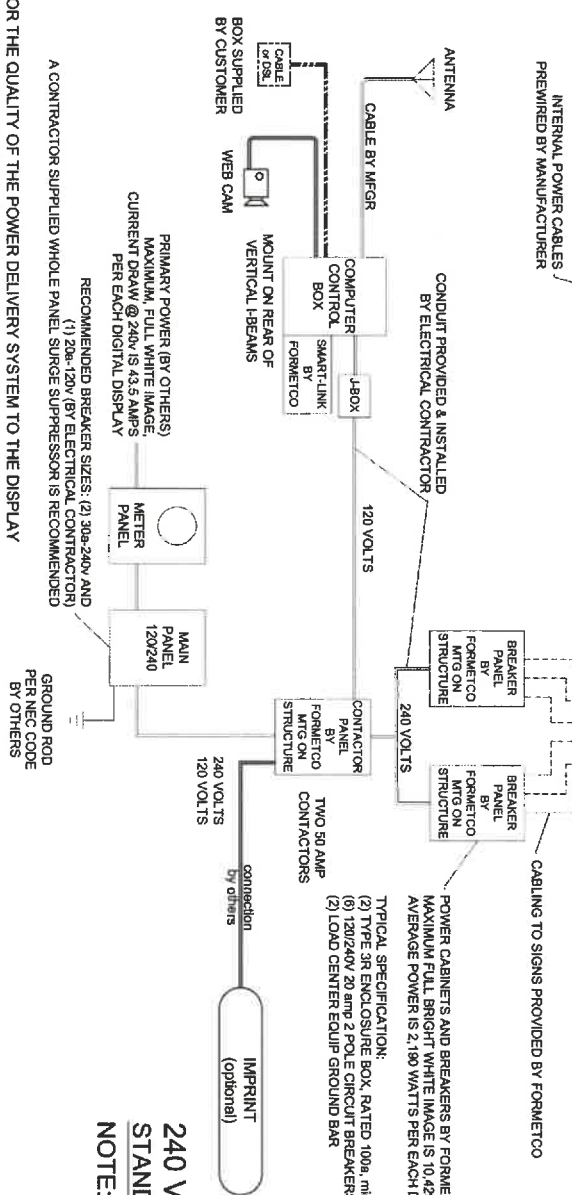
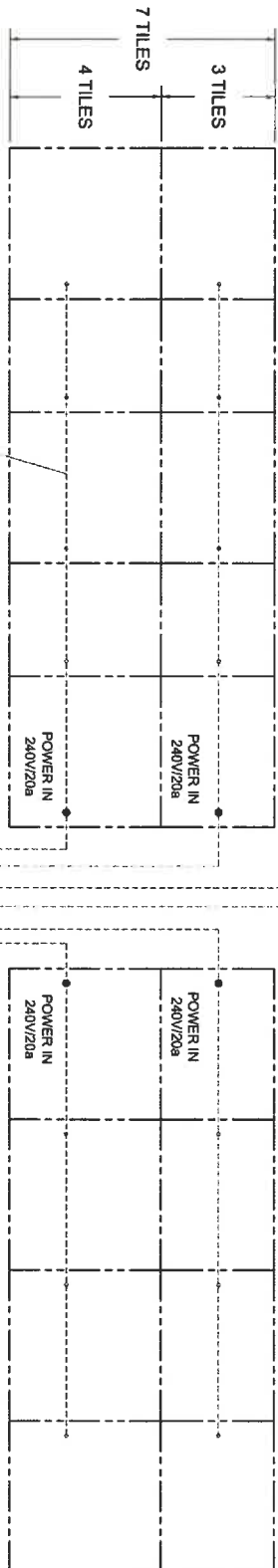

CRANECO IS NOT RESPONSIBLE FOR THE QUALITY OF THE POWER DELIVERY SYSTEM TO THE DISPLAY
 1. DISPLAYS MUST BE GROUNDED PER ARTICLE 250 AND 600 OF THE NEC
 1. ELECTRICAL WORK DONE MUST MEET OR EXCEED ANY LOCAL AND NATIONAL ELECTRICAL CODES
 1. THE OVER CURRENT PROTECTION DEVICE MUST BE MATCHED TO THE FAULT CURRENT THAT IS AVAILABLE
 1. THE POWER DELIVERY CIRCUIT.
 1. USE TO THE INRUSH CURRENT CREATED BY THE DISPLAY ON STARTUP THE OVER CURRENT PROTECTION
 1. DEVICE(S) MAY HAVE TO BE OVERSIZED
 1. PRIMARY FEEDER CIRCUITS TO THE DISPLAY MUST BE UL 489 LISTED

PART NUMBER FIX-A-DBR					
A	MOVE SMARTLINK TO CONTROL BOX AND REVISE NOTES	04-13-23	CJD		
REV	DESCRIPTION	DATE	APPD		
REVISIONS					
THIS MATERIAL IS THE EXCLUSIVE CONFIDENTIAL PROPERTY OF FORMETCO, INC. ALL RIGHTS, INCLUDING COPYRIGHT AND PATENT RIGHTS, ARE RESERVED BY FORMETCO, INC.					
 FORMETCO 2963 Pleasant Hill Rd., Duluth, GA 30096-2588 240V - 1Ø ELECTRICAL RISER Dwg No. 240V-1Ø-RISER-01					

Updated 4-4-2023

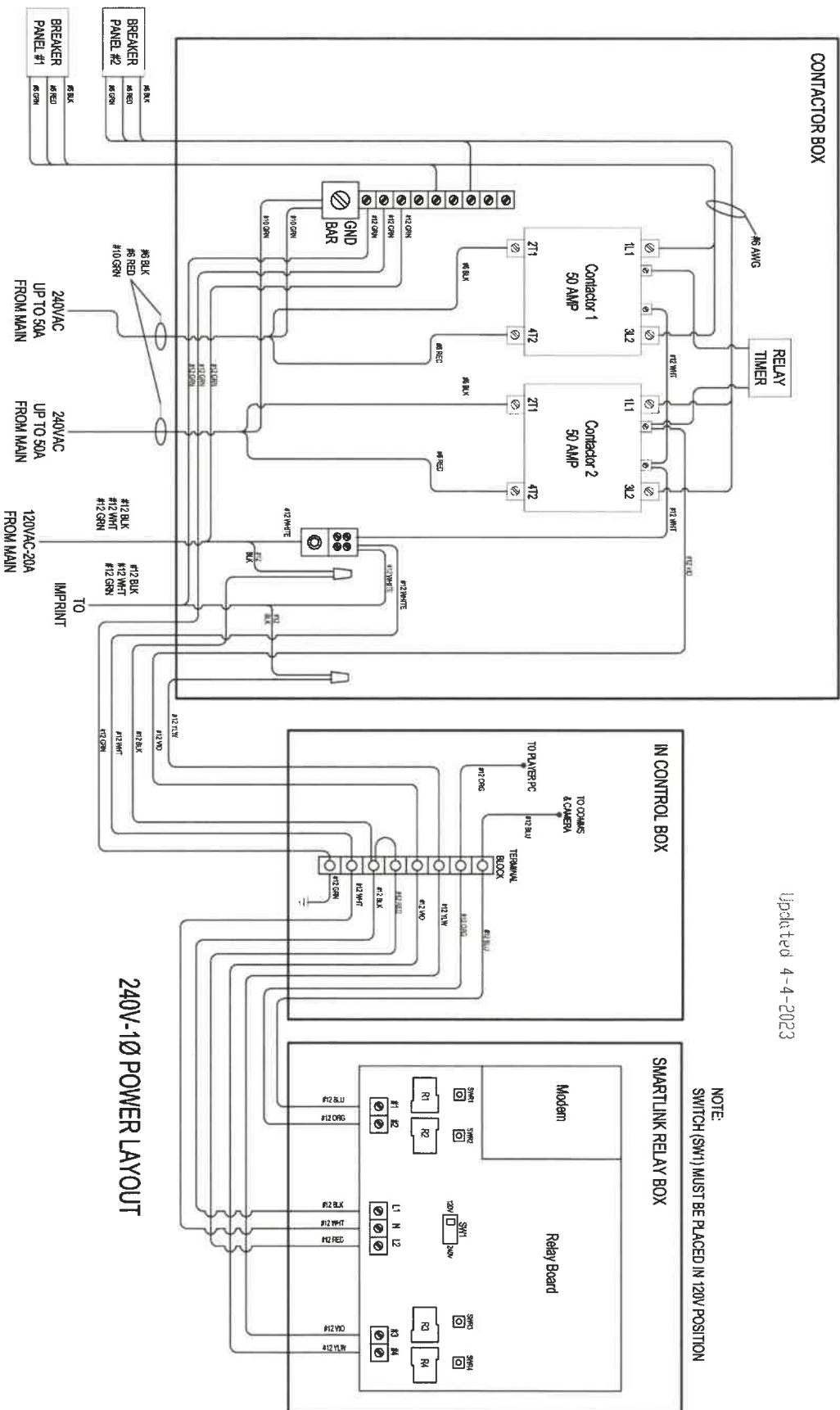

#6 WIRING TYPICAL FOR UP TO 50 AMPS.
WIRE SIZE MAY BE ADJUSTED AS DETERMINED
BY SUPPLY BREAKER SIZE.

FORMETCO IS NOT RESPONSIBLE FOR THE QUALITY OF THE POWER DELIVERY SYSTEM TO THE DISPLAY
ALL DISPLAYS MUST BE GROUNDED PER ARTICLE 250 AND 800 OF THE NEC
ALL ELECTRICAL WORK DONE MUST MEET OR EXCEED ANY LOCAL AND NATIONAL ELECTRICAL CODES
THE OVER CURRENT PROTECTION DEVICE MUST BE MATCHED TO THE FAULT CURRENT THAT IS AVAILABLE
THE POWER DELIVERY CIRCUIT
DUE TO THE INRUSH CURRENT CREATED BY THE DISPLAY ON STARTUP THE OVER CURRENT PROTECTION
DEVICE(S) MAY HAVE TO BE OVERSIZED
ALL PRIMARY FEEDER CIRCUITS TO THE DISPLAY MUST BE UL 489 LISTED
ALL SPECIFICATIONS ARE SUBJECT TO CHANGE DUE TO FORMETCO'S CONTINUING PRODUCT IMPROVEMENT

REVISIONS			
REV	DESCRIPTION	DATE	APPD
A	CHANGED CONTACTOR WIRING	04-13-23	CJD
THIS MATERIAL IS THE EXCLUSIVE CONFIDENTIAL PROPERTY OF FORMETCO, INC.			
ALL RIGHTS, INCLUDING COPYRIGHT AND PATENT RIGHTS, ARE RESERVED BY FORMETCO, INC.			
PART NUMBER			
APPROVALS			
DATE			
8-22-23			
2963 Pleasant Hill Rd. Duluth, GA 30096-381			
DUAL 50 AMP CONTACTORS			
SMART LINK WIRING DIAGRAM			
DWG N 0000			

FORMETCO



City of Smyrna

3180 Atlanta Road

Smyrna, Georgia 30080

(678) 631-5387 / Community Development

May 6, 2024

Michael B Fitzgerald, Manager Atlantic Billboards, LLC
3162 Johnson Ferry Rd #260-441
Marietta, GA 30062

RE: Sign Permit: SIGN-24-74
0 Atlanta Rd
17044400280

The application for permit SIGN-24-74 is denied based on the non-compliance with the regulations established in Chapter 82, Section 15 of the Smyrna Code of Ordinances. The proposed sign exceeds both the maximum area (32 square feet) and maximum height (8 feet) specified by the ordinance, is not a ground based monument sign as required by the ordinance and is a pole sign as prohibited by the ordinance.

Due to the non-compliance with these standards established in Chapter 82 of the Smyrna Code of Ordinances, the sign permit is denied.

Joey Staubes
Planner II
Community Development

Mayor – Derek Norton

City Council Ward 1 – Glen Pickens / Ward 2 – Latonia P. Hines / Ward 3 – Travis Lindley / Ward 4 – Charles Welch
Ward 5 – Susan Wilkinson / Ward 6 – Tim Gould / Ward 7 – Ricky Oglesby, Jr.

City Administrator – Joe Bennett / City Clerk – Heather Corn / City Attorney – Scott Cochran
Municipal Court Judge – Phyllis Gingrey Collins

Sent 2/13/24



PROPERTY OWNER AUTHORIZATION

City of Smyrna Community Development Department, 3180 Atlanta Rd, Smyrna, GA 30080
Office Phone 678-631-5387 / Fax 770-431-2808

I, Thornton W. Morris Jr, swear that I am the Property Owner of the property

located at: NW Corner Atlanta Rd & Pat Mell Rd (Tax Parcel 17044400280)

as shown in the records of Cobb County, Georgia, which is the subject matter of the attached application.

I authorize the person named below to act as the applicant in pursuit of this application.

Name of Applicant (print clearly): Atlantic Billboards, LLC, Mike Fitzgerald, Manager

Address: 3162 Johnson Ferry Rd, #260-441, Marietta, GA 30062

Telephone: 678-571-8889 Email: Mike@AtlanticBillboards.com

I have read, understood, and answered the aforementioned items to the best of my knowledge. If I am found to have misrepresented myself on this affidavit or the attached application, I am aware I may be in violation of the City Code and run the risk of being issued a citation for violation of the City of Smyrna Code of Ordinances.

(Must be signed by the property owner. If the landowner is a corporation, the form must be signed by an officer of the corporation.)

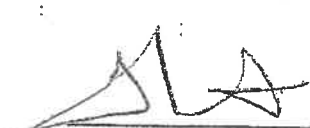
Signature of Property Owner
President

11 Village Pkwy Bldg 2 Marietta Ga 30067
Address

Partlone Capital II LLC
Name of Property Owner (print clearly)

11 Village Pkwy Bldg 2 Marietta Ga 30067
City, State, Zip



CERTIFICATE OF LIABILITY INSURANCE

DATE (MM/DD/YYYY)

02/13/2024

THIS CERTIFICATE IS ISSUED AS A MATTER OF INFORMATION ONLY AND CONFERS NO RIGHTS UPON THE CERTIFICATE HOLDER. THIS CERTIFICATE DOES NOT AFFIRMATIVELY OR NEGATIVELY AMEND, EXTEND OR ALTER THE COVERAGE AFFORDED BY THE POLICIES BELOW. THIS CERTIFICATE OF INSURANCE DOES NOT CONSTITUTE A CONTRACT BETWEEN THE ISSUING INSURER(S), AUTHORIZED REPRESENTATIVE OR PRODUCER, AND THE CERTIFICATE HOLDER.

IMPORTANT: If the certificate holder is an ADDITIONAL INSURED, the policy(ies) must have ADDITIONAL INSURED provisions or be endorsed. If SUBROGATION IS WAIVED, subject to the terms and conditions of the policy, certain policies may require an endorsement. A statement on this certificate does not confer rights to the certificate holder in lieu of such endorsement(s).

PRODUCER STARR-MATHEWS AGENCY P. O. Box 1990 Cartersville GA 30120	CONTACT NAME: Trung Ly PHONE (A/C, No, Ext): (770) 386-0466 E-MAIL ADDRESS: tly@starrmathews.com FAX (A/C, No): (770) 386-3164																					
INSURED Bowen Auger Service, Inc. P O Box 178 Adairsville GA 30103-0178	<table><tr><th colspan="2">INSURER(S) AFFORDING COVERAGE</th><th>NAIC #</th></tr><tr><td>INSURER A:</td><td>Westfield Insurance Co</td><td>24112</td></tr><tr><td>INSURER B:</td><td>Builders Insurance</td><td>10704</td></tr><tr><td>INSURER C:</td><td></td><td></td></tr><tr><td>INSURER D:</td><td></td><td></td></tr><tr><td>INSURER E:</td><td></td><td></td></tr><tr><td>INSURER F:</td><td></td><td></td></tr></table>	INSURER(S) AFFORDING COVERAGE		NAIC #	INSURER A:	Westfield Insurance Co	24112	INSURER B:	Builders Insurance	10704	INSURER C:			INSURER D:			INSURER E:			INSURER F:		
INSURER(S) AFFORDING COVERAGE		NAIC #																				
INSURER A:	Westfield Insurance Co	24112																				
INSURER B:	Builders Insurance	10704																				
INSURER C:																						
INSURER D:																						
INSURER E:																						
INSURER F:																						

COVERAGES**CERTIFICATE NUMBER:** 2023-24**REVISION NUMBER:**

THIS IS TO CERTIFY THAT THE POLICIES OF INSURANCE LISTED BELOW HAVE BEEN ISSUED TO THE INSURED NAMED ABOVE FOR THE POLICY PERIOD INDICATED. NOTWITHSTANDING ANY REQUIREMENT, TERM OR CONDITION OF ANY CONTRACT OR OTHER DOCUMENT WITH RESPECT TO WHICH THIS CERTIFICATE MAY BE ISSUED OR MAY PERTAIN, THE INSURANCE AFFORDED BY THE POLICIES DESCRIBED HEREIN IS SUBJECT TO ALL THE TERMS, EXCLUSIONS AND CONDITIONS OF SUCH POLICIES. LIMITS SHOWN MAY HAVE BEEN REDUCED BY PAID CLAIMS.

INSR LTR	TYPE OF INSURANCE	ADDL SUBR INSD WVD	POLICY NUMBER	POLICY EFF (MM/DD/YYYY)	POLICY EXP (MM/DD/YYYY)	LIMITS														
A	<input checked="" type="checkbox"/> COMMERCIAL GENERAL LIABILITY <input type="checkbox"/> CLAIMS-MADE <input checked="" type="checkbox"/> OCCUR GEN'L AGGREGATE LIMIT APPLIES PER: <input type="checkbox"/> POLICY <input checked="" type="checkbox"/> PROJECT <input checked="" type="checkbox"/> LOC OTHER:		3783172	11/04/2023	11/04/2024	<table><tr><td>EACH OCCURRENCE</td><td>\$ 1,000,000</td></tr><tr><td>DAMAGE TO RENTED PREMISES (Ea occurrence)</td><td>\$ 1,000,000</td></tr><tr><td>MED EXP (Any one person)</td><td>\$ 10,000</td></tr><tr><td>PERSONAL & ADV INJURY</td><td>\$ 1,000,000</td></tr><tr><td>GENERAL AGGREGATE</td><td>\$ 2,000,000</td></tr><tr><td>PRODUCTS - COMP/OP AGG</td><td>\$ 2,000,000</td></tr><tr><td>Property damage-single</td><td>\$</td></tr></table>	EACH OCCURRENCE	\$ 1,000,000	DAMAGE TO RENTED PREMISES (Ea occurrence)	\$ 1,000,000	MED EXP (Any one person)	\$ 10,000	PERSONAL & ADV INJURY	\$ 1,000,000	GENERAL AGGREGATE	\$ 2,000,000	PRODUCTS - COMP/OP AGG	\$ 2,000,000	Property damage-single	\$
EACH OCCURRENCE	\$ 1,000,000																			
DAMAGE TO RENTED PREMISES (Ea occurrence)	\$ 1,000,000																			
MED EXP (Any one person)	\$ 10,000																			
PERSONAL & ADV INJURY	\$ 1,000,000																			
GENERAL AGGREGATE	\$ 2,000,000																			
PRODUCTS - COMP/OP AGG	\$ 2,000,000																			
Property damage-single	\$																			
A	<input checked="" type="checkbox"/> AUTOMOBILE LIABILITY <input checked="" type="checkbox"/> ANY AUTO OWNED AUTOS ONLY HIRED AUTOS ONLY <input type="checkbox"/> SCHEDULED AUTOS <input checked="" type="checkbox"/> NON-OWNED AUTOS ONLY		3783172	11/04/2023	11/04/2024	<table><tr><td>COMBINED SINGLE LIMIT (Ea accident)</td><td>\$ 1,000,000</td></tr><tr><td>BODILY INJURY (Per person)</td><td>\$</td></tr><tr><td>BODILY INJURY (Per accident)</td><td>\$</td></tr><tr><td>PROPERTY DAMAGE (Per accident)</td><td>\$</td></tr><tr><td>Medical payments</td><td>\$ 10,000</td></tr></table>	COMBINED SINGLE LIMIT (Ea accident)	\$ 1,000,000	BODILY INJURY (Per person)	\$	BODILY INJURY (Per accident)	\$	PROPERTY DAMAGE (Per accident)	\$	Medical payments	\$ 10,000				
COMBINED SINGLE LIMIT (Ea accident)	\$ 1,000,000																			
BODILY INJURY (Per person)	\$																			
BODILY INJURY (Per accident)	\$																			
PROPERTY DAMAGE (Per accident)	\$																			
Medical payments	\$ 10,000																			
A	<input checked="" type="checkbox"/> UMBRELLA LIAB <input checked="" type="checkbox"/> OCCUR <input type="checkbox"/> EXCESS LIAB <input type="checkbox"/> CLAIMS-MADE DED RETENTION \$		3783172	11/04/2023	11/04/2024	<table><tr><td>EACH OCCURRENCE</td><td>\$ 5,000,000</td></tr><tr><td>AGGREGATE</td><td>\$ 5,000,000</td></tr><tr><td></td><td>\$</td></tr></table>	EACH OCCURRENCE	\$ 5,000,000	AGGREGATE	\$ 5,000,000		\$								
EACH OCCURRENCE	\$ 5,000,000																			
AGGREGATE	\$ 5,000,000																			
	\$																			
B	<input checked="" type="checkbox"/> WORKERS COMPENSATION AND EMPLOYERS' LIABILITY ANY PROPRIETOR/PARTNER/EXECUTIVE OFFICER/MEMBER EXCLUDED? (Mandatory in NH) If yes, describe under DESCRIPTION OF OPERATIONS below Y/N <input checked="" type="checkbox"/> Y	N/A	WCV002484820	07/14/2023	07/14/2024	<table><tr><td><input checked="" type="checkbox"/> PER STATUTE <input type="checkbox"/> OTH-ER</td><td></td></tr><tr><td>E.L. EACH ACCIDENT</td><td>\$ 1,000,000</td></tr><tr><td>E.L. DISEASE - EA EMPLOYEE</td><td>\$ 1,000,000</td></tr><tr><td>E.L. DISEASE - POLICY LIMIT</td><td>\$ 1,000,000</td></tr></table>	<input checked="" type="checkbox"/> PER STATUTE <input type="checkbox"/> OTH-ER		E.L. EACH ACCIDENT	\$ 1,000,000	E.L. DISEASE - EA EMPLOYEE	\$ 1,000,000	E.L. DISEASE - POLICY LIMIT	\$ 1,000,000						
<input checked="" type="checkbox"/> PER STATUTE <input type="checkbox"/> OTH-ER																				
E.L. EACH ACCIDENT	\$ 1,000,000																			
E.L. DISEASE - EA EMPLOYEE	\$ 1,000,000																			
E.L. DISEASE - POLICY LIMIT	\$ 1,000,000																			

DESCRIPTION OF OPERATIONS / LOCATIONS / VEHICLES (ACORD 101, Additional Remarks Schedule, may be attached if more space is required)

(GL) CG 7137 12 17 - Signature Series Commercial General Liability Contractors Endorsement.
(GL) CG 25 04 A 05 09 - Designated Location(s) General Aggregate Limit.
(GL) CG 25 03 05 09 - Designated Construction Project(s) General Aggregate Limit.
(GL) CG 20 37 04 13 - Additional Insured - Owners, Lessees or Contractors - Completed Operations.
(GL) CG 20 10 04 13 - Additional Insured - Owners, Lessees or Contractors - Scheduled Person or Organization.
(AUTO) CA 70 77 10 13 - Signature Series Business Auto Endorsement.
(AUTO) CA 70 75 10 13 - Primary and Noncontributory Insurance.

CERTIFICATE HOLDER**CANCELLATION**

Atlantic Billboards, LLC
3162 Johnson Ferry Rd
Ste 260-441
Marietta GA 30062

SHOULD ANY OF THE ABOVE DESCRIBED POLICIES BE CANCELLED BEFORE THE EXPIRATION DATE THEREOF, NOTICE WILL BE DELIVERED IN ACCORDANCE WITH THE POLICY PROVISIONS.

AUTHORIZED REPRESENTATIVE

© 1988-2015 ACORD CORPORATION. All rights reserved.

**BARTOW COUNTY, GEORGIA
HOME BASED**

VALID 01/01/2024 THROUGH 01/01/2025

BUSINESS NAME/ADDRESS	OWNER NAME	BUSINESS DESCRIPTION
BOWEN AUGER SERVICES, INC. 326 PLEASANT VALLEY RD ADAIRSVILLE, GA 30103	BOWEN JEROME D	

LICENSE FEES PAID	LICENSE OFFICIAL	LICENSE NUMBER
180.00		HO14

THIS LICENSE IS GRANTED BY THE BARTOW COUNTY COMMUNITY DEVELOPMENT DEPARTMENT AND ACCEPTED BY LICENSEE SUBJECT TO ALL OF THE TERMS AND CONDITIONS OF THE ORDINANCES GOVERNING THE ISSUANCE AND RETENTION OF THE SAME.

* Please note, license fee amount does not include an administrative fee of \$30

DISPLAY IN A CONSPICUOUS LOCATION. MAY BE REVOKED FOR CAUSE.

NOTE: 18" UPPER & LOWER INSIDE CATWALKS NOT SHOWN FOR CLARITY

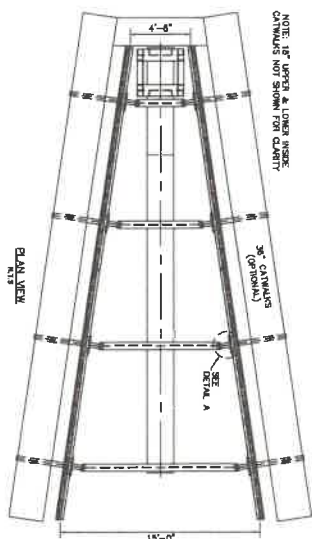

PLAN VIEW

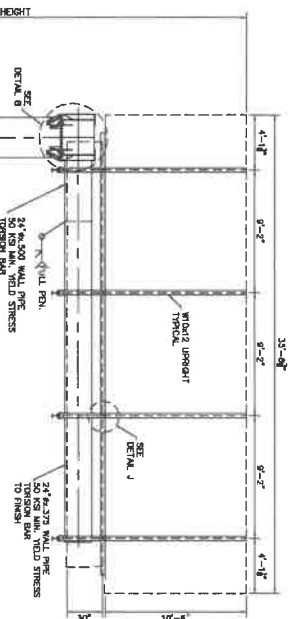
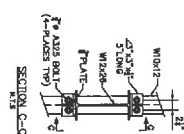
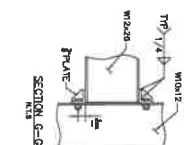
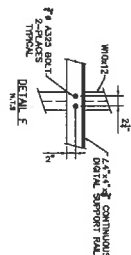
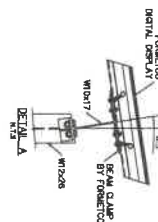

FIG

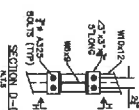
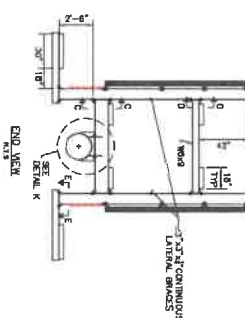

15

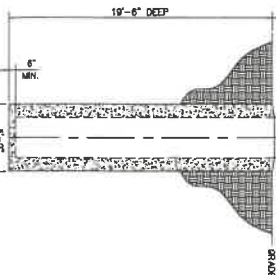
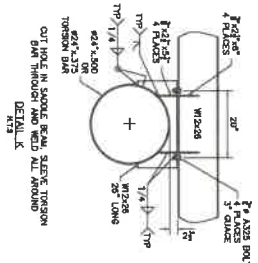
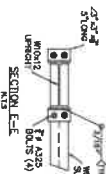
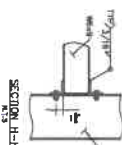
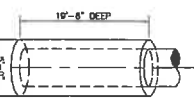
ELEVATION VIEW
N 7 8

AUGER FOOTING DETAIL

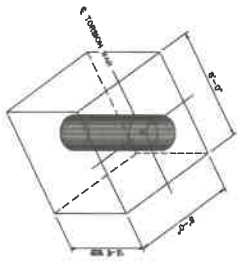

CUBE FOOTING DETAIL
N 7 8

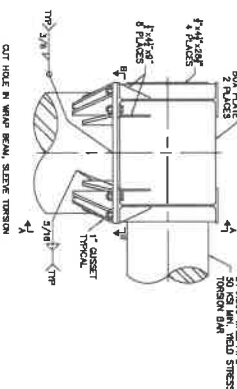
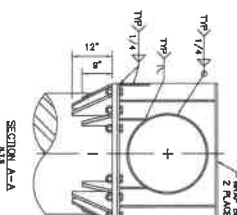
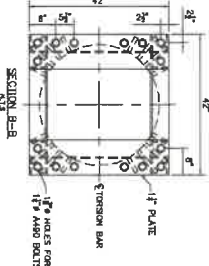
DELTA
N.T.S

1. All wiring, labeling, paneling and construction shall conform to the National Electrical Code and specifications for the National Electrical Code (NEC).
2. Concrete shall be 12,000 P.S.I., 28 days.
3. Reinforcing Steel (Lapspaced) shall be ASTM A-615 Grade 60.
4. All reinforcing steel shall be free from mud, oil, rust or coatings that would reduce or destroy bond.
5. All reinforcing bars shall lap 20 diameters unless specified otherwise.
6. All lap splices shall be staggered.
7. All bars shall be bent and all surfaces not exposed to weather shall be galvanized.
8. 3/4" bars for walls and end anchors not exposed to weather shall be galvanized.
9. 3 inches for ordinary surfaces shall be galvanized.

[illegible]

This drawing is for permitting purposes only, unauthorized use prohibited.

Selective Structures, LLC
811 East Avenue
Athens, TN 37303
▼
10'-6" x 36'-0" FF, 15V @ 40'-0" O.A.H.
w/Up to Two (2) 4.725# Digital Displays
Located In: Smyrna, GA

GINN
ENGINEERING
SERVICES

GINN ENGINEERING SERVICES, LLC
1971 FLATROCK RD.
WATKINSVILLE, GA 30677
678-232-0872

MISSIONS



INSTALL BY:	TCS
DATE:	02/16/22
SELECTED BY:	Permittin
SCALE:	1/4"=1'-0"
PROJ.#	####
DWG.#	AC-078
SHEET#	1 OF 1

THE STRUCTURE SHOWN, AS DESIGNED, IS CAPABLE OF SUPPORTING UP TO TWO (2) DIGITAL UNITS WEIGHING UP TO APPROXIMATELY 4,725# EACH.

NOTE: UP UPPER & LOWER ROSE CHIMNELS NOT SHOWN FOR CLARITY

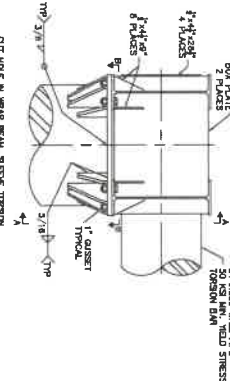
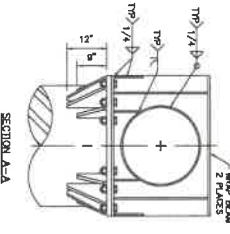
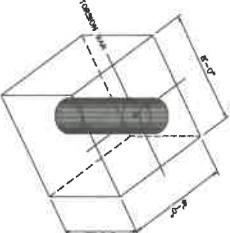
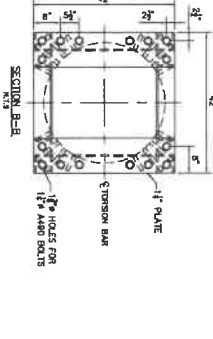
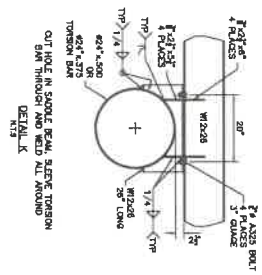
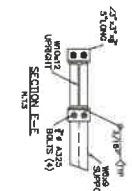
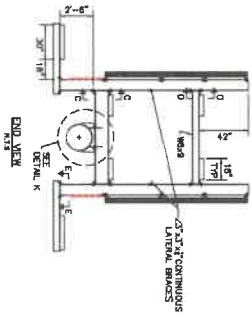
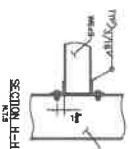
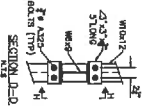
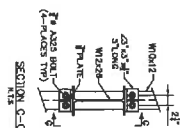
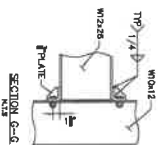
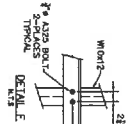
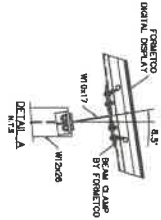
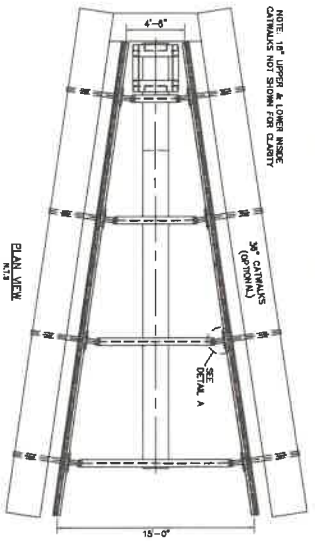

GENERAL NOTES

- All design, detailing, fabricating and construction shall conform to the following code and specifications:
 - ASTM A-36 (Current Edition), Steel (3018 Edition)
 - American Society of Testing and Materials (ASTM) specifications.
 - ASTM A-36 (Current Edition) for Reinforced Concrete (ACI 318-(Current Edition))
 - Code for Welding in Building Construction of the American Welding Society (AWS) (Current Edition)
 - Specification for Structural Steel Buildings by the American Institute of Steel Construction (AISC) (Current Edition)
- Concrete shall be 4,000 P.S.I. @ 28 Days (P.C.F.)
- Reinforcing Steel (Fabricated) shall be ASTM A-615 Grade 60. All bars shall be lap spliced and shall be free from mud, oil, rust or coatings that would reduce or destroy bond.
- All welding shall be by the Shielded Metal Arc Welding (SMAW) process. All welds shall be made in accordance with the AWS D1.1 (Current Edition) Code for Structural Steel Welding. All welds shall be made in accordance with the AWS D1.1 (Current Edition) Code for Structural Steel Welding. All welds shall be made in accordance with the AWS D1.1 (Current Edition) Code for Structural Steel Welding.
- Welding electrodes shall comply with AWS D1.1-(Current Edition), E70xx.
- Design Wind Speed= 110 MPH (0.9 G).
- Equivalent Wind Load= 22.2 PSF @ 45'-0" above ground level, 3 second gust.
- Soil Bearing Capacity Requirements: 5.0 G.P.S.F. @ 4'-0" depth. 10.0 G.P.S.F. @ 6'-0" depth. 15.0 G.P.S.F. @ 8'-0" depth. 20.0 G.P.S.F. @ 10'-0" depth.
- Contractor shall verify all dimensions and conditions in the field before erection and notify the Engineer of any discrepancies.
- Selling of open leading or solid diameter, and all shall be provided. A full penetration weld at ground level (ANSI D1.1) shall be used and shall be performed by a certified welder. Splice shall not be within one foot of the foundation upon which it is placed. Splice shall not be within one foot of the foundation upon which it is placed. Splice shall not be within one foot of the foundation upon which it is placed.
- The structure shown, as designed, is capable of supporting up to two (2) digital displays weighing up to approximately 4,725# each.

This drawing is for permitting purposes only, unaltered use prohibited.

Selective Structures, LLC

811 East Avenue
Athens, TN 37103

10'-6" x 36'-0" FF, 15'V @ 40'-0" O.A.H.
w/Up to Two (2) 4.725# Digital Displays
Located in Smyrna, GA

GINN
ENGINEERING SERVICES, LLC
1971 FLATROCK RD.
WATKINSVILLE, GA 30677
678-232-0872

DATE: 02/16/24
DRAWING: 3-4-24
SHEET: 1 OF 1

