

SCALE : 1" = 400'

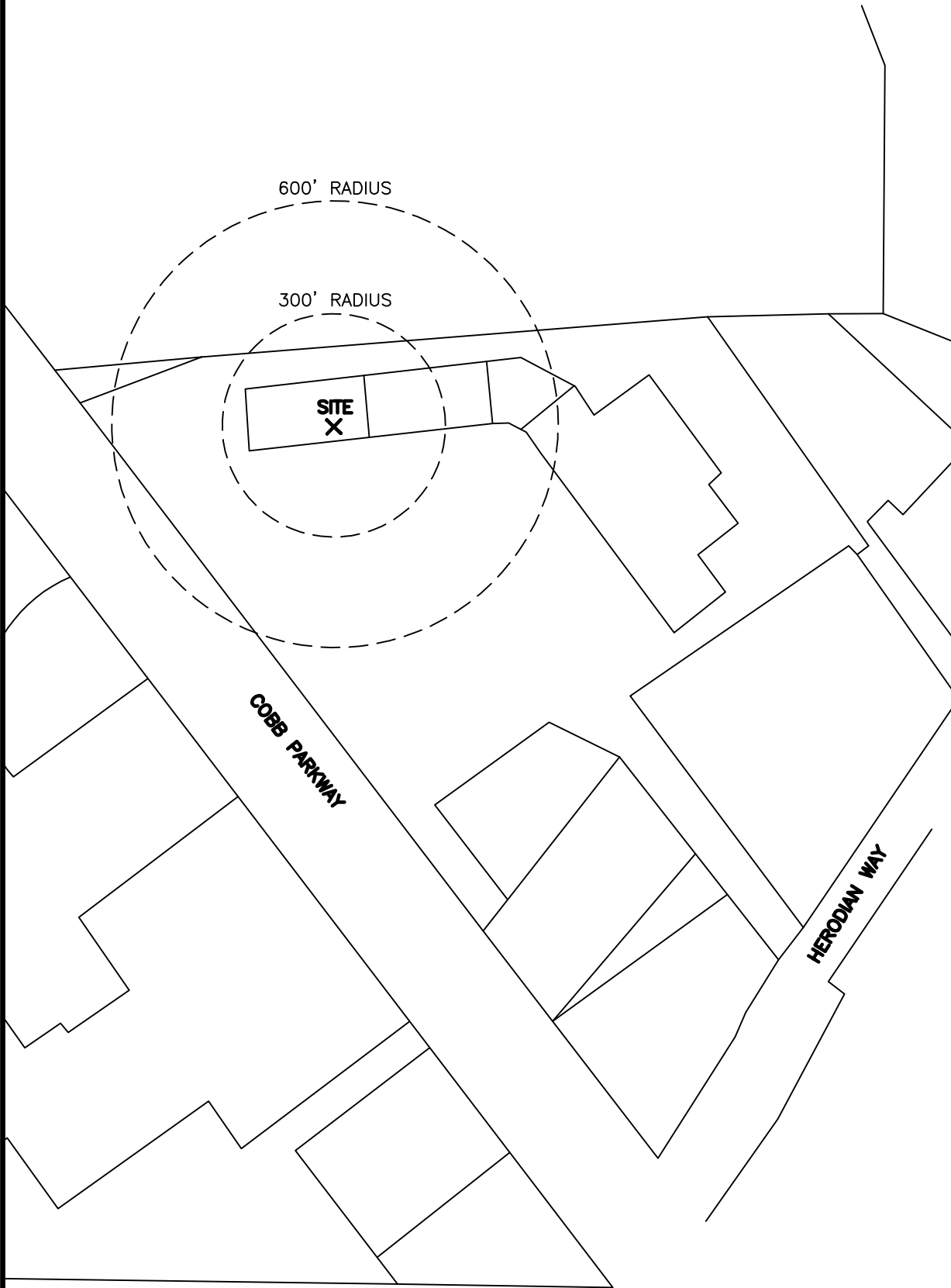

NEAREST CHURCH
CELESTIAL CHURCH OF CHRIST
1755 ROSWELL ST SE
SMYRNA, 30080
11,616 FEET

NEAREST SCHOOL
ARGYLE ELEMENTARY SCHOOL
2420 SPRING ST SE
SMYRNA, 30080
5,280 FEET

NEAREST PARK
JONQUIL PARK
3000 PARK RD
SMYRNA, 30080
5,280 YARDS

NEAREST LIBRARY
VININGS PUBLIC LIBRARY
4290 PACES FERRY RD
ATLANTA, 30339
15,840 FEET

NEAREST RESIDENCE
CECILIA COX
2786 AVINGTON LN
SMYRNA, 30080
4,079 FEET

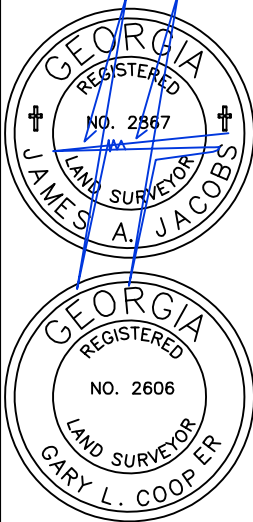

ADAM & LEE LAND SURVEYING

5640 GA. HWY. 20 S.
LOGANVILLE, GA. 30052 (770)554-7433

www.adamandlee.com

COA-LSF#000717

CITY OF SMYRNA BEER AND WINE SURVEY

TACOS LA VILLA

2415 COBB PARKWAY, SMYRNA, GEORGIA, 30080

COUNTY: COBB DISTRICT: 17TH SECTION: 2ND

LAND LOT: 849

DATE OF PLAT PREPARATION

08/13/2024 BY: KKB

DATE OF FIELD SURVEY

07/30/2024 BY: WHJ

SCALE: 1"=400'

SHEET # 1 OF 1

24176