

SITE PLAN LEGEND	
---	PROPERTY LINE
---	PAVEMENT LINE
---	EXISTING STRUCTURE
---	DEMO STRUCTURE
---	NEW STRUCTURE
---	EXISTING LIMITS OF DISTURBANCE
---	DEMO LIMITS OF DISTURBANCE
---	PROPOSED LIMITS OF DISTURBANCE
+	EXISTING IMPERVIOUS HATCH
+	DEMO IMPERVIOUS HATCH
+	PROPOSED IMPERVIOUS HATCH

	LAND DISTURBANCE OR CLEARING (IN SF)	IMPERVIOUS SURFACE (IN SF)
EXISTING	3,678 SF	3,200 SF
DEMO	-56 SF	-46 SF
PROPOSED	349 SF	327 SF
TOTAL	3,971 SF	3,481 SF

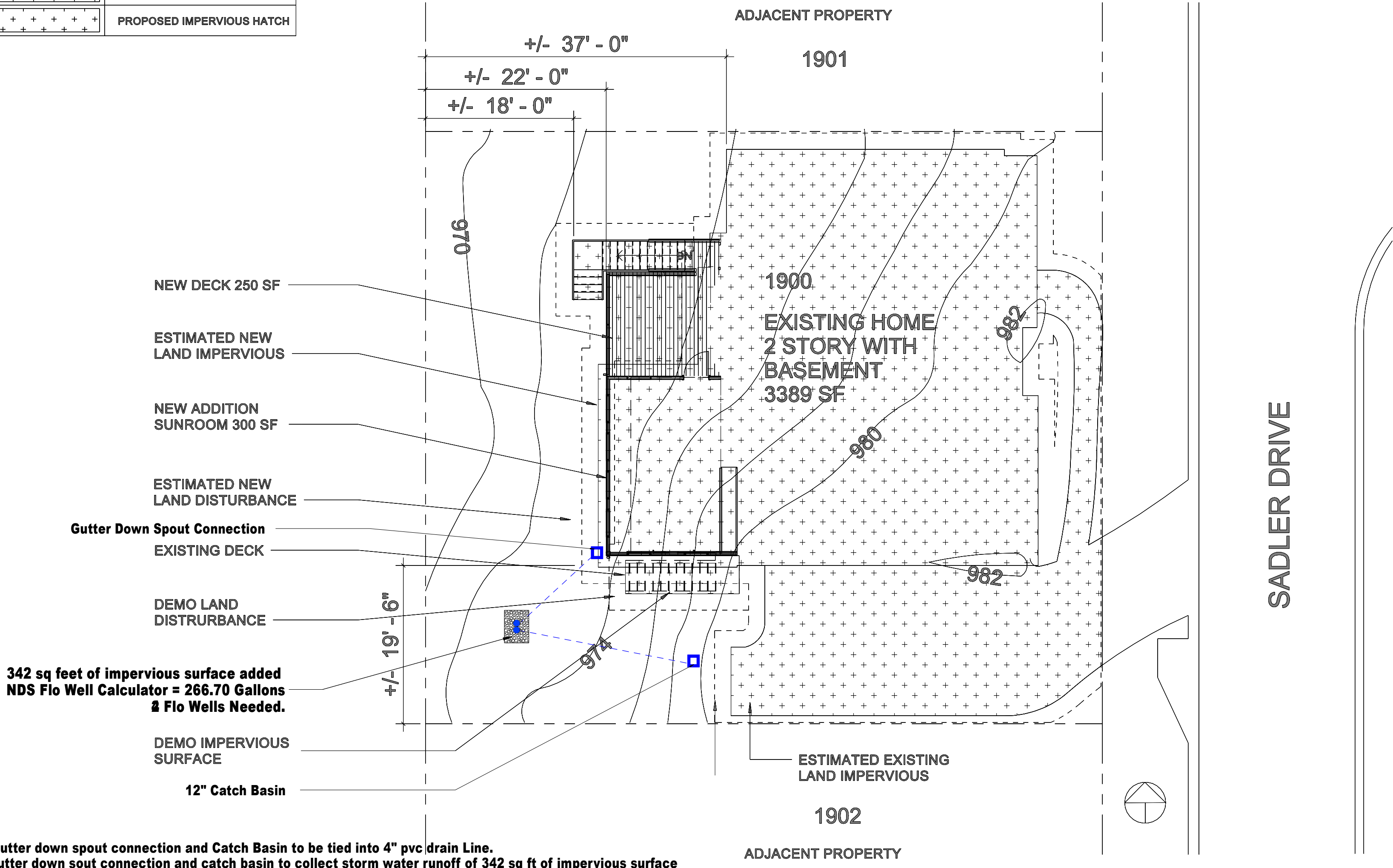
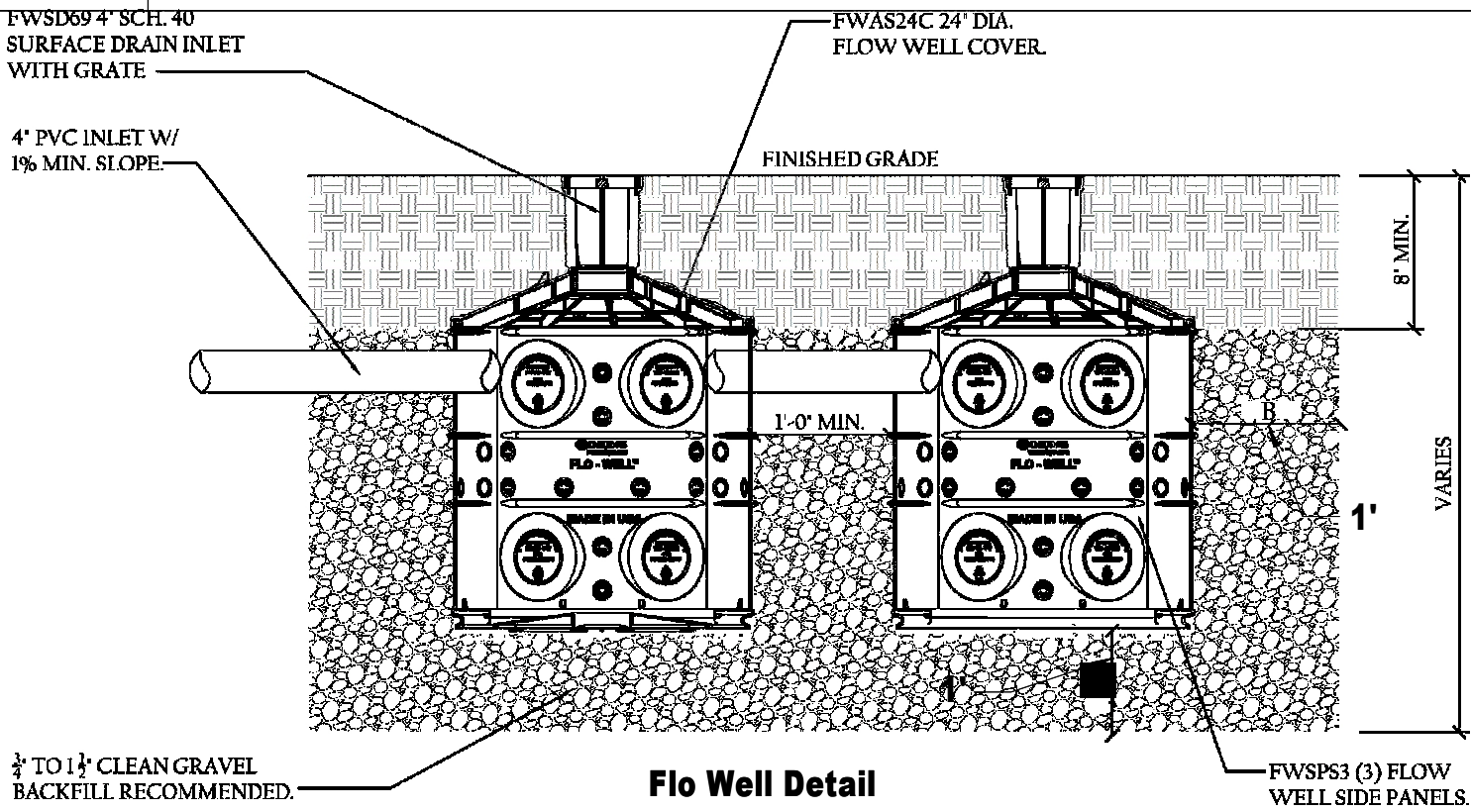

Note: Gutter down spout connection and Catch Basin to be tied into 4" pvc drain Line.
Gutter down sout connection and catch basin to collect storm water runoff of 342 sq ft of impervious surface

SCALE: 1" = 10'-0"

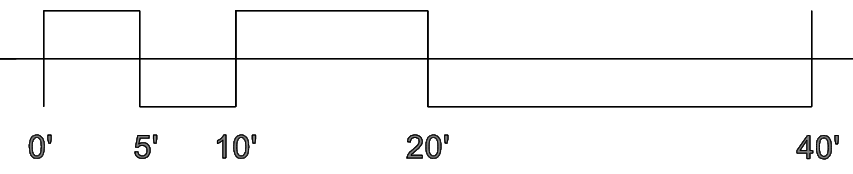

SMYRNA SUNROOM ADDITION
1900 SADLER DRIVE
SMYRNA, GEORGIA 30080

Stormwater
Mitigation Plan