

CALCULATION OF IMPERVIOUS SURFACE	
Lot Area (ft²)	11914
Existing Impervious	Area (ft²)
House	1184
Addition	0.00
Patio & Walkways	71.00
Accessory Structures (i.e. tool shed, detached garage, etc)	0.00
Swimming Pool	0.00
In-ground Above-ground	0.00
Sidewalk (portion on Lot)	0.00
Driveway/Driveway Apron (portion on lot)	590.00
OTHER:	None
TOTAL EXISTING IMPERVIOUS SQUARE FOOTAGE / PERCENTAGE OF LOT AREA	1845.00
Proposed Impervious	Area (ft²)
Structures (New Addition)	1,833.00
Structures (New Wood Deck)	160.00
Driveway	0.00
Patio & Walkways	0.00
Swimming Pool	0.00
In-ground Above-ground	0.00
OTHER:	0.00
TOTAL PROPOSED IMPERVIOUS SQUARE FOOTAGE / PERCENTAGE OF LOT AREA	1993.00
COMBINED TOTAL OF IMPERVIOUS SURFACE OF LOT AREA SQUARE FOOTAGE/PERCENTAGE	3838.00
	3838.00 / 11914.00 =0.322 (32.2%)

1061 DELL AVE SE
APN:17048600470

1051 DELL AVE SE
APN:17048600460

1060 MCLINDEN AVE SE
APN:17048600450

MCLINDEN AVE SE
40' R/W

HOLLIS ST
40' R/W

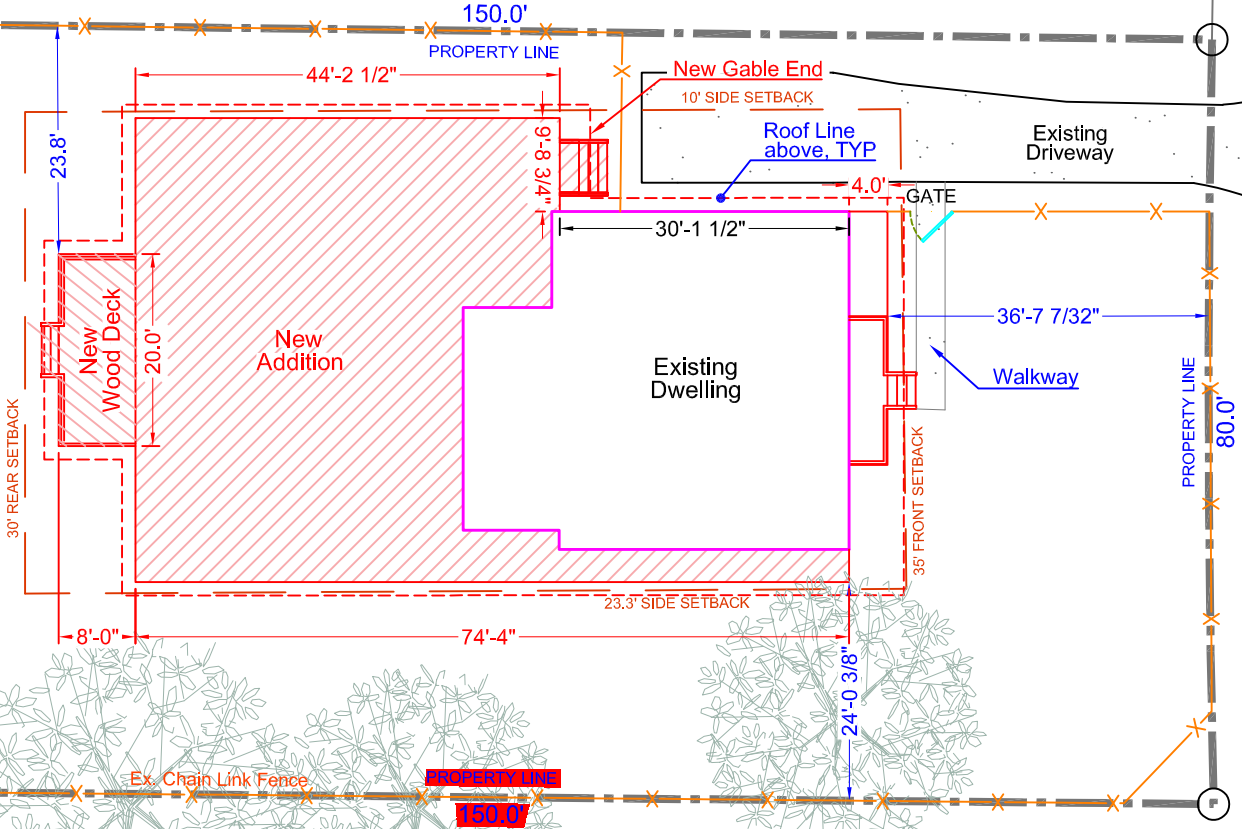

Note:

AN AS-BUILT SURVEY WILL BE REQUIRED PRIOR TO THE FOUNDATION POUR DUE TO THE PROXIMITY TO SETBACKS

THE CHAIN LINK FENCE IN THE FRONT WILL BE REMOVED; THE CHAIN LINK FENCE IN THE BACK WILL REMAIN UNDISTURBED, THE CHAIN LINK FENCE CANNOT BE REPLACED WITHOUT A VARIANCE

Parcel No. (APN) 17048600440
Parcel Use R3 - RESIDENTIAL 1 FAMILY
Zoning R-15
XXX
Building Area 1184 SF
Lot Area 11914 SF (0.27 ACRES)
Building/Lot Area 0.10

1068 MCLINDEN AVE SE
SMYRNA, GA 30080
Scale: 1" = 20'

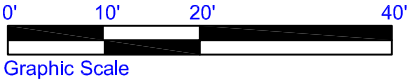

THIS IS NOT A LEGAL SURVEY.
NOR IS IT INTENDED TO BE OR REPLACE ONE
This work product represents only generalized locations of features, objects or boundaries and should not be relied upon as being legally authoritative for the precise locations of any feature, object or boundary.