

ALCOHOLIC BEVERAGE LICENSE SURVEY
PREPARED FOR:
**KEYSAC ENTERPRISES, LLC/DBA:
EL ENCANTO**
LAND LOT 378, 17TH DISTRICT
2ND SECTION, COBB COUNTY, GEORGIA

SURVEY NOTES: NEAREST DISTANCE TO:

- Private Residence: 600 Plaza Dr SE, Smyrna, GA 30082 (216 Yards)
- Church: Smyrna Church of the Nazarene, 531 Plaza Dr SE, Smyrna, GA 30082 (704 Yards)
- Public School: Belmont Hills Elementary School, 605 Glendale Pl, Smyrna, GA 30080 (1,056 Yards)
- Package Store: First Choice Beer, Wine & Spirits, 2900 S Cobb Dr SE Suite B1, Smyrna, GA 30082 (37.4 Yards)
- College: Chattahoochee Technical College - Marietta Campus, 980 S Cobb Dr SE, Marietta, GA 30060 (6,160 Yards)
- Daycare: Compass Academy Preschool and Childcare, 2820 Cobb Ln, Smyrna, GA 30082 (190 Yards)
- Public Park: Cobb Park and Kidscape Village I & II, 2776 Sanford Rd SE, Smyrna, GA 30080 (1,056 Yards)
- Public Library: Smyrna Public Library, 100 Village Green Cir SE, Smyrna, GA 30080 (2,112 Yards)
- Alcohol Treatment Center: Rebos Inc, 304 Poplar St, Marietta, GA 30060 (4,048 Yards)
- Public Pool: Wolfe Aquatic Center, 884 Church St, Smyrna, GA 30080 (1,408 Yards)

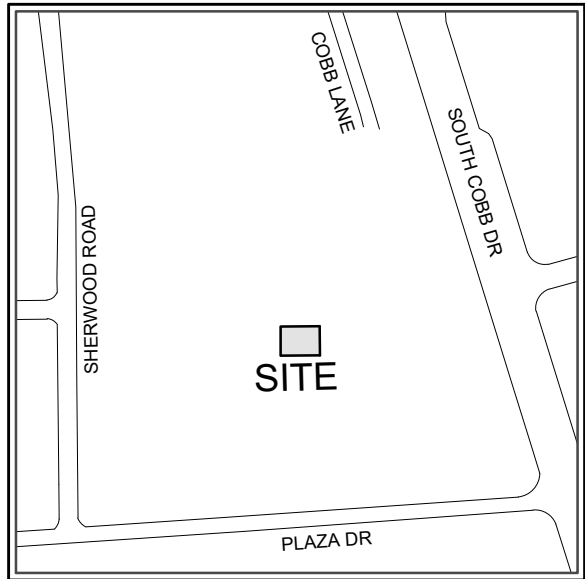
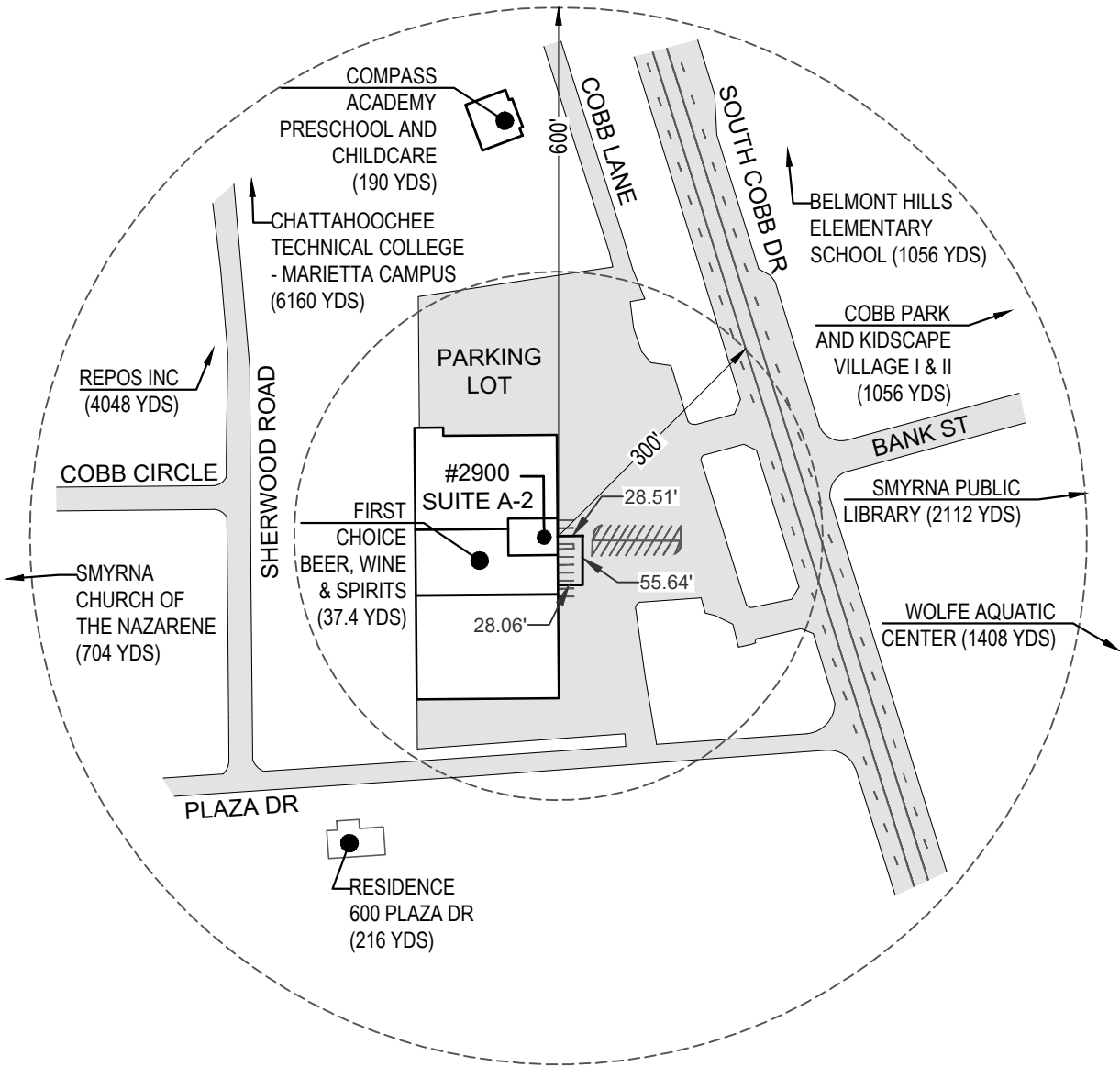

VICINITY MAP

N.T.S.

MEASUREMENT METHOD:
DISTANCES SHALL BE MEASURED BY THE MOST DIRECT ROUTE OF TRAVEL ON THE GROUND.

GRAPHIC SCALE

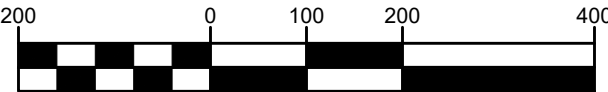

(IN FEET)
1 inch = 200 ft.

UNITED LAND SURVEYING, LLC. ALL RIGHTS ARE RESERVED. ANY POSSESSION, REPRODUCTION OR OTHER USE OF THIS DOCUMENT WITHOUT PRIOR WRITTEN PERMISSION FROM UNITED LAND SURVEYING, LLC. IS EXPRESSLY PROHIBITED.

JOB NUMBER:
24-439

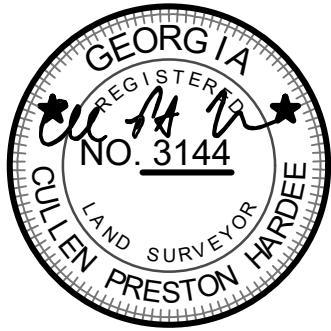

PLAT DATE: 9/27/2024
FIELD DATE: 9/12/2024
SCALE: 1"=200'
DRAWN BY: C.E.M.
REVIEWED BY: C.P.H.

REVISIONS	
1.	
2.	
3.	
4.	
LEGAL REFERENCE:	
DEED BOOK: 13610	PAGE: 6181
PLAT BOOK: 32	PAGE: 78

SHEET 1 OF 1

ALCOHOLIC BEVERAGE LICENSE SURVEY
KEYSAC ENTERPRISES, LLC/DBA: EL ENCANTO

LAND LOT 378, 17TH DISTRICT
2ND SECTION, COBB COUNTY

GEORGIA

1258 CONCORD ROAD SE SUITE 103
SMYRNA, GEORGIA 30080
Ph. (678) 293-5232

VISIT US ON OUR WEBSITE:
www.united-uls.com

UNITED LAND SURVEYING
COA NO. LSF 001321