

**ORIGINAL**

CITY OF SMYRNA  
PURCHASING DEPARTMENT  
2800 KING STREET  
SMYRNA, GEORGIA 30080  
678-631-5406

TO: Keith Zgonc – Chief of Police, Smyrna Police Department  
Major Rick James, Smyrna Police Department

FROM: Kelly Brown, Purchasing Manager

DATE: September 10, 2024

SUBJECT: Recommendation – 25-009 E-911 Furniture Replacement

The Smyrna Police Department budgeted FY2025 CIP funds for furniture replacement for E-911. The project includes replacement of workstation consoles and IT hardware equipment.

Firm	Contract	Cost
Watson Consoles	Omnia Partners – NCPA # 07-64	\$ 144,688.38
NetPlanner Systems Inc. (cabling & labor)	98000-GTADirect- Contract # 4666-NPS	\$ 12,865.32
CDW-G (Adder USB audio switch)	Sourcewell Contract # 121923	\$ 3,517.55
Monoprice (surge protectors and cables)		\$ 1,068.33
Southern Computer Warehouse – SCW (Logitech speakers)		\$ 113.15
Dell Technologies (24” monitors)		\$ 4,879.35
<b>TOTAL</b>		<b>\$ 167,132.08</b>

It is the recommendation of Purchasing and Police that this project be awarded to Watson Consoles, NetPlanner Systems, CDW-G, Monoprice, SCW, and Dell Technologies for total cost of \$167,132.08.

Please prepare any necessary paperwork to present to the Mayor and Council for approval.

ACCEPTED:

\_\_\_\_\_  
Derek Norton, Mayor

\_\_\_\_\_  
Date

**ATTEST:**

*Cecilia H. Deacon-Corn*

City Clerk



**SCANNED**

BY: \_\_\_\_\_ Date: \_\_\_\_\_

**APPROVED**

Per the City of Smyrna  
Mayor and Council

Official Meeting Minutes

Date: \_\_\_\_\_

## Smyrna Police Dept - GA

**Specified For:** City Of Smyrna - GA  
**Contact Name:** Rick James  
**Phone Number:** 404-606-1477  
**Email Address:** rjames@smyrnaga.gov

**Watson Rep Firm:** King Carter & Associates, Inc  
**Watson Sales Rep:** Ben Whitley  
**Phone Number:** 7703107621

**Project Summary:** 5 Mercury Pro Worksurfaces

**\*\*NCPA 07-64 Pricing\*\***

Each Position Includes:

84"W Pro Worksurface – Height-Adjustable with Depth Adjustment, Environmental Control and In-Dash Power  
- Environmental Control: Forced Air Heat, Cooling Fans, LED Ambient Lighting and Dimmable LED Task Lighting  
- In-Dash Power: 2 Power Outlets  
Double Tier Monitor Array – Height-Adjustable with Individually Adjustable Monitor Arms: 4 over 4  
Technology Bridge Storage to Accommodate up to (3) Mid-Tower PCs No Larger Than 7"W x 15"H x 15.75"D  
Technology Cabinet to Accommodate up to (4) Full-Tower PCs  
Personal Storage – Personal Stacker (Open Door Box)  
Screens – 42"H Fabric  
Accessories – Grounding Bar, (2) Motorola Speaker Brackets, (2) Motorola Headset Jacks, Single Cup Holder  
Technology Ports Per Position - (6) USB-A Data I (1) Dual USB-A Charging I (1) Dual USB-A/C Charging I (1) 35mm Audio

Dispatch 1 - 3 and 5 Include Hub-Mounted End Stacker Storage (Double Door)

Dispatch 3 and 4 Share a Team Desk – 84"D x 42"W Worksurface with In-Surface Power (Dual Hinge Full Power with 3 Power, 1 Dual USB, 1 CAT6, and 1 HDMI) and Cable Bridge

**Finish Selection:** Undecided **\*\*REQUIRES SELECTION BEFORE PO SUBMITTAL\*\***

### Installation:

Type of Site – Empty Room  
Pre-Installation Site Prep – None  
Location – 2nd Floor, Certified Elevator  
Prevailing Wage or Union – No  
Additional Information – Raised Floor Power. Quote Does Not Include Prevailing Wage or Union Labor Requirements.

**Quote Date:** 9/11/2024 **Quote Expiration** 12/11/2024 **Quote Revision:** 08 **Watson Account Manager:** Kelsey Hoskins

## Terms and Conditions

### Drawings and Floorplans

It is necessary that accurate room dimensions and features are provided to Watson for space planning and installation. Watson commits to providing product symbols that are correct in size. It is the responsibility of the customer to verify that the room dimensions and features provided to Watson are accurate prior to submitting a purchase order.

All purchase orders must be accompanied by the drawing and quote that has been approved for manufacture. Watson quotes are valid 90 days from the date of issue.

### Purchase Orders and Order Acknowledgments

Purchase orders should be submitted via email to:  
**orders@watsonfg.com**

All purchase orders must include the following information:

- Sold-to information including billing address and contact name with email and phone number
- Ship-to information including installation address and contact name with email and phone number
- Purchase order number
- Order total
- Final finish selections
- Approved final drawing and quote for manufacture (proposal and revision number must match across all pages)
- Requested delivery / installation date

Any omission may result in the delay of processing the order. All quotations, acknowledgments, and invoices are subject to corrections for errors or omissions.

All orders and subsequent change orders must be in writing. Watson will issue an acknowledgment of the order that includes estimated delivery date. The acknowledgment is the final agreement between Watson and the customer.

### Order Cancellations and Changes

Acknowledged orders may not be changed or canceled, in whole or in part, without prior written consent of Watson.

Orders for which production has started may not be canceled. Orders that include non-standard products and non-standard finishes may not be canceled. In the event of cancellations prior to the start of production, for standard products, the customer will be liable for cancellation charges of 25% of the order total.

Any approved order change will require the customer to resubmit the approved final drawing and quote reflecting the requested change. An order change may affect the delivery date. Expenses incurred because of order changes will be charged to the customer.

### Taxes

All sales, use, excise, and other applicable taxes are the purchaser's responsibility and will be invoiced to the purchaser. If purchaser claims an exemption from such taxes, it shall be the purchaser's responsibility to furnish an appropriate exemption certificate at the time the order is placed.

### Payment Terms

Orders are invoiced at time of shipment. Standard payment terms are 50% due at time of order and 50% due before shipment.

When credit is extended for net thirty 30 days, payment is due within 30 days of shipment. Past due accounts will be charged the lesser of 1-1/2% per month or the highest rate permitted by law plus all collection costs, including reasonable attorney's fees and expenses.

Credit card payments are accepted up to \$5,000. Payments above that amount can be made by check or ACH.

### Freight

Freight will be quoted on a per project basis considering destination location, order size and weight as well as the current freight market. Watson Console freight terms are FOB destination to all 50 US States.

Charges incurred by Watson complying with non-standard shipment requests such as inside delivery, expediting, redelivery, weekend delivery, unpacking, straight trucks, specific driver requests or temporary holding will be invoiced to the purchaser. Risk of loss shall pass to purchaser at the time Watson places the product(s) in the possession of a common carrier or at the time of delivery to the purchaser in the case of delivery by Watson vehicles.

### Freight Claim

We'll file the freight claim on your behalf. But to do that - we'll need your help.

**FREIGHT DAMAGE:** It is the customers responsibility to examine products upon receipt, note the damage or shortage on the bill of lading, and to notify Watson within 24 hours of delivery. Failure to provide notice within 24 hours constitutes acceptance of the product.

**CONCEALED DAMAGE:** Claims must be made by the customer in writing and with photographs within five (5) business days after delivery. Failure by the customer to make any concealed damage claim within five (5) business days constitutes acceptance of the product and a waiver of any apparent damages.

### Storage

We understand that projects sometimes face unforeseen delays. If the request to move an order out is received more than 25 business days prior to the acknowledged ship date, we can likely accommodate that request without additional cost. If the request to move an order out is received less than 25 business days prior to the acknowledged ship date, customers may opt to contract storage with Watson for up to 30 days post-ship date. Watson charges a storage fee of \$1 per day per \$1,000 of the total order invoice. The minimum storage fee is \$250. When storage occurs, we will consider that the product has been delivered to the customer for all purposes, and invoicing will occur. Costs for storage will be subsequently invoiced to the customer.

### Force Majeure

Watson shall not be liable for any loss, damage, or delay resulting from forces beyond its reasonable control including fire, flood, strike or other labor difficulty, act of God, or due to any cause beyond its reasonable control. In the event of any such delay, delivery will be postponed by such length of time as may be reasonably necessary to accommodate for the delay.

### Governing and Binding Terms

Watson's Terms and Conditions supersede provisions in a customer Agreement only to the extent that these terms are not covered by the customer Agreement.

Project

Smyrna Police Dept - GA

Proposal 1

Quote Revision: 08

Quote Date: 9/11/2024

Drawn By: JLW

Watson Sales Rep

Ben Whitley

Watson Account Manager

Kelsey Hoskins

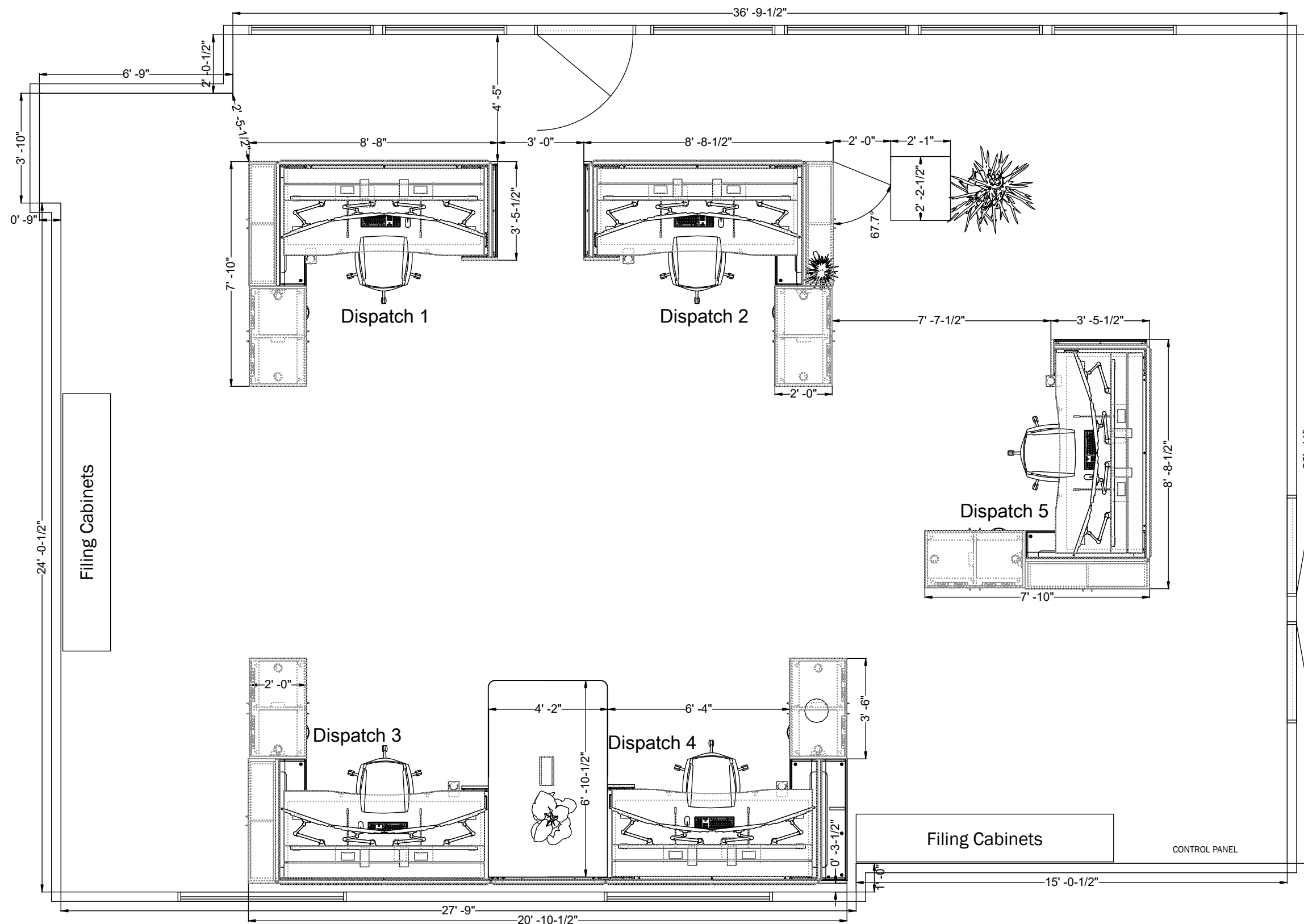





**watson  
consoles**

26246 Twelve Trees Lane NW  
Poulsbo, WA 98370  
www.watsonconsoles.com 360.394.1300  
2022 Watson Furniture Group, Inc. All Rights Reserved

**Project**

Smyrna Police Dept - GA

**Proposal 1**

**Quote Revision:** 08  
**Quote Date:** 9/11/2024  
**Drawn By:** JLW

**Watson Sales Rep**

Ben Whitley

**Watson Account Manager**

Kelsey Hoskins





watson  
consoles

26246 Twelve Trees Lane NW  
Poulsbo, WA 98370  
www.watsonconsoles.com 360.394.1300  
2022 Watson Furniture Group, Inc. All Rights Reserved

Project

Smyrna Police Dept - GA

Proposal 1

Quote Revision: 08  
Quote Date: 9/11/2024  
Drawn By: JLW

Watson Sales Rep

Ben Whitley

Watson Account Manager

Kelsey Hoskins





watson  
consoles

26246 Twelve Trees Lane NW  
Poulsbo, WA 98370  
www.watsonconsoles.com 360.394.1300  
2022 Watson Furniture Group, Inc. All Rights Reserved

Project

Smyrna Police Dept - GA

Proposal 1

Quote Revision: 08

Quote Date: 9/11/2024

Drawn By: JLW

Watson Sales Rep

Ben Whitley

Watson Account Manager

Kelsey Hoskins





**watson  
consoles**

26246 Twelve Trees Lane NW  
Poulsbo, WA 98370  
www.watsonconsoles.com 360.394.1300  
2022 Watson Furniture Group, Inc. All Rights Reserved

**Project**

Smyrna Police Dept - GA

**Proposal 1**

**Quote Revision:** 08

**Quote Date:** 9/11/2024

**Drawn By:** JLW

**Watson Sales Rep**

Ben Whitley

**Watson Account Manager**

Kelsey Hoskins



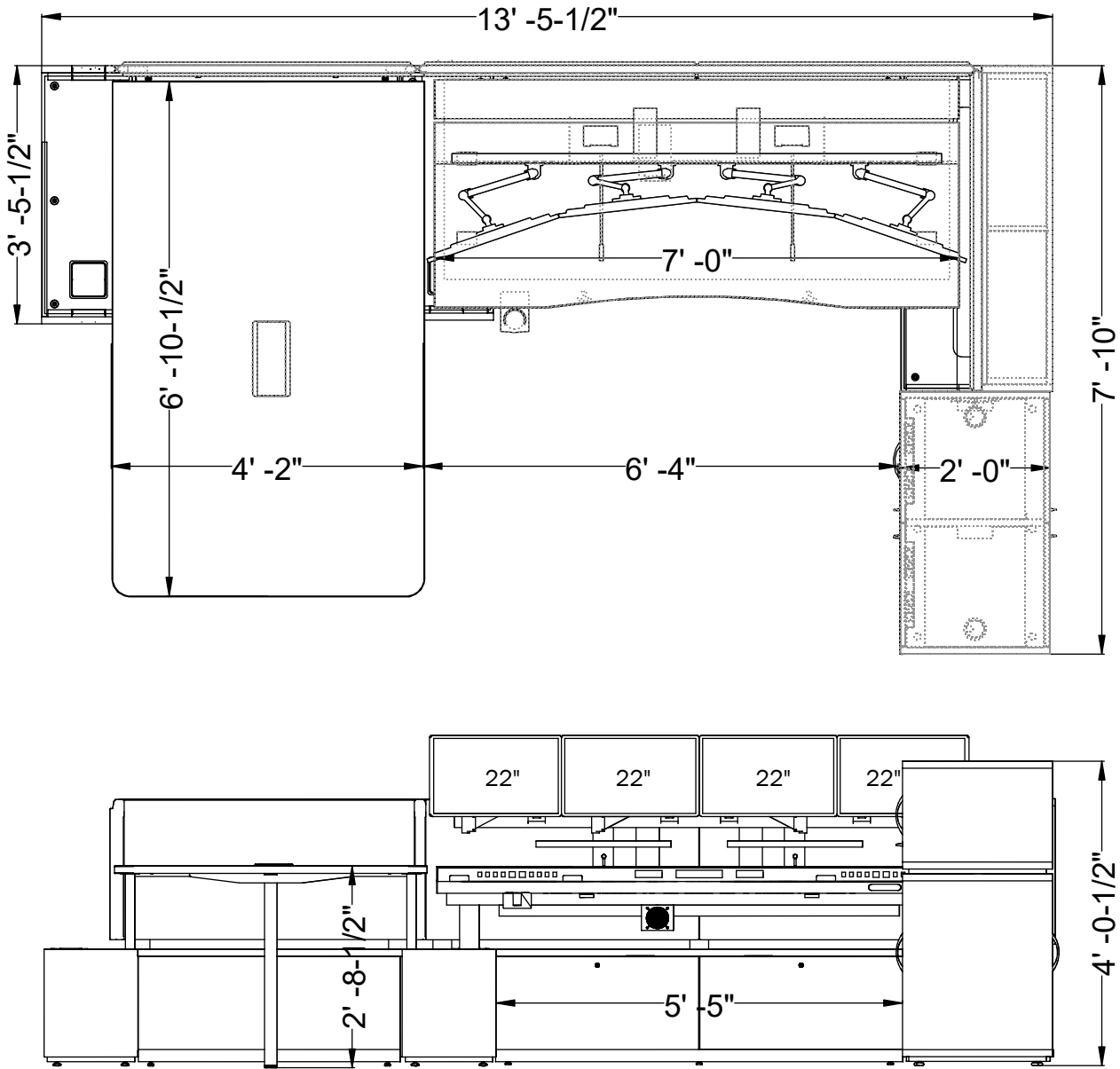

84"W Pro Worksurface

Environmental Control

Dual Tier Monitor Array

42"H Fabric Screens

Hub-Mounted End Stacker Storage

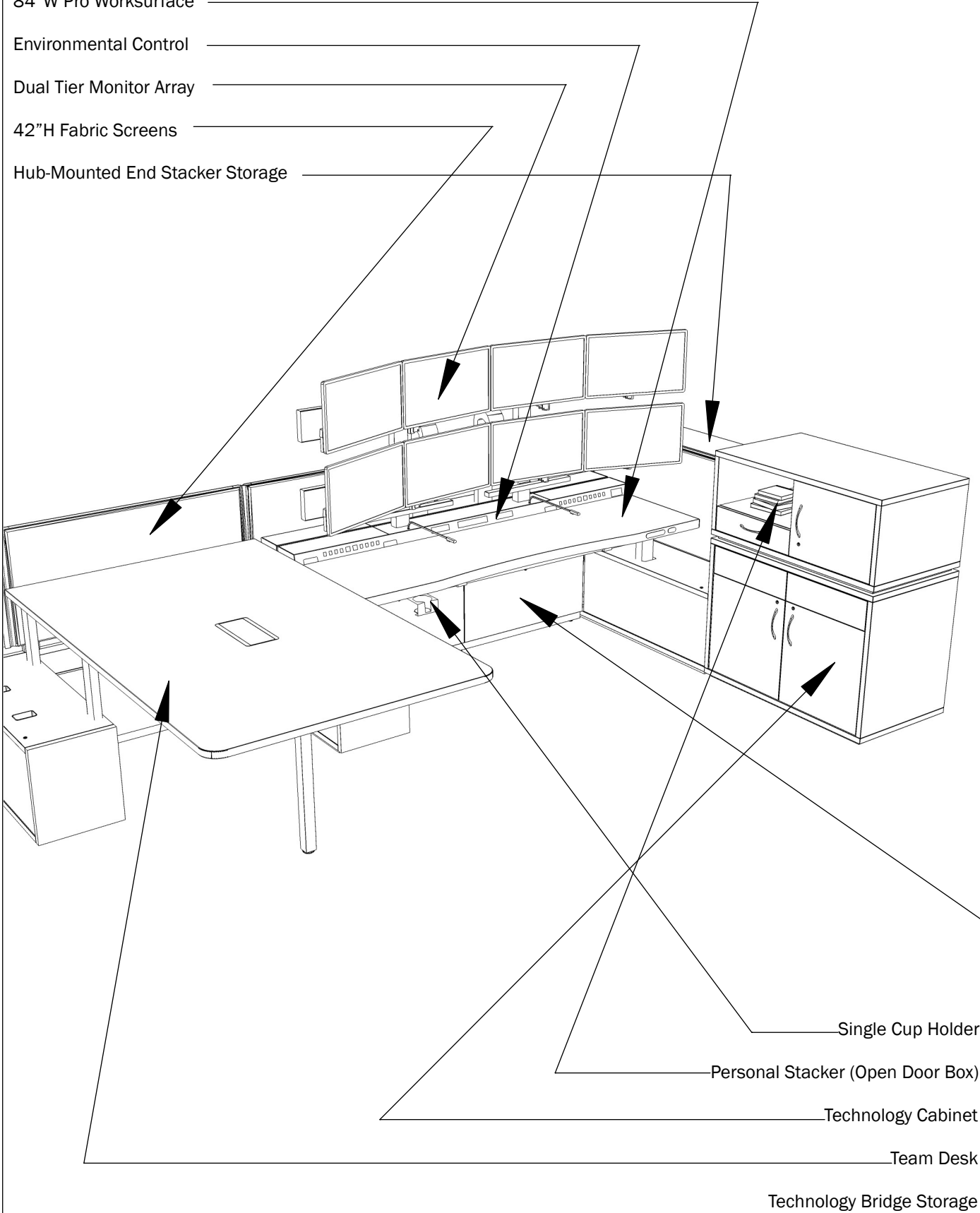

**watson  
consoles**

26246 Twelve Trees Lane NW  
Poulsbo, WA 98370  
www.watsonconsoles.com 360.394.1300  
2022 Watson Furniture Group, Inc. All Rights Reserved

**Project**

Smyrna Police Dept - GA

**Proposal 1**

Quote Revision: 08

Quote Date: 9/11/2024

Drawn By: JLW

**Watson Sales Rep**

Ben Whitley

**Watson Account Manager**

Kelsey Hoskins

**Typical 2D & 3D**

Mercury Pro Dispatch 1 and 4

Project

Smyrna Police Dept - GA

Proposal 1

Quote Revision: 08  
Quote Date: 9/11/2024  
Drawn By: JLW

Watson Sales Rep

Ben Whitley

Watson Account Manager

Kelsey Hoskins

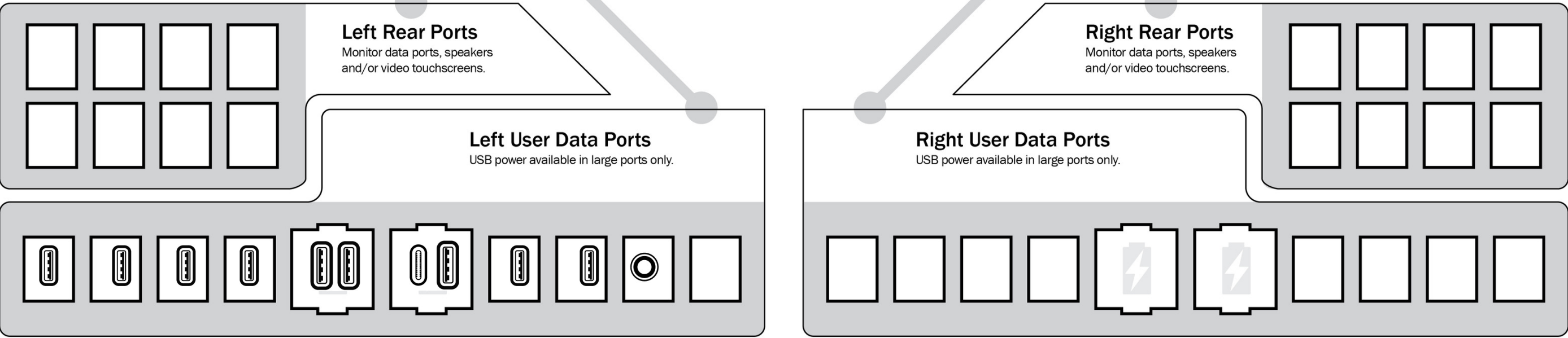
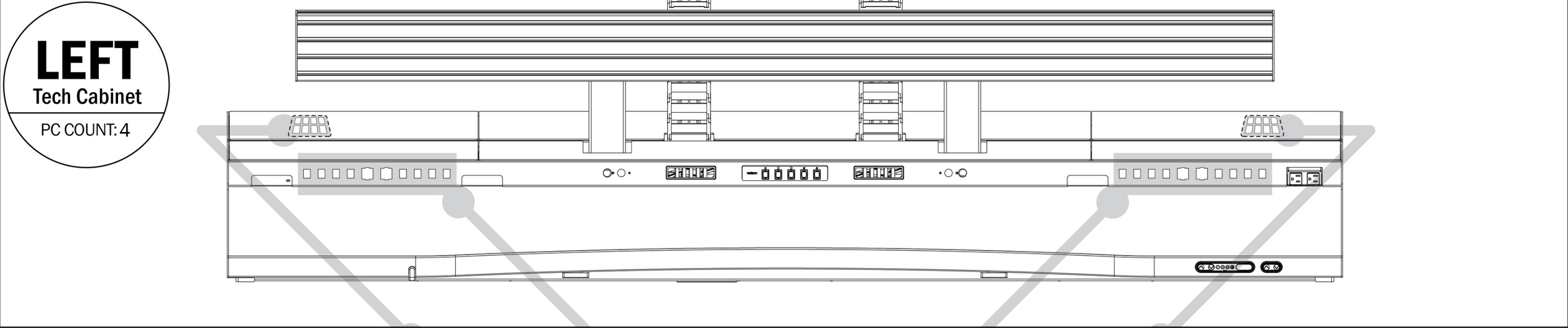

Data Port Types

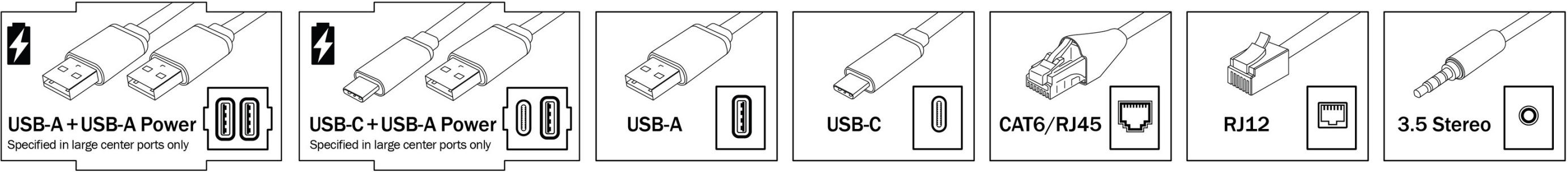



Mercury Pro Dispatch 2, 3, 5

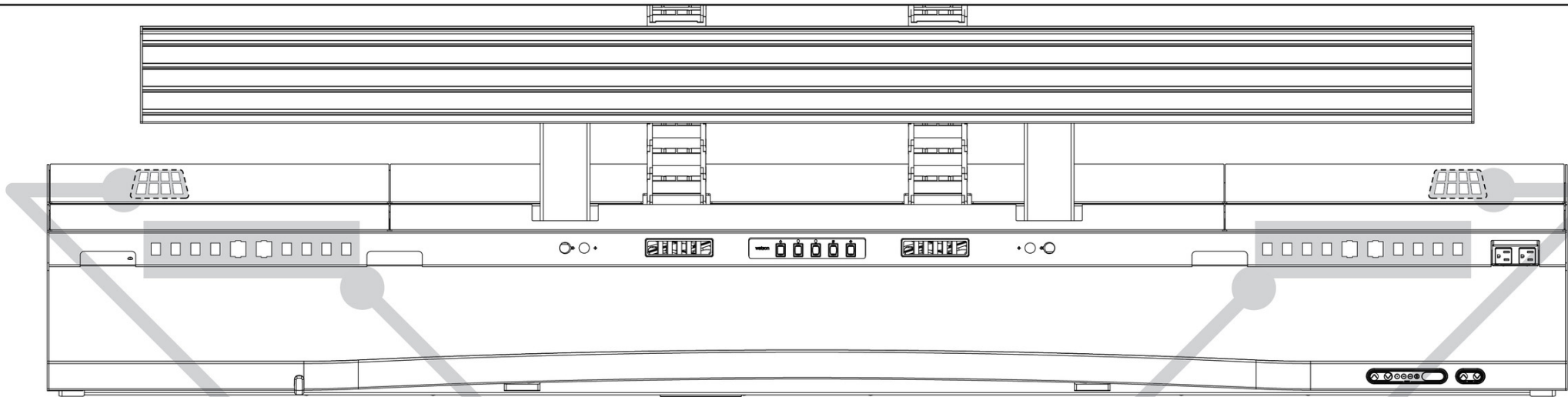

RIGHT

Tech Cabinet

PC COUNT: 4

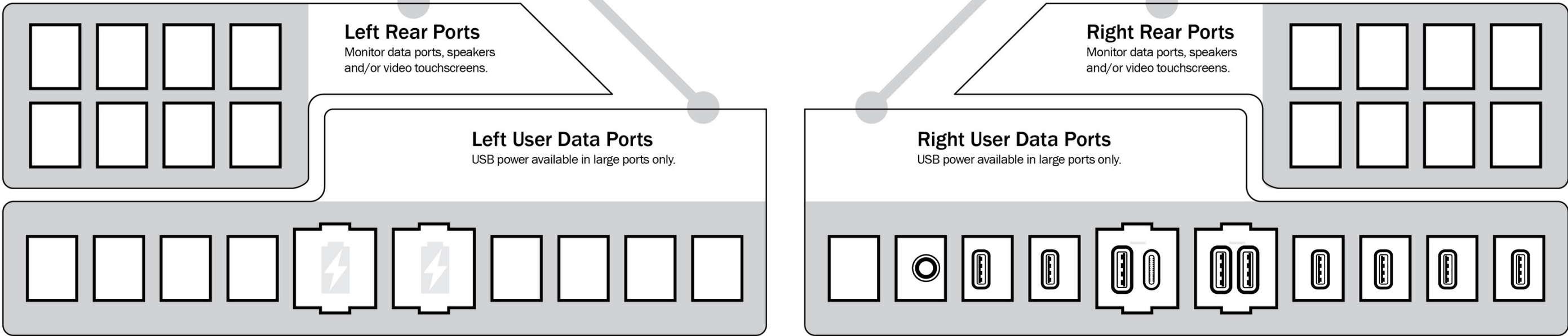

Data Port Types

USB-A + USB-A Power

Specified in large center ports only

USB-C + USB-A Power

Specified in large center ports only

USB-A

USB-C

CAT6/RJ45

RJ12

3.5 Stereo

Project
Smyrna Police Dept - GA
Proposal 1
Quote Revision: 08
Quote Date: 9/11/2024
Drawn By: JLW
Watson Sales Rep
Ben Whitley
Watson Account Manager
Kelsey Hoskins

Optional features may be shown.

# Raised Floor Power

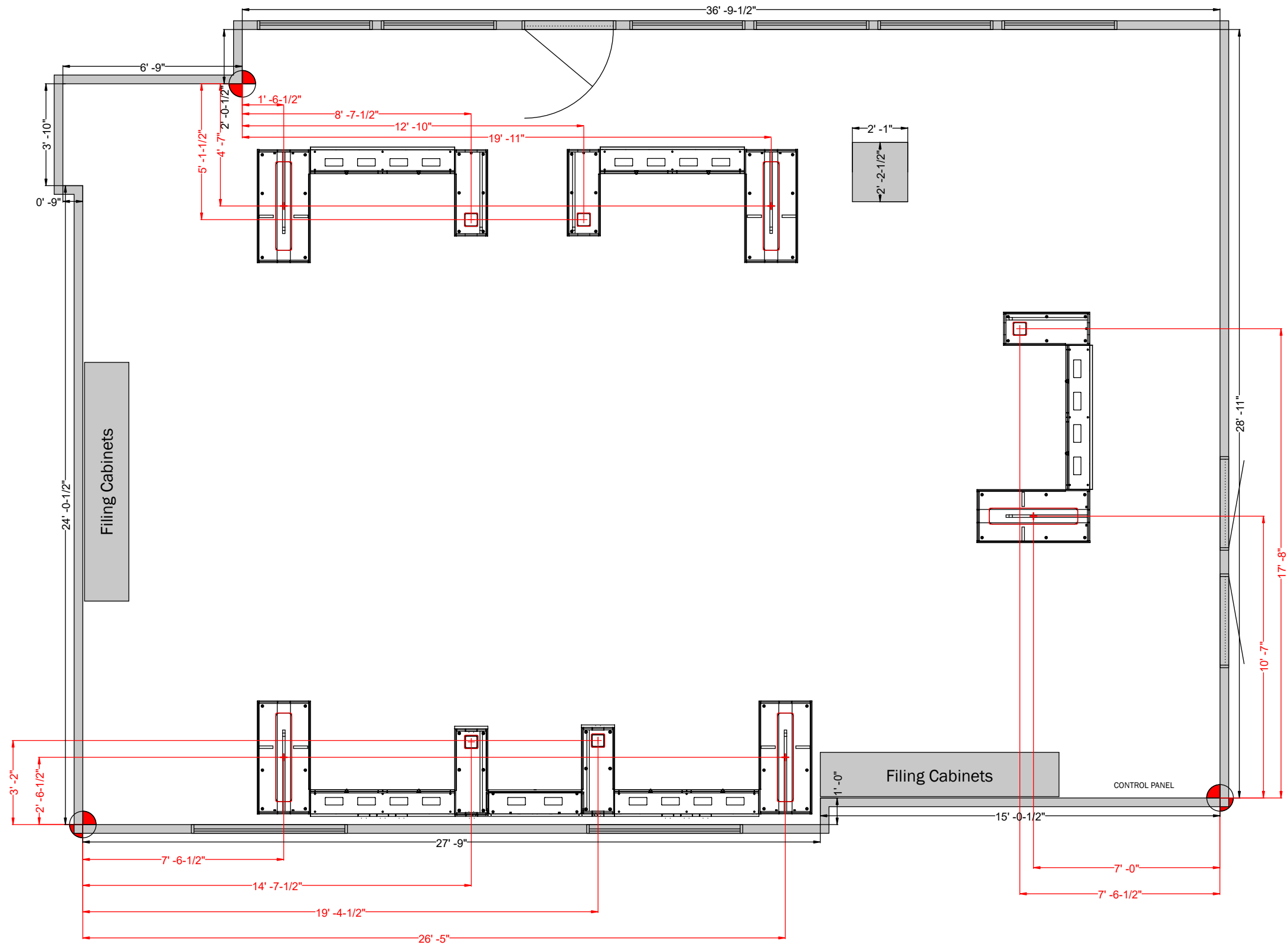

**watson  
consoles**

26246 Twelve Trees Lane NW  
Poulsbo, WA 98370  
www.watsonconsoles.com 360.394.1300  
2022 Watson Furniture Group, Inc. All Rights Reserved

## Project

Smyrna Police Dept - GA

## Proposal 1

Quote Revision: 08

Quote Date: 9/11/2024

Drawn By: JLW

## Watson Sales Rep

Ben Whitley

## Watson Account Manager

Kelsey Hoskins

Electrical Access



# Proposal 1

Project: Smyrna Police Dept - GA

## Sold to

Company name: City Of Smyrna - GA  
Contact Person: Rick James  
Contact Phone: 404-606-1477  
Contact Fax:

## Distributor

Company name: King Carter & Associates, Inc  
Salesperson: Ben Whitley  
Salesperson Phone: 7703107621  
Salesperson Fax:

**watson**

26246 Twelve Trees Lane NW Poulsbo, WA 98370  
360.394.1300 watsonfurniture.com

#	Qty	Part Number	Description	Sell	Ext. Sell
<b>Consoles</b>					
1	2	HD6H153918L-N	MERCURY PRO HUB, 15"D x 39"W x 18"H, LEFT HAND, NO GROMMET	\$2,320.50	\$4,641.00
2	1	HD6H153918R-N	MERCURY PRO HUB, 15"D x 39"W x 18"H, RIGHT HAND, NO GROMMET	\$2,320.50	\$2,320.50
3	2	HD6H245118L-N	MERCURY PRO HUB, 24"D x 51"W x 18"H, LEFT HAND, NO GROMMET	\$2,709.00	\$5,418.00
4	3	HD6H245118R-N	MERCURY PRO HUB, 24"D x 51"W x 18"H, RIGHT HAND, NO GROMMET	\$2,709.00	\$8,127.00
5	5	HD6W3684D	MERCURY PRO WORKSURFACE WITH DEPTH ADJUSTMENT, 36"D x 84"W x 24-50"H, WITH CONTOUR EDGE, DUAL TIER ARRAY	\$7,203.00	\$36,015.00
6	2	HG6TS84G	MERCURY TECH BRIDGE, SINGLE SIDED 12" D X 18"H, FOR A 84"W CONSOLE, WITH GROMMET	\$847.88	\$1,695.75
7	3	HG6TS84N	MERCURY TECH BRIDGE, SINGLE SIDED 12" D X 18"H, FOR A 84"W CONSOLE, NO GROMMET	\$819.00	\$2,457.00
8	10	HGA	MERCURY ARRAY	\$1,895.25	\$18,952.50
9	2	HGBS1518S-L	MERCURY BRIDGE SPACER, 15"D x 18"H SINGLE, LEFT HAND	\$68.25	\$136.50
10	1	HGBS1518S-R	MERCURY BRIDGE SPACER, 15"D x 18"H SINGLE, RIGHT HAND	\$68.25	\$68.25
11	1	HGBS2418D-L	MERCURY BRIDGE SPACER, 24"D x 18"H DUAL, LEFT HAND	\$94.50	\$94.50
12	1	HGBS2418D-R	MERCURY BRIDGE SPACER, 24"D x 18"H DUAL, RIGHT HAND	\$94.50	\$94.50
13	1	HGBS2418S-L	MERCURY BRIDGE SPACER, 24"D x 18"H SINGLE, LEFT HAND	\$94.50	\$94.50
14	2	HGBS2418S-R	MERCURY BRIDGE SPACER, 24"D x 18"H SINGLE, RIGHT HAND	\$94.50	\$189.00
15	4	HGESDP5142ST	MERCURY END STACKER STORAGE, DOOR PAIR, 11.375"D X 51"W X 42"H, SINGLE WITH STORAGE	\$703.50	\$2,814.00
16	2	HGPSDOB244218L	MERCURY PERSONAL STACKER, DOOR OPEN BOX, 24"D x 42"W x 18"H, LEFT HAND	\$1,008.00	\$2,016.00
17	3	HGPSDOB244218R	MERCURY PERSONAL STACKER, DOOR OPEN BOX, 24"D x 42"W x 18"H, RIGHT HAND	\$1,008.00	\$3,024.00
18	4	HGSOCBKT42L	MERCURY OUTSIDE CORNER BRACKET, 42"H	\$36.75	\$147.00
19	4	HGSOCBKT42R	MERCURY OUTSIDE CORNER BRACKET, 42"H	\$36.75	\$147.00
20	3	HGSR3942F	MERCURY RETURN SCREEN, 39"W x 42"H, ALL FABRIC PANEL	\$598.50	\$1,795.50
21	1	HGSR5142F	MERCURY RETURN SCREEN, 51"W x 42"H, ALL FABRIC PANEL	\$619.50	\$619.50
22	1	HGSRE5142F	MERCURY RETURN SCREEN, SINGLE FABRIC PANEL, 51"W x 42"H	\$477.75	\$477.75
23	3	HGSRE5142F	MERCURY RETURN SCREEN, SINGLE FABRIC PANEL, 51"W x 42"H	\$477.75	\$1,433.25
24	5	HGSS8442F	MERCURY SPINE SCREEN, 84"W x 42"H, ALL FABRIC PANEL	\$939.75	\$4,698.75
25	2	HGTB244230L	MERCURY TECHNOLOGY BASE, 24"D x 42"W x 30"H, LEFT HAND	\$2,000.25	\$4,000.50
26	3	HGTB244230R	MERCURY TECHNOLOGY BASE, 24"D x 42"W x 30"H, RIGHT HAND	\$2,000.25	\$6,000.75
27	1	HGTD2SCR4242F	MERCURY TEAM DESK SPINE SCREEN, FABRIC , 42"W X 42"H, FOR A TEAM DESK, CENTER	\$514.50	\$514.50
28	1	HGTD2SRF8442	MERCURY TEAM DESK SURFACE, BULLET TOP FOR A TEAM DESK, 84"D x 42"W x 31.5"H, LEFT, CENTER, OR RIGHT	\$1,869.00	\$1,869.00
29	1	HGTD2BRDGSC42-C	MERCURY TEAM DESK SINGLE CABLE BRIDGE, FOR A 42W TEAM DESK, CENTER	\$627.38	\$627.38
30	1	HGTDLHUBP	MERCURY TEAM DESK LEFT HUB PRO, FOR A TEAM DESK	\$1,680.00	\$1,680.00
31	1	HGTDRHUBP	MERCURY TEAM DESK RIGHT HUB PRO, FOR A TEAM DESK	\$1,680.00	\$1,680.00
32	3	HHC1518	MERCURY HUB COVER, 15"D x 18"H	\$47.25	\$141.75
33	5	TXX4X6GROUND	MERCURY, GROUND BAR KIT 4" X 6"	\$126.00	\$630.00
34	5	TXXHGCHS	MERCURY SINGLE CUP HOLDER, 6.7"D X 4.5"W X 2.5"H	\$26.25	\$131.25

# Proposal 1

Project: Smyrna Police Dept - GA

## Sold to

Company name: City Of Smyrna - GA  
Contact Person: Rick James  
Contact Phone: 404-606-1477  
Contact Fax:

## Distributor

Company name: King Carter & Associates, Inc  
Salesperson: Ben Whitley  
Salesperson Phone: 7703107621  
Salesperson Fax:

**watson**

26246 Twelve Trees Lane NW Poulsbo, WA 98370  
360.394.1300 [watsonfurniture.com](http://watsonfurniture.com)

#	Qty	Part Number	Description	Sell	Ext. Sell
35	10	TXXHGMHSJ	MOTOROLA HEADSET JACK BRACKET, FOR LINEAR CONSOLES	\$36.75	\$367.50
36	10	TXXHGMSPK	MOTOROLA SPEAKER BRACKET	\$73.50	\$735.00
37	5	TXXTECHAUDIO25	TECH LINK, 3.5MM STEREO AUDIO JACK, BLACK, 25' CORD	\$31.50	\$157.50
38	5	TXXTECHUSB-CHRG	TECH LINK, DUAL USB A, BLACK	\$120.75	\$603.75
39	30	TXXTECHUSB15	TECH LINK, SINGLE USB A, DATA, BLACK, 15' CORD	\$36.75	\$1,102.50
40	5	TXXTECHUSBP-ACB	TECH LINK, USB A+C, CHARGER, BLACK	\$141.75	\$708.75
41	1	WAKEY-STD	MASTER KEY, STANDARD LOCK (082000)	\$31.50	\$31.50
42	1	WELCOMEPACKET	WATSON CONSOLES WELCOME PACKET	\$0.00	\$0.00
				<b>Total Consoles</b>	<b>\$118,458.38</b>

<b>Product Subtotal</b>	<b>\$118,458.38</b>
Watson Installation	\$18,182.00
Freight	\$7,670.00
<b>Total</b>	<b>\$144,310.38</b>
Sales Tax; Smyrna, GA (6 %)	\$8,658.62
<b>Grand Total</b>	<b>\$152,969.00</b>





Thank you for choosing CDW. We have received your quote.

Hardware   Software   Services   IT Solutions   Brands   Research Hub

## Review and Complete Purchase

DAT LUU,

Thank you for considering CDW•G for your technology needs. **If you are an eProcurement or single sign on customer, please log into your system to access the CDW site.** You can search for your quote to retrieve and transfer back into your system for processing.

Convert Quote to Order

QUOTE #	QUOTE DATE	QUOTE REFERENCE	CUSTOMER #	GRAND TOTAL
1CDZB6T	5/21/2024	ADDER FOR 911	2367291	\$3,517.55

QUOTE DETAILS				
ITEM	QTY	CDW#	UNIT PRICE	EXT. PRICE
<a href="#">Adder CCS-PRO4 - keyboard mouse USB audio switch - 4 ports</a>	5	3613553	\$703.51	\$3,517.55
Mfg. Part#: CCS-PRO4-US				
UNSPSC: 43211604				
Contract: Sourcwell 121923-CDWG Tech Catalog (121923)				

SUBTOTAL		\$3,517.55
SHIPPING		\$0.00
SALES TAX		\$0.00
GRAND TOTAL		\$3,517.55

PURCHASER BILLING INFO	DELIVER TO
<b>Billing Address:</b> CITY OF SMYRNA ACCOUNTS PAYABLE 2800 KING ST SE SMYRNA, GA 30080-3506 <b>Phone:</b> (770) 434-6600 <b>Payment Terms:</b>	<b>Shipping Address:</b> CITY OF SMYRNA ATTN:DAT LUU 3180 ATLANTA RD SE SMYRNA, GA 30080 <b>Phone:</b> (770) 434-6600 <b>Shipping Method:</b> DROP SHIP-GROUND
<b>Please remit payments to:</b>	
CDW Government 75 Remittance Drive Suite 1515 Chicago, IL 60675-1515	



### Sales Contact Info

Samir Patel | (877) 862-3950 | [samir.patel@cdwg.com](mailto:samir.patel@cdwg.com)

Need Help?		
My Account	Support	Call 800.800.4239

[About Us](#) | [Privacy Policy](#) | [Terms and Conditions](#)

This order is subject to CDW's Terms and Conditions of Sales and Service Projects at  
<http://www.cdwg.com/content/terms-conditions/product-sales.aspx>  
For more information, contact a CDW account manager

© 2024 CDW•G LLC, 200 N. Milwaukee Avenue, Vernon Hills, IL 60061 | 800.808.4239





## Quote Sheet

Quote Expires 06/05/2024

**Quote NO. / C1372716422**

Date Issued / 22 May 2024

Sales Person / Sales

Sales Person Email /  
sales@monoprice.com

Expires / 05 June 2024 01:01 PM

FOB / FOB Monoprice

**Issued To:**

Dat Luu

Ph: (678) 631-5527

dluu@smyrnaga.gov

Ship To: 30080-8256, US

**From:**

Monoprice Incorporated

1 Pointe Drive Suite 400

Brea, CA 92821

T: (877) 271-2592 F: (909) 989-0078

**Wire Banking Information:**

Beneficiary Name: Monoprice, Inc.

Bank Name: Bank of America

Account Number: 4850 0874 2493

ACH Routing No. 323070380

Wire Routing No. 026009593

SWIFT Code: BOFAUS3N (USD  
Transactions)

			TOTAL	\$1,068.33
ITEM	QTY		PRICE	AMOUNT
Monoprice 8 Outlet Mini Surge Protector 6ft Cord, 3420 Joules, Clamping Voltage 330V	10		\$18.49	\$184.90
Product #: 15872				
Weight: 16.05 lbs				
Monoprice Onyx Series Auxiliary 3.5mm TRS Audio Cable, 15ft	20		\$3.14	\$62.80
Product #: 24438				
Weight: 2 lbs				
			TOTAL	\$1,068.33

**\* Tax is not included in the above subtotal.****Estimated Tax, Promotional Pricing, and Inventory are not guaranteed and are subject to change.**

TOTAL \$1,068.33

ITEM	QTY	PRICE	AMOUNT
<b>Monoprice USB 2.0 USB-A to USB-A Cable - 28/24AWG Gold Plated Black 6ft</b> Product #: 5443 Weight: 1.5 lbs	10	\$1.59	<b>\$15.90</b>
<b>Monoprice USB-A to USB-B 2.0 Cable - Active, 28/24AWG, Black, 33ft</b> Product #: 7531 Weight: 16.4 lbs	20	\$9.69	<b>\$193.80</b>
<b>Monoprice Mini DisplayPort 1.2a / Thunderbolt to 4K HDMI Passive Adapter, Black</b> Product #: 12795 Weight: 1.4 lbs	20	\$8.99	<b>\$179.80</b>
<b>Monoprice 4K High Speed HDMI Cable - 4K@60Hz, 18Gbps, HDR, CL2 In-Wall Rated, No Logo, 6ft, Black</b> Product #: 13779 Weight: 3.4 lbs	20	\$5.29	<b>\$105.80</b>
<b>Monoprice Select Series DisplayPort 1.2 Cable, 25ft</b> Product #: 13363 Weight: 20.8 lbs	20	\$15.46	<b>\$309.20</b>

Subtotal: \$1,052.20  
Standard: 3-5 Business Days: \$16.13

TOTAL \$1,068.33

\* Tax is not included in the above subtotal.

Estimated Tax, Promotional Pricing, and Inventory are not guaranteed and are subject to change.



May 10, 2024

Dat Luu  
City of Smyrna

**RE: 24002548 – City of Smyrna – 911 Center New Desk & Cable Install**

Thank you for the opportunity to provide a proposal for this project. With over 30 years of experience in the industry, NetPlanner Systems, Inc. has a long history of successfully completing projects of this scope and magnitude.

As one of the Southeast's leading providers of IT-based solutions, NetPlanner Systems, Inc. has established a reputation for completing projects on time and within budget. We dedicate our efforts to staying on top of the ever-changing world of communications technology to consistently deliver innovative, high performing systems. Our goal is to provide you with the highest quality products and a level of customer service that exceeds your expectations.

Please do not hesitate to contact me if you have any questions about this proposal. Again, thank you for this opportunity. We look forward to working with you.

Please find our pricing to provide and install the following system:

- Structured Cabling

## **SCOPE OF WORK**

Provide and install the following to 5 desks with Smyrna's 911 Center.

- (3) Different color Cat6 cables terminated in a surface mount box at the desk.
- (1) Cat6A Shielded cable to be terminated in a surface mount box for the Motorola Radio System.
- Provide and install patch panels for Cat6 and Cat6A cables within the MDF.
- Dress in all cabling within the desk from the PC's, displays, and peripheral equipment.
- Provide all testing, labeling, as-built, and support documentation as required per scope of work.

Atlanta, GA • Augusta, GA • Columbus, GA • Savannah, GA • Raleigh, NC • Tampa, FL

### **Corporate Headquarters:**

3145 Northwoods Parkway, Suite 800 • Peachtree Corners, GA 30071  
Office: (770) 662-5482 • Fax: (770) 441-3773 • Toll-Free: (800) 795-1975

[www.netplanner.com](http://www.netplanner.com)



---

**EXCLUSIONS**

- All conduit, junction boxes, surface mount raceways, pull-strings, outside duct bank, and manholes/handholes are not included in this proposal.
- Floor Cores and floor penetrations are not included in this proposal.
- Active Network electronics, power strips, and UPS's are not included in this proposal.

---

**PROJECT PRICING**

**Structured Cabling Price:**

**\$ 12,865.32**

*Our industry is currently experiencing extreme lead times and limited product availability due to global supply chain issues. This is causing substantial fluctuations in pricing.*

*Although this quote is valid for 30 days, due to market volatility, it is subject to be adjusted during this time for any reason outside of NetPlanner Systems' control. Should a manufacturer's price increase affect this quote, NetPlanner will notify Customer in writing prior to executing a contract.*

*Should a product substitution need to be considered due to extended lead times or pricing concerns, NetPlanner will notify Customer in writing, and a change order will be issued, if applicable. NetPlanner Systems will not be responsible for liquidated damages that result due to product delays outside of NetPlanner's control.*

---

Atlanta, GA • Augusta, GA • Columbus, GA • Savannah, GA • Raleigh, NC • Tampa, FL

---

**Corporate Headquarters:**

3145 Northwoods Parkway, Suite 800 • Peachtree Corners, GA 30071  
Office: (770) 662-5482 • Fax: (770) 441-3773 • Toll-Free: (800) 795-1975

[www.netplanner.com](http://www.netplanner.com)

### PAYMENTS

NetPlanner Systems, Inc. will invoice Customer for all materials and for mobilization upon approval of proposal. Customer will be invoiced for labor at the end of the project or at the end of the month, whichever comes first, based upon the percentage of the project completed. The Customer agrees to pay any and all payments according to the payment schedule. Should said payment(s) not be made, or if satisfactory arrangements for payment have not been made, NetPlanner Systems, Inc. reserves the right to stop all work until such time as payment is rendered or satisfactory payment arrangements have been made. Standard payment terms are NET 30.

Any required closeout documents, including, but not limited to, as-built drawings, test results, and warranties, will be released to the Customer once 90% of the total project payment has been received by NetPlanner Systems, Inc.

### INCLUSIONS

Pricing includes above described items by NetPlanner Systems, Inc. and applies to regular business hours unless otherwise stated, Monday - Friday 7:30 AM - 4:30 PM.

This bid proposal and the pricing within are valid for 30 days.

### EXCLUSIONS

Overtime labor is not included in this proposal.

### CHANGE ORDERS

Changes to the Scope of Work, delays due to site closings, limited access, or other events which the Customer requests will be handled as part of a Change Order. Customer should contact NetPlanner Systems' Project Manager with any requested changes, modifications, or enhancements to the project. NetPlanner Systems' Project Manager will prepare a Change Order which will address scope functionality changes, detail cost implications, and reflect any necessary equipment changes. The Project Manager must receive the signed Change Order before NetPlanner Systems will proceed with any ordering or changes in the project.

Additional labor resulting from a Change Order will be estimated at the time of request. If overtime or weekend work is required, the labor rate will be subject to a 1.5 multiplier. If holiday work is required, the labor rate will be subject to a 2.0 multiplier. The cost of additional materials and labor will be presented for Customer approval prior to commencing work on the Change Order. Additional charges for the changes will be added to the contract price and billed with the next scheduled contract payment.

The completion date shall be adjusted according to the change(s) mentioned above, and the original completion date shall become null and void. Agreements made by the Customer with other vendors or subcontractors on the job are not recognized.

---

Atlanta, GA • Augusta, GA • Columbus, GA • Savannah, GA • Raleigh, NC • Tampa, FL

---

#### Corporate Headquarters:

3145 Northwoods Parkway, Suite 800 • Peachtree Corners, GA 30071  
Office: (770) 662-5482 • Fax: (770) 441-3773 • Toll-Free: (800) 795-1975

[www.netplanner.com](http://www.netplanner.com)



---

### CUSTOMER-SUPPLIED ITEMS

All materials supplied by the Customer are to be on-site by the specified date in the contract. It is the responsibility of the Customer to ensure that customer-supplied items are in proper working condition for installation and that all necessary parts to install such items are present. The Customer bears all responsibility pertaining to the condition, performance, and warranties of customer-supplied items. NetPlanner Systems, Inc. shall install customer-supplied items "as is" and shall bear no responsibility, either explicit or implied, for the item or for its condition, performance, or warranty.

### CUSTOMER RESPONSIBILITIES

To ensure that your project goes smoothly please implement the following:

- A. Designate one person to be the Customer's point of contact. This person shall be kept informed of the job's progress and shall be provided answers to questions as they arise.
- B. Direct all questions to NetPlanner Systems, Inc.'s designated point of contact. Avoid trying to resolve questions or problems with workers, vendors, or other individuals on or off the job site.
- C. Make any and all changes to the original contract in writing and ensure that a "Change Order" form is completed and signed before those changes are made.
- D. NetPlanner Systems, Inc. shall in no way be held responsible for making the proposed system fully operational in the event that the Customer fails to disclose in explicit written terms the features required of the system and where lack of doing so is the cause for such failure to become operational. If such omissions by any third party or the Customer cause the system to be incomplete and unable to function as expected, it is up to the Customer to provide financial resources to correct such omissions.

### QUALITY

All work shall be performed in a good and workmanlike manner per industry standards. All material is guaranteed to be new, unless otherwise specified.

### SAFETY

NetPlanner Systems, Inc. shall take all necessary precautions for the safety of persons and the protection of the work and adjoining property. NetPlanner Systems, Inc. shall comply with all applicable provisions of federal, state, and local safety laws and building codes including, without limitation, the provisions of 29 CFR 1910.147 (OSHA Lockout/Tagout Standard).

### INDEPENDENT CONTRACTORS

The relationship of the Customer and NetPlanner Systems, Inc. created by this agreement shall be that of independent contractors and not one of joint venture, partnership, or employment. During the term of this Agreement and for a period of two (2) years following the date of the termination or expiration of this Agreement

#### Corporate Headquarters:

3145 Northwoods Parkway, Suite 800 • Peachtree Corners, GA 30071  
Office: (770) 662-5482 • Fax: (770) 441-3773 • Toll-Free: (800) 795-1975



(or the date of any subsequent termination of the parties' relationship, whichever is later), Customer covenants and agrees that Customer shall not, directly or indirectly: (i) solicit, recruit, or hire (or attempt to solicit, recruit, or hire) or otherwise assist anyone in soliciting, recruiting, or hiring, any employee of NetPlanner Systems, Inc. who performed work for NetPlanner Systems, Inc. within the last year of Customer's relationship with NetPlanner Systems, Inc. or who was otherwise engaged or employed with NetPlanner Systems, Inc. at the time of termination or expiration of this Agreement and the parties' relationship or (ii) otherwise encourage, solicit, or support any such employee(s) to leave their employment with NetPlanner Systems, Inc., until such employee's employment with NetPlanner Systems, Inc. has been voluntarily or involuntarily terminated or separated for at least six (6) months. In the event the Customer hires a NetPlanner Systems, Inc. employee, the Customer agrees to compensate NetPlanner Systems, Inc. an amount equal to the employee's minimum annual salary.

### **DAVIS BACON ACT**

NetPlanner Systems, Inc. is compliant with all State, Federal and local labor and employee relations laws including Davis Bacon and Davis Bacon Related Act regulations and guidelines. Based upon Federal guidelines, it is the contracting agency's and/or contractor's responsibility to (a) notify bidders when a project falls under the Davis Bacon Act and/or Davis Bacon Related Act guidelines, and (b) provide the Prevailing Wage Determination attached to the contract. NetPlanner Systems, Inc. bids its labor based upon criteria and requirements outlined within the RFP; as such, we will not take into consideration Davis Bacon Act/DBRA wage requirements if it has not been designated within the RFP/bid documents as a requirement. If a contract is awarded and later determined to be a Davis Bacon/Davis Bacon Related Act project, NetPlanner Systems, Inc. will issue a change order for the additional labor costs and/or have the right to cancel the contract based upon the contractor's failure to properly notify bidders of the Prevailing Wage requirements. In some instances, the Prevailing Wage Determination provided within an RFP/bid package does not include an employee classification matching the specialized skills required of our employees. Under these circumstances, our quote is based upon the prevailing wage rates for our classification, in the project's specific geographic location. In addition, should the contract be awarded to our company, we would need to submit an SF1444 requesting a wage conformance to include a worker classification for Telecommunications / Voice / Data / Video technicians.

### **BUILDING CODES**

All work performed under this agreement shall comply with applicable building codes. Any additional work required by the Building Department beyond the agreement of this contract is not the responsibility of NetPlanner Systems, Inc.

### **ASBESTOS AND OTHER HAZARDOUS MATERIALS**

It is the obligation of the Customer to determine if the structure covered by this contract contains asbestos and/or other hazardous materials. This proposal and contract does not include any provision (neither monetary provisions nor time-schedule provisions) to cover the unforeseen hazards or additional work necessitated by removal of asbestos and/or other hazardous materials. If asbestos and/or other hazardous materials are discovered after work is already in progress, and if the asbestos and/or other hazardous materials represent a

---

Atlanta, GA • Augusta, GA • Columbus, GA • Savannah, GA • Raleigh, NC • Tampa, FL

---

#### **Corporate Headquarters:**

3145 Northwoods Parkway, Suite 800 • Peachtree Corners, GA 30071  
Office: (770) 662-5482 • Fax: (770) 441-3773 • Toll-Free: (800) 795-1975

[www.netplanner.com](http://www.netplanner.com)



changed condition from those described in the plans and specifications, then NetPlanner Systems, Inc. shall be entitled to additional compensation and an increase in time for completion of the project.

### EXISTING CONDITIONS

NetPlanner Systems, Inc. makes no representation of existing conditions and assumes no responsibility of condition for any of the Customer's equipment that may or may not be relocated or affected by NetPlanner Systems, Inc.'s work.

### HIDDEN DEFECTS

It is acknowledged that hidden defects, faulty wiring, or other defective components of existing systems may need to be updated or replaced in order to properly complete the above-quoted work, and further acknowledged that the expense, if any, will be the responsibility of the Customer.

### PATHWAYS

All conduits installed by others are assumed to be passable. NetPlanner Systems, Inc. is not responsible for repairing or replacing pathways installed by others.

Any conduits routing below foundation grade must be identified by the Customer so that NetPlanner Systems, Inc. can properly specify outdoor rated cable. Failure to identify such conduits will result in cable being replaced at additional cost to Customer. Indoor cable routing below foundation grade will not be warranted by NetPlanner Systems, Inc.

### WARRANTY

NetPlanner Systems, Inc. hereby guarantees that the work shall be free from defects in labor for one (1) year from the date of completion of the project. NetPlanner Systems, Inc.'s liability for breach of warranty or failure or defect in performance of the Contract shall be limited to re-performing corrective services of the type originally performed by NetPlanner Systems, Inc. with its own forces, beginning at final completion and continuing for twelve (12) months thereafter, provided NetPlanner Systems, Inc. receives written notice of defective work within the warranty period. Materials and active hardware are warranted as specified by individual manufacturers and not by NetPlanner Systems, Inc.

NetPlanner Systems, Inc. will exchange any defective equipment at no labor cost for a period of 30 days. After 30 days, the Customer is responsible for exchanging defective equipment. NetPlanner Systems, Inc. can install exchanged equipment on a time and materials basis. NetPlanner Systems, Inc. reserves the right to repair or replace defective items and will not compensate others for repair or replacement services.

---

Atlanta, GA • Augusta, GA • Columbus, GA • Savannah, GA • Raleigh, NC • Tampa, FL

---

#### Corporate Headquarters:

3145 Northwoods Parkway, Suite 800 • Peachtree Corners, GA 30071  
Office: (770) 662-5482 • Fax: (770) 441-3773 • Toll-Free: (800) 795-1975

[www.netplanner.com](http://www.netplanner.com)





---

**LIMITATION OF LIABILITY**

**Disclaimer of Certain Damages**

NEITHER SERVICE PROVIDER NOR CUSTOMER SHALL BE LIABLE TO THE OTHER FOR ANY INDIRECT, CONSEQUENTIAL, EXEMPLARY, SPECIAL, INCIDENTAL OR PUNITIVE DAMAGES, INCLUDING LOSS OF USE OR LOST BUSINESS, REVENUE, PROFITS, OR GOODWILL, ARISING IN CONNECTION WITH THIS CUSTOMER PURCHASE AGREEMENT, EVEN IF THE PARTY KNEW OR SHOULD HAVE KNOWN OF THE POSSIBILITY OF SUCH DAMAGES.

**Cap on Liability**

IN NO EVENT SHALL EITHER PARTY'S AGGREGATE LIABILITY UNDER THIS CUSTOMER PURCHASE AGREEMENT EXCEED THE AMOUNT OF THE CHARGES PAID OR PAYABLE BY SERVICE PROVIDER DURING THE TWENTY FOUR (24) MONTHS BEFORE THE EVENT GIVING RISE TO SUCH LIABILITY; PROVIDED THAT IF THE EVENT GIVING RISE TO LIABILITY OCCURS DURING THE FIRST TWENTY FOUR (24) MONTHS AFTER THE EFFECTIVE DATE OF THIS CUSTOMER PURCHASE AGREEMENT, THE AMOUNT SHALL BE CALCULATED AS THE AMOUNT ANTICIPATED TO BE PAID BY SERVICE PROVIDER DURING THE FIRST TWENTY FOUR (24) MONTHS AFTER THE EFFECTIVE DATE OF THIS CUSTOMER PURCHASE AGREEMENT, OR TWENTY FOUR (24) TIMES THE AVERAGE MONTHLY CHARGES THUS FAR, WHICHEVER IS MORE.

**Exclusions and Stipulations**

THE PROVISIONS ABOVE IN THIS LIMITATION OF LIABILITY SECTION SHALL NOT APPLY TO: (A) LOSSES ARISING OUT OF GROSS NEGLIGENCE OR WILLFUL OR INTENTIONAL MISCONDUCT; (B) LOSSES ARISING FROM A PARTY'S BREACH OF SECTION 5 OF THE MSA (CONFIDENTIAL INFORMATION); OR (C) LOSSES ARISING OUT OF SERVICE PROVIDER'S OBLIGATIONS TO INDEMNIFY ANY INDEMNITEE. FURTHER, THE TO THE EXTENT THAT A CUSTOMER PURCHASE AGREEMENT CONTAINS REIMBURSEMENT OR INDEMNIFICATION OBLIGATIONS RELATED TO A SERVICE PROVIDER'S BREACH OF ITS DATA SECURITY OR DATA PRIVACY OBLIGATIONS, SUCH REIMBURSEMENTS SHALL BE DEEMED TO BE DIRECT DAMAGES AND NOT ANY OF THE TYPES OF DAMAGES DESCRIBED UNDER LIMITATION OF LIABILITY ABOVE AND SHALL NOT BE GOVERNED BY THE LIABILITY CAP IN THIS SECTION ABOVE.

---

Atlanta, GA • Augusta, GA • Columbus, GA • Savannah, GA • Raleigh, NC • Tampa, FL

---

**Corporate Headquarters:**

3145 Northwoods Parkway, Suite 800 • Peachtree Corners, GA 30071  
Office: (770) 662-5482 • Fax: (770) 441-3773 • Toll-Free: (800) 795-1975

[www.netplanner.com](http://www.netplanner.com)

**ACCEPTANCE**

NetPlanner Systems, Inc. is hereby authorized to perform the work as specified. Payment shall be made as outlined above. Customer agrees this proposal constitutes in its entirety all that will be provided by NetPlanner Systems, Inc.

**Customer**

Authorized Signature:

\_\_\_\_\_

Printed Name: \_\_\_\_\_

Title: \_\_\_\_\_

Date: \_\_\_\_\_

**NetPlanner Systems, Inc.**

Authorized Signature:

\_\_\_\_\_

Printed Name: \_\_\_\_\_

Title: \_\_\_\_\_

Date: \_\_\_\_\_

Atlanta, GA • Augusta, GA • Columbus, GA • Savannah, GA • Raleigh, NC • Tampa, FL

**Corporate Headquarters:**

3145 Northwoods Parkway, Suite 800 • Peachtree Corners, GA 30071  
Office: (770) 662-5482 • Fax: (770) 441-3773 • Toll-Free: (800) 795-1975

[www.netplanner.com](http://www.netplanner.com)

**Southern Computer Warehouse**

1395 S. Marietta Parkway  
Building 300  
Marietta, Georgia 30067  
United States  
<http://www.scw.com>  
(P) 877-GOTOSCW  
(F) 770.579.8937

**Saved Cart (Open)****Date**

Apr 22, 2024 01:07 PM EDT

**Modified Date**

May 22, 2024 04:03 PM EDT

**Quote #**

Cart

**Description****SalesRep**

Shrader, Jamison  
(P) 770-579-8927  
(F) 770-579-8937

**Customer Contact**

Luu, Dat  
(P) 678-631-5527  
[dluu@smynaga.gov](mailto:dluu@smynaga.gov)

**Customer**

City of Smyrna GA (SC2047)  
Luu, Dat  
P O Box 1226  
2800 King St.  
Smyrna, GA 30081  
United States  
(P) 770-319-2523  
(F) 770-319-2523

**Bill To**

City of Smyrna GA  
Payable, Accounts  
2800 King Street  
Smyrna, GA 30080  
United States

**Ship To**

City of Smyrna  
REF, PO  
3180 Atlanta Rd  
Dan Campbell  
Smyrna, GA 30080  
United States  
(P) 678-631-5528  
(F) 678-631-5522  
[dcampbell@smynaga.gov](mailto:dcampbell@smynaga.gov)

<b>Customer PO:</b>	<b>Terms:</b> Undefined	<b>Ship Via:</b> GROUND
<b>Special Instructions:</b>	<b>Carrier Account #:</b>	

#	Description	Part #	Qty	Unit Price	Total
1	Logitech - Logitech Z150 Speakers - for PC - black	980-000802	5	\$22.63	\$113.15

**Subtotal: \$113.15**  
Tax (.0000%): \$0.00  
Shipping: \$0.00  
**Total: \$113.15**

Quote valid for 30 days unless formal bid provides different term. Promotional pricing is valid only during term of promotion and while supplies last. All returns must be authorized and clearly marked with a valid RMA number. RMA's are subject to restock fees when applicable.

**Disclaimer**

These prices may not include applicable taxes, insurance, shipping, delivery, setup fees, or any cables or cabling services or material unless specifically listed above. Please note that expedited shipping charges are estimated, and could decrease or increase when invoiced. All prices are subject to change without notice. Supply subject to availability.

