

**SIGN-24-79****Sign Permit**

Status: Active

Submitted On: 3/28/2024

Primary Location2410 S COBB DR SE
SMYRNA, GA 30082**Owner**3076 RESTAURANT CORP
GLENMORE LN 2199
SNELLVILLE, GA 30078**Applicant**

Michael Fitzgerald



678-571-8889



fitzgeraldland@gmail.com



3162 Johnson Ferry Rd, Ste

260-441

Marietta, GA 30062

Internal Only

Additional Comments/Notes**Work without Permit ?**

—

Non-conforming Sign

—

Type of Sign Permit

Sign Type*

Monument

Is this an illuminated sign?*

Yes

Is the sign internally or externally illuminated?*

External

Monument Sign Permit Information

Type of Sign* ?

Freestanding (General)

Sign Area (sq. ft.)*

661

Height of Sign* ?

50

Number of Sign Faces*

2

Construction Cost of Sign (\$)*

75000

Will sign have electronic messaging?*

Yes

Brief Description of Work*

Install Freestanding Off-Premise Advertising Sign with LED Digital Faces

Property Owner Information

Full Name (i.e., First and Last Name, or Name of Entity):*

Michael B Fitzgerald, Manager Atlantic Billboards, LLC

Street Address*

3162 Johnson Ferry Rd #260-441

City*

Marietta

State*

GA

Zip Code*

30062

Phone Number

678-571-8889

Email

mike@atlanticbillboards.com

Registered Engineer

Name*

Alexander Ginn

Business Name*

Ginn Engineering Services

Business License Number* ?

OC45301

State License Number*

PE045301

Sign Contractor

Business Name*

Bowen Auger Service, Inc.

Contact Person*

Alishia Bragg

Street Address*

PO Box 178

City*

Adairsville

State*

GA

Zip Code*

30103

Phone Number*

770-386-9724

Email Address*

bowenauger@aol.com

Business License Number* ?

H014

License Expiration Date*

01/01/2025

Insurance Policy Expiration Date*

07/14/2024

Electrical Contractor Information

Business Name*

Paragon Electric, LLC

Contact Person*

John Blue

Street Address*

137 Siena Dr

City*

Cartersville

State*

GA

Zip Code*

30120

Phone Number*

404-409-6597

Email Address*

paragonelectric@gmail.com

GA Contractor License Number*

EN211757

GA Contractor License Expiration Date*

06/30/2024

Certification

Owner and/or agent hereby agrees that he or she will comply with all requirements of the City of Smyrna's Sign Ordinance currently in effect. Also, that the sign will not be located within the street right-of-way or block the view of any intersection.

Applicant Signature*

☒ Michael B Fitzgerald
Mar 28, 2024

I have read and understand Chapter 82 of the City's Code of Ordinances and I agree to comply with its regulations.







Applicant Signature*

✓ Michael B Fitzgerald
Mar 28, 2024



Acknowledgement**Applicant Signature***

✓ Michael B Fitzgerald
Mar 28, 2024

Attachments

- **2401 S Cobb Dr.pdf**
2401 S Cobb Dr.pdf
Uploaded by Michael Fitzgerald on Mar 28, 2024 at 3:50 PM
- **Formetco 14 x 48 package.pdf**
Formetco 14 x 48 package.pdf
Uploaded by Michael Fitzgerald on Mar 28, 2024 at 3:50 PM
- **Addendum to Sign Permit Application non rail.pdf**
Addendum to Sign Permit Application non rail.pdf
Uploaded by Michael Fitzgerald on Mar 28, 2024 at 3:50 PM
- **FORMAL RESPONSE_SIGN-24-79_LETTER.pdf**
FORMAL RESPONSE_SIGN-24-79_LETTER.pdf
Uploaded by Joey Staubes on May 6, 2024 at 10:39 AM
- **Property Owner Authorization**
2401 S Cobb Signed.pdf
Uploaded by Michael Fitzgerald on Mar 28, 2024 at 3:49 PM
- **Sign Contractor Proof of Insurance**
ACORD Form 20240213-100115.pdf
Uploaded by Michael Fitzgerald on Mar 28, 2024 at 3:49 PM

REQUIRED**REQUIRED**

	Sign Contractor Business License Contractor Biz License.pdf Uploaded by Michael Fitzgerald on Mar 28, 2024 at 3:49 PM	REQUIRED
	Dimensioned Sign Rendering 3 AG-074 14x48 FF 15'V 50'T LED Smyrna GA 110_STAMPED Letter.pdf Uploaded by Michael Fitzgerald on Mar 28, 2024 at 3:49 PM	REQUIRED
	Engineering Plan 3 AG-074 14x48 FF 15'V 50'T LED Smyrna GA 110_STAMPED Letter.pdf Uploaded by Michael Fitzgerald on Mar 28, 2024 at 3:49 PM	REQUIRED

History

Date	Activity
5/6/2024, 10:39:05 AM	Joey Staubes altered approval step Review of Sign Permit Application , changed status from Active to On Hold on Record SIGN-24-79
3/28/2024, 4:02:43 PM	approval step Review of Sign Permit Application was assigned to Joey Staubes on Record SIGN-24-79
3/28/2024, 4:02:43 PM	Michael Fitzgerald submitted Record SIGN-24-79
3/28/2024, 2:39:01 PM	Michael Fitzgerald altered Record SIGN-24-79, changed ownerEmail from "" to "shehzaan@chunaragroup.com"
3/28/2024, 2:39:01 PM	Michael Fitzgerald altered Record SIGN-24-79, changed ownerPhoneNo from "" to "404-936-4621"
3/28/2024, 2:39:01 PM	Michael Fitzgerald altered Record SIGN-24-79, changed ownerStreetName from "2199 GLENMORE LN" to "GLENMORE LN"
3/28/2024, 2:39:01 PM	Michael Fitzgerald altered Record SIGN-24-79, changed ownerStreetNo from "" to "2199"
3/28/2024, 2:37:31 PM	Michael Fitzgerald started a draft of Record SIGN-24-79

Timeline

Label	Activated	Completed	Assignee	Due Date	Status
✓ Review of Sign Permit Application	3/28/2024, 4:02:43 PM	-	Joey Staubes	-	On Hold
💰 Payment of Permit Fees	-	-	Michael Fitzgerald	-	Inactive
📄 Issuance of Sign Permit	-	-	-	-	Inactive
📋 Building Inspection-Sign- Electrical	-	-	-	-	Inactive
📋 Building Inspection-Sign- Footing	-	-	-	-	Inactive
📋 Building Inspection-Sign- Final	-	-	-	-	Inactive
✓ Completion of Permit	-	-	-	-	Inactive



City of Smyrna, GA

Jul 12, 2024

SIGN-24-79

Review of Sign Permit Application

Sign Permit

Status: On Hold**Became Active:** Mar 28, 2024**Assignee:** Joey Staubes**Completed:** May 6, 2024

Applicant

Michael Fitzgerald
fitzgeraldland@gmail.com
3162 Johnson Ferry Rd, Ste 260-441
Marietta, GA 30062
678-571-8889

Primary Location

2410 S COBB DR SE
SMYRNA, GA 30082

Owner:

3076 RESTAURANT CORP
2199 GLENMORE LN SNELLVILLE, GA 30078

Comments

Joey Staubes , May 6, 2024

This sign permit is denied based on the non-compliance with the regulations established in Chapter 82, Section 15 of the Smyrna Code of Ordinances. The proposed sign exceeds both the maximum area (32 square feet) and maximum height (8 feet) specified by the ordinance, is not a ground based monument sign as required by the ordinance and is a pole sign as prohibited by the ordinance.

A formal response is attached.

...at least 100 feet from any intersection, over 10 feet from the edge of the road if no intersection exists, and over 25 feet from any point where right-of-way lines intersect for two streets or roads. No reduction in parking.



Diagram of Proposed Sign

Size of Subject Parcel: 0.55 +/- Acres

Project Address
2401 S Cobb Dr
Smyrna, Georgia

Project Contact
Mike Fitzgerald
(678) 571-8889
Mike@AtlanticBillboards.com

ATLANTIC

STANDARD CONFIGURATION

DESIGN PARAMETERS PER REQUIREMENTS OF
IBC 2009/IBC 2001/ASCE 7-16, 17/5 mph

MAXIMUM UPRIGHT SPACING: 8'-4 1/8" (2560mm)
ALLOWABLE CANTILEVER: 4'-2 3/8" (1280mm) MAX
CONTINUOUS 4"x4"x3/8" S/A LEDGER OR EQUIVALENT

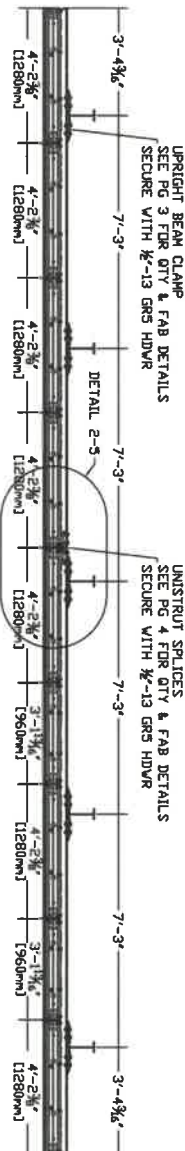

- ## ON-SITE SERVICE REQUIREMENTS
- 1) THE DISPLAY MUST BE ACCESSIBLE THROUGH USE OF A 20 FOOT OR SHORTER LADDER.
 - 2) THERE MUST BE A SECURE CATWALK OR BASE FROM WHICH SERVICE MAY BE PERFORMED.
 - 3) ALL REAR SERVICED DIGITALS REQUIRE CATWALK SPACED AT NO GREATER THAN 7'-6" IN HEIGHT. THERE MUST BE A GUARD RAIL OR A SAFETY LIFELINE SECURELY ANCHORED TO THE SUPPORT STRUCTURE OF THE DISPLAYS AT 6 FEET OFF THE GROUND COLLECTIVELY AN ACCESSIBLE SITE? IN THE ABSENCE OF AN ACCESSIBLE SITE, THE CUSTOMER IS RESPONSIBLE FOR THE COST OF A BUCKET OR BOOM TRUCK CAPABLE OF PROVIDING SAFE ACCESS TO THE DISPLAY. SERVICE WILL BE PERFORMED ONLY IF THERE IS SAFE ON-SITE ACCESS IN COMPLIANCE WITH APPLICABLE FEDERAL AND LOCAL LAWS AND REGULATIONS.

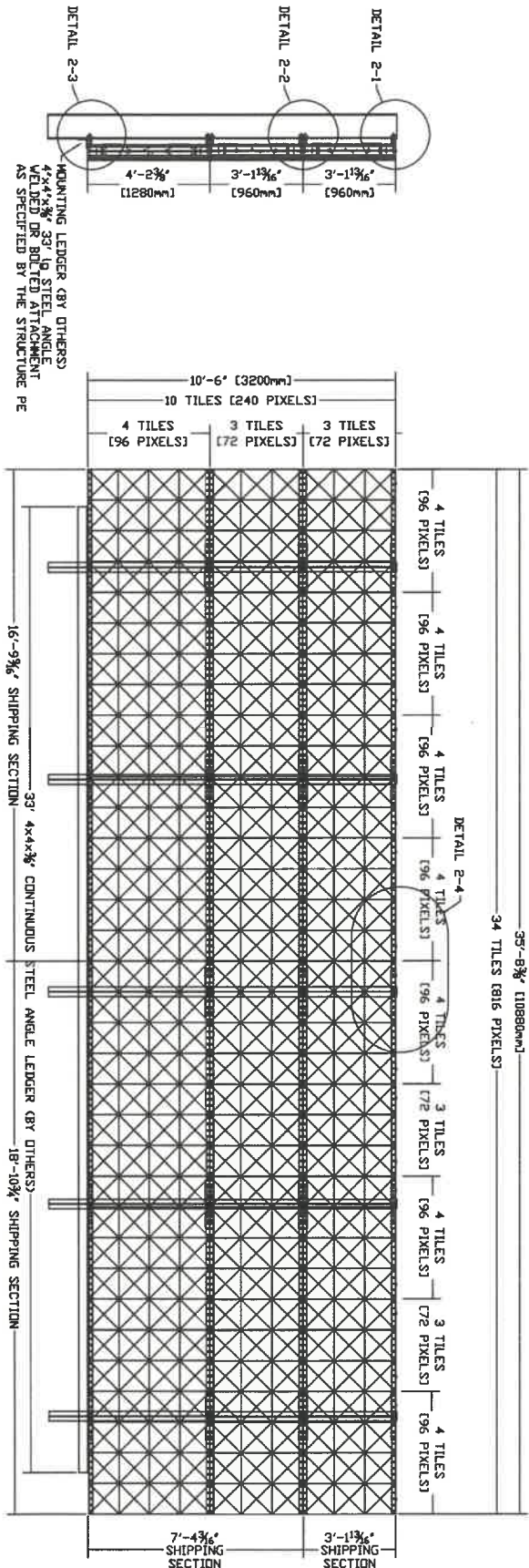

PRODUCTION NOTES:
1) CABINET POWER PRE-WIRED BY COLUMN
2) TRIM COLOR - AS REQ'D
3) USE 1/2"-13 GR5 SERATED FLANGE BOLTS
AND NUTS UNLESS OTHERWISE NOTED
4) ALL FABRICATED ALUMINUM AND STEEL PARTS
TO BE PAINTED SATIN BLACK.

APPROXIMATE 13.3mm, 16mm, 20mm SIGN WEIGHT - NO TRIM

QUANTITY	10mm	13.3mm	16mm	20mm
ALUMINUM STRUT AND BRACKETS.	759#	759#	759#	759#
ELECTRIC SYSTEM.	150#	150#	150#	150#
1" TIE LED MODULES.	3,935#	3,749#	3,749#	3,749#
TRIM - 3" ANGLE.	0#	0#	0#	0#
TOTAL	4,944#	4,658#	4,658#	4,658#

A		MISC. UPDATES AND CORRECTIONS		6-29-21	RFV
REV		DESCRIPTION		DATE	APPD
THIS MATERIAL IS THE EXCLUSIVE CONFIDENTIAL PROPERTY OF FORMETCO, INC. ALL RIGHTS, INCLUDING COPYRIGHT AND PATENT RIGHTS, ARE RESERVED BY FORMETCO, INC.					

PART NUMBER		2963 Pleasant Hill Rd. Duluth, GA 30096-38	
FTX-A DBB		13.3mm 240 x 816 DBB U-STRUT MT	
APPROVALS		10'-6" x 35'-8" 13.3mm FTX-A DBB	
DATE	08-23	DATE	08-23
REVISION	8-22-21	DATE	08-23

SEE B-2830 FOR POWER RISER AND DATA LAYOUT

ALL CONFIGURATIONS

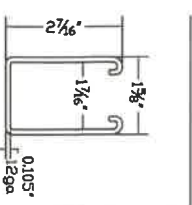
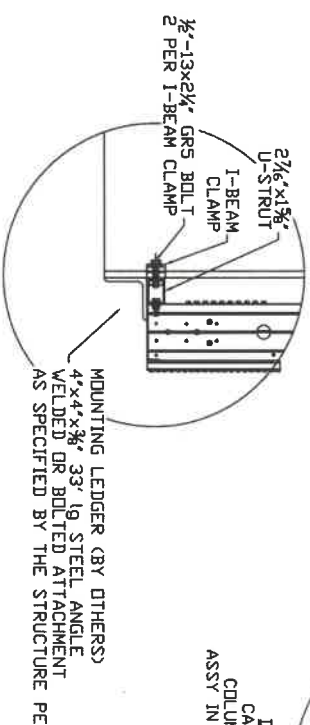
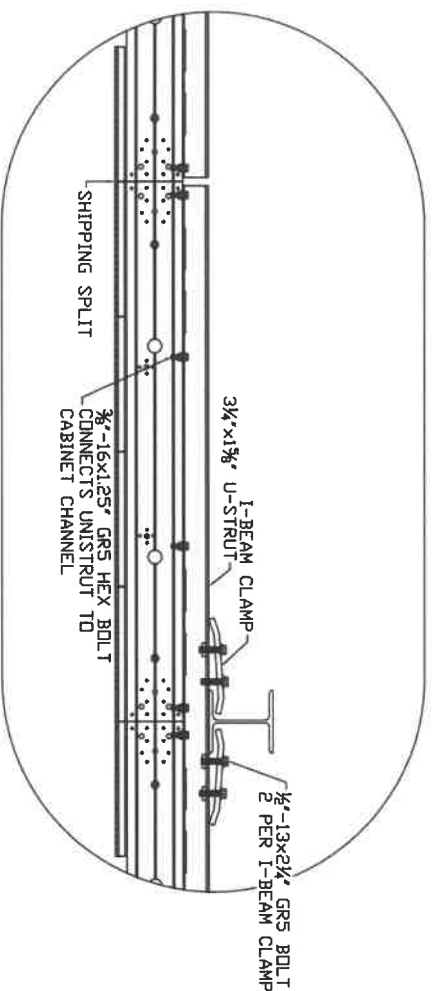
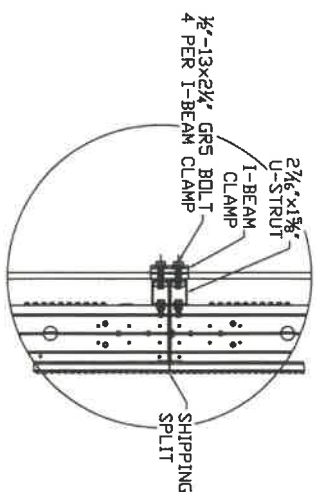
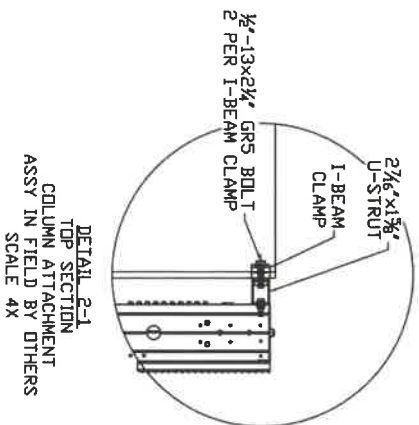
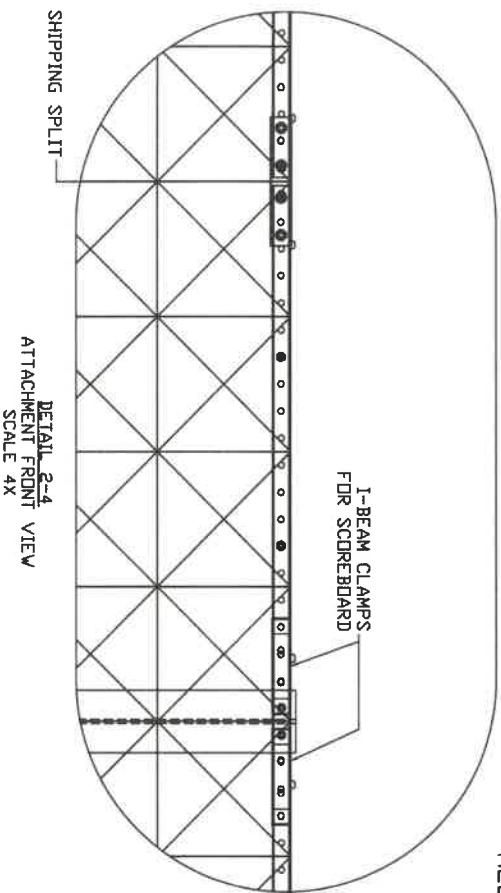

1 3/8 x 2 1/4 U-STRUT
12ga GALVANIZED
STRUT F-350 OR EQUIV
UNT 70 KSI

PART NUMBER			
FTX-A DBB			
APPENDIX 5			
2963 Pleasant Hill Rd. Duluth, GA 30096-38			
U-STRUT UPRIGHT CONNECTION DETAIL			
10'-6" x 35'-8" 13.3mm FTX-A DBB			
REV	DESCRIPTION	DATE	APPD
A	MISC. UPDATES AND CORRECTIONS	6-29-21	RFV
REVISIONS			
THIS MATERIAL IS THE EXCLUSIVE CONFIDENTIAL PROPERTY OF FORMETCO, INC.			
ALL RIGHTS, INCLUDING COPYRIGHT AND PATENT RIGHTS, ARE RESERVED BY FORMETCO, INC.			
DO NOT SCALE			

STANDARD CONFIGURATION

18'-10" STOCK LENGTH

18'-10" USE FULL LENGTH - NO CUT

UNISTRUT CUT PLAN 18 TILES
6 REQUIRED

18'-10" STOCK LENGTH

16'-8 3/8" CUT LENGTH

UNISTRUT CUT PLAN 16 TILES
6 REQUIRED

2'-1 3/8" DROP

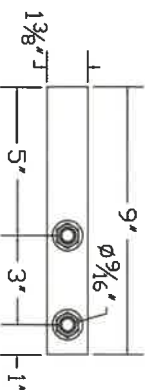
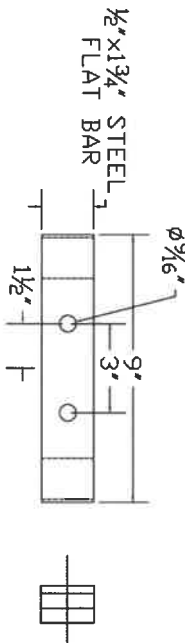
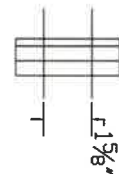
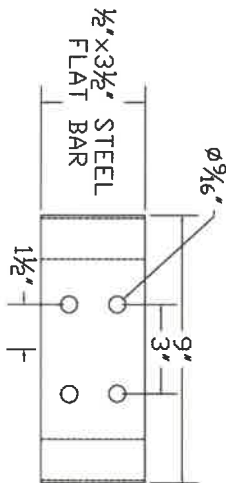
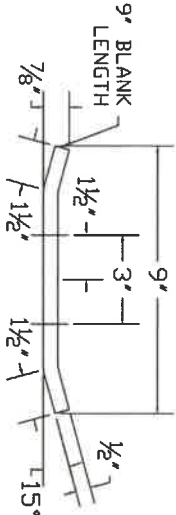
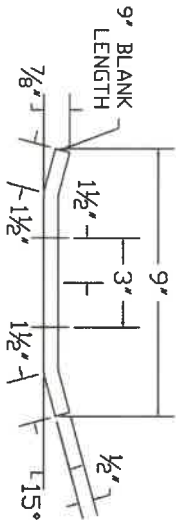
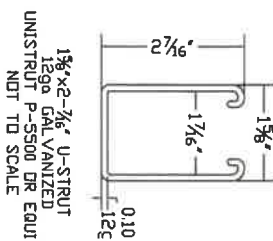

FORMED I-BEAM CLAMP
DOUBLE WIDTH
3 1/2" x 1/2" FLAT BAR
PAINT GRAY
SCALE 4X
QTY = 20 REQ'D

FORMED I-BEAM CLAMP
SINGLE WIDTH
1 3/4" x 1/2" FLAT BAR
PAINT GRAY
SCALE 4X
QTY = 20 REQ'D

UNISTRUT CLAMP BOLT PLATE
1.375" x 9" FLAT
12ga GALVANNEAL
SCALE 4X
QTY = 60 REQ'D

NOTE:
GRAY UPRIGHT BEAM CLAMP - 1/2" THICK

PART NUMBER			
FTX-A-DBB			
APPROVALS			
REV	MISC. UPDATES AND CORRECTIONS	DATE	RFV
1	DESCRIPTION	DATE	APPD
REVISIONS			
1	DESCRIPTION	DATE	APPD
THIS MATERIAL IS THE EXCLUSIVE CONFIDENTIAL PROPERTY OF FORMETCO, INC.			
ALL RIGHTS, INCLUDING COPYRIGHT AND PATENT RIGHTS, ARE RESERVED BY FORMETCO, INC.			
2963 Pleasant Hill Rd. Duluth, GA 30096-3801			
U-STRUT & I-BEAM CLAMP FABRICATOR			
10'-6" x 35'-8" 13.3mm FTX-A DBB			
DWG N 0000			

FORMETCO

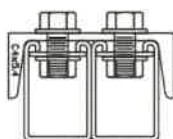
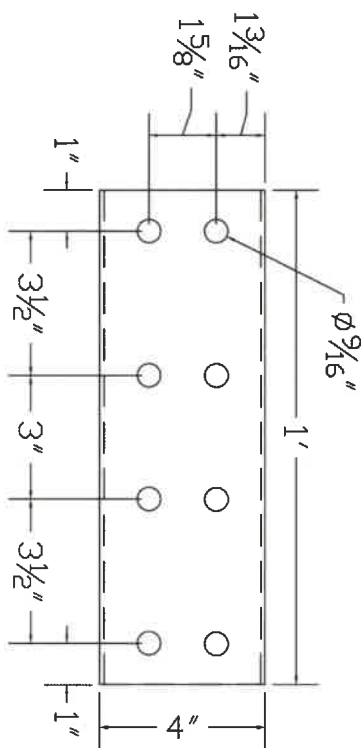
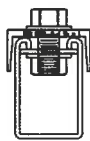
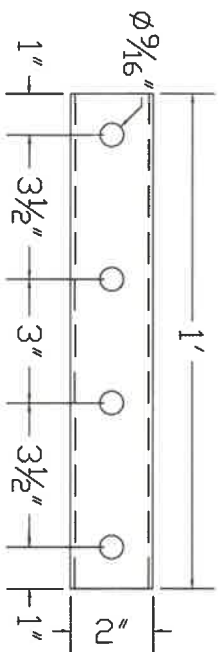

TOP/BOT UNISTRUT SPLICE
2"x1"x3/16" BAR CHANNEL
SCALE 4X
QTY = 2 REQ'D

MID DBL UNISTRUT SPLICE
C4 x 5.4 CHANNEL
SCALE 4X
QTY = 2 REQ'D

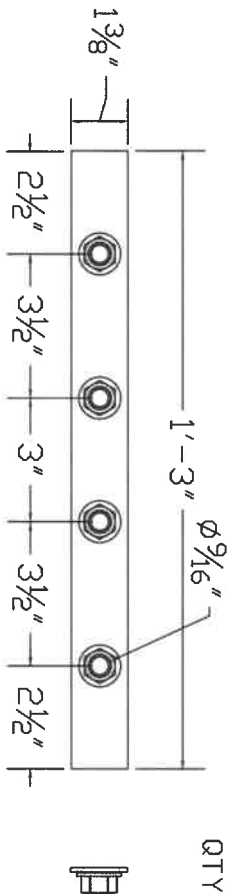

UNISTRUT SPLICE BOLT PLATE
1.375" x 15" FLAT
12ga GALVANNEAL
SCALE 4X
QTY = 6 REQ'D

				PART NUMBER	
				FTX-A DBB	
				APPROVALS	
				2963 Pleasant Hill Rd. Duluth, GA 30096-38	
				U-STRUT SPLICES FABRICATION	
				10'-6"x35'-8" 13.3mm FTX-A DBB	
				DATE	
				TIME	
				BY	
				CHECKED	
				DATE	
				TIME	
				BY	
				CHECKED	
				DATE	
				TIME	
				BY	
				CHECKED	
				DATE	
				TIME	
				BY	
				CHECKED	
				DATE	
				TIME	
				BY	
				CHECKED	
				DATE	
				TIME	
				BY	
				CHECKED	
				DATE	
				TIME	
				BY	
				CHECKED	
				DATE	
				TIME	
				BY	
				CHECKED	
				DATE	
				TIME	
				BY	
				CHECKED	
				DATE	
				TIME	
				BY	
				CHECKED	
				DATE	
				TIME	
				BY	
				CHECKED	
				DATE	
				TIME	
				BY	
				CHECKED	
				DATE	
				TIME	
				BY	
				CHECKED	
				DATE	
				TIME	
				BY	
				CHECKED	
				DATE	
				TIME	
				BY	
				CHECKED	
				DATE	
				TIME	
				BY	
				CHECKED	
				DATE	
				TIME	
				BY	
				CHECKED	
				DATE	
				TIME	
				BY	
				CHECKED	
				DATE	
				TIME	
				BY	
				CHECKED	
				DATE	
				TIME	
				BY	
				CHECKED	
				DATE	
				TIME	
				BY	
				CHECKED	
				DATE	
				TIME	
				BY	
				CHECKED	
				DATE	
				TIME	
				BY	
				CHECKED	
				DATE	
				TIME	
				BY	
				CHECKED	
				DATE	
				TIME	
				BY	
				CHECKED	
				DATE	
				TIME	
				BY	
				CHECKED	
				DATE	
				TIME	
				BY	
				CHECKED	
				DATE	
				TIME	
				BY	
				CHECKED	
				DATE	
				TIME	
				BY	
				CHECKED	
				DATE	
				TIME	
				BY	
				CHECKED	
				DATE	
				TIME	
				BY	
				CHECKED	
				DATE	
				TIME	
				BY	
				CHECKED	
				DATE	
				TIME	
				BY	
				CHECKED	
				DATE	
				TIME	
				BY	
				CHECKED	
				DATE	
				TIME	
				BY	
				CHECKED	
				DATE	
				TIME	
				BY	
				CHECKED	
				DATE	
				TIME	
				BY	
				CHECKED	
				DATE	
				TIME	
				BY	
				CHECKED	
				DATE	
				TIME	
				BY	
				CHECKED	
				DATE	
				TIME	
				BY	
				CHECKED	
				DATE	
				TIME	
				BY	
				CHECKED	
				DATE	
				TIME	
				BY	
				CHECKED	
				DATE	
				TIME	
				BY	
				CHECKED	
				DATE	
				TIME	
				BY	
				CHECKED	
				DATE	
				TIME	
				BY	
				CHECKED	
				DATE	
				TIME	
				BY	
				CHECKED	
				DATE	
				TIME	
				BY	
				CHECKED	
				DATE	
				TIME	
				BY	
				CHECKED	
				DATE	
				TIME	
				BY	
				CHECKED	
				DATE	
				TIME	
				BY	
				CHECKED	
				DATE	
				TIME	
				BY	
				CHECKED	
				DATE	
				TIME	
				BY	
				CHECKED	
				DATE	
				TIME	
				BY	
				CHECKED	
				DATE	
				TIME	
				BY</	

STANDARD CONFIGURATION

(27) F-TILE CABINETS

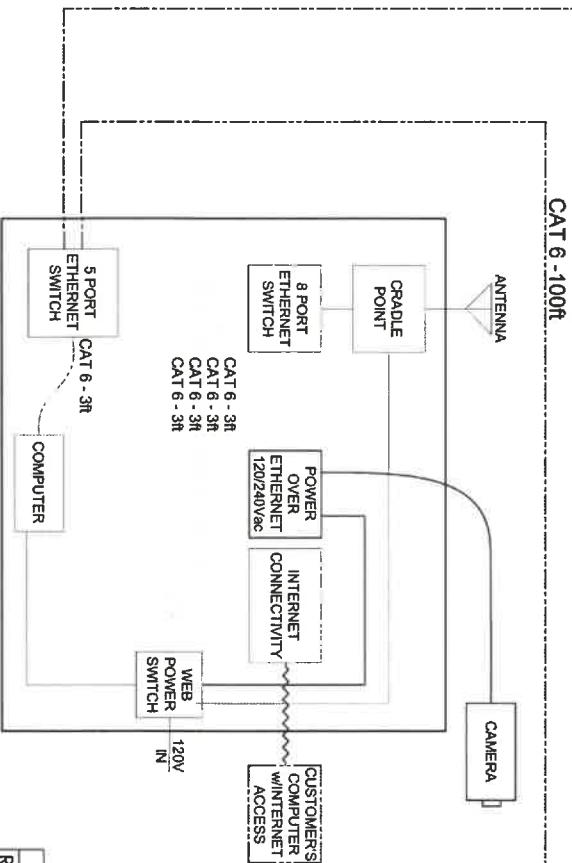
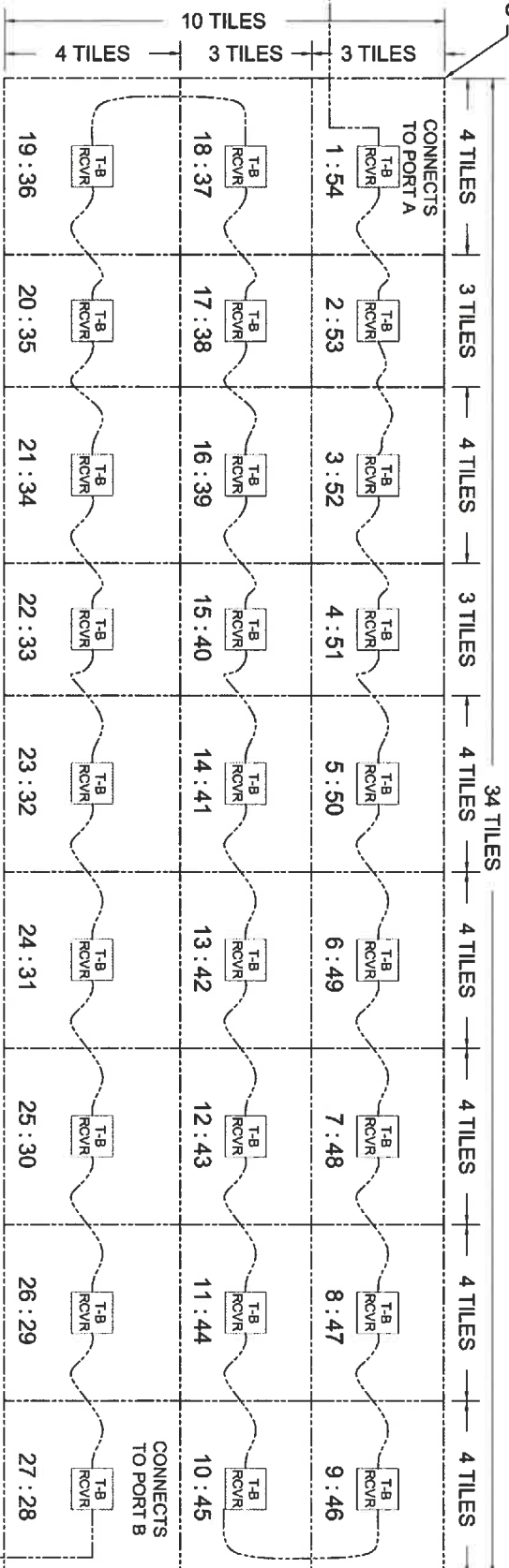

NOTE: CABINETS SHOWN AS VIEWED FROM THE REAR

REV		DESCRIPTION		DATE		APPD	
1		DESCRIPTION		DATE		APPD	
2		DESCRIPTION		DATE		APPD	
3		DESCRIPTION		DATE		APPD	
4		DESCRIPTION		DATE		APPD	
5		DESCRIPTION		DATE		APPD	
6		DESCRIPTION		DATE		APPD	
7		DESCRIPTION		DATE		APPD	
8		DESCRIPTION		DATE		APPD	
9		DESCRIPTION		DATE		APPD	
10		DESCRIPTION		DATE		APPD	
11		DESCRIPTION		DATE		APPD	
12		DESCRIPTION		DATE		APPD	
13		DESCRIPTION		DATE		APPD	
14		DESCRIPTION		DATE		APPD	
15		DESCRIPTION		DATE		APPD	
16		DESCRIPTION		DATE		APPD	
17		DESCRIPTION		DATE		APPD	
18		DESCRIPTION		DATE		APPD	
19		DESCRIPTION		DATE		APPD	
20		DESCRIPTION		DATE		APPD	
21		DESCRIPTION		DATE		APPD	
22		DESCRIPTION		DATE		APPD	
23		DESCRIPTION		DATE		APPD	
24		DESCRIPTION		DATE		APPD	
25		DESCRIPTION		DATE		APPD	
26		DESCRIPTION		DATE		APPD	
27		DESCRIPTION		DATE		APPD	

THIS MATERIAL IS THE EXCLUSIVE CONFIDENTIAL PROPERTY OF FORMETCO, INC.
ALL RIGHTS, INCLUDING COPYRIGHT AND PATENT RIGHTS, ARE RESERVED BY FORMETCO, INC.

2963 Pleasant Hill Rd. Duluth, GA 30096-381

FORMETCO

POWER CABINET AND BREAKER REQUIREMENTS AND AMPERAGE AND WATTAGE RATINGS SHOWN ARE PER DIGITAL DISPLAY UNLESS OTHERWISE INDICATED.

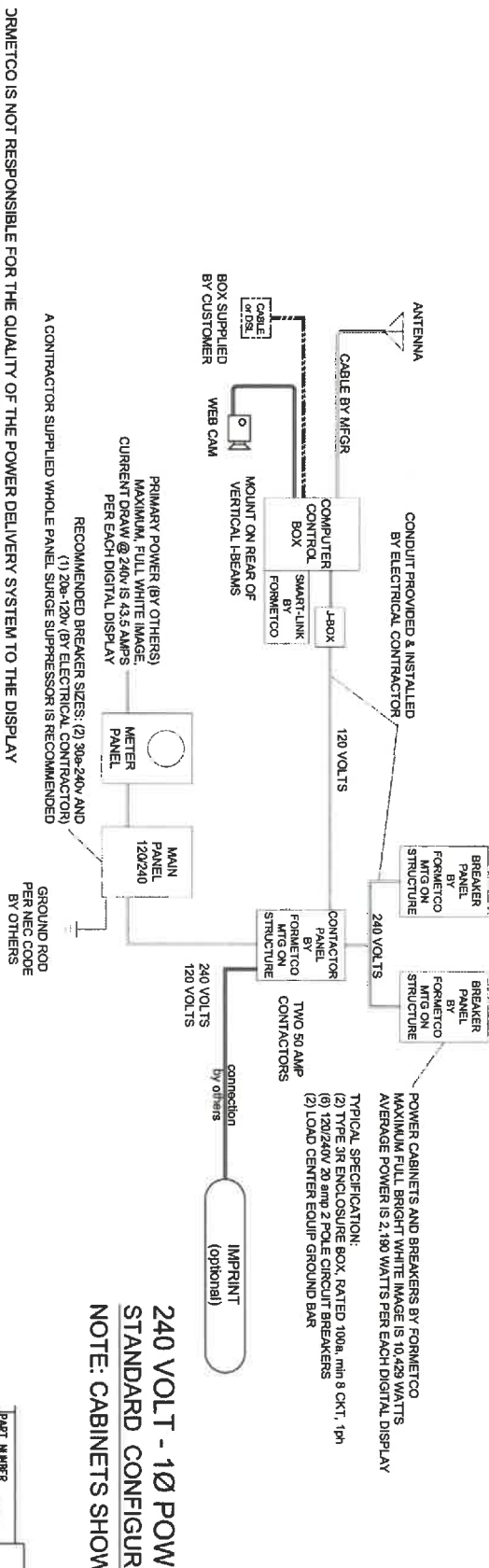
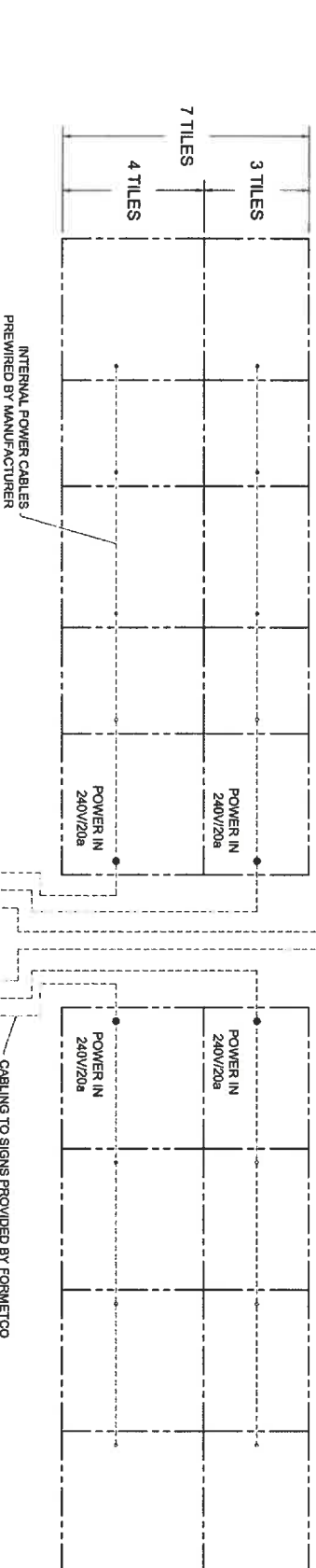
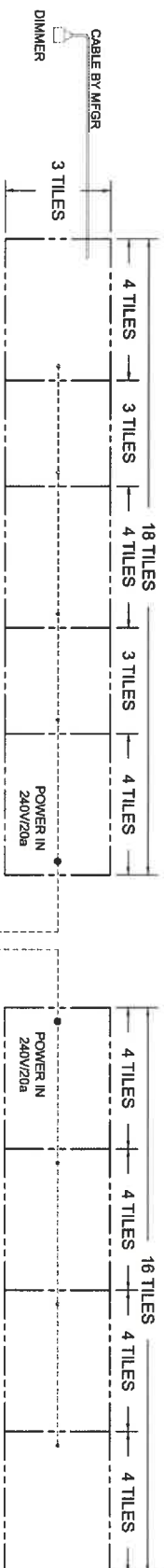

240 VOLT - 1Ø POWER
STANDARD CONFIGURATION
NOTE: CABINETS SHOWN AS VIEWED FROM THE REAR

FORMETCO IS NOT RESPONSIBLE FOR THE QUALITY OF THE POWER DELIVERY SYSTEM TO THE DISPLAY

1. DISPLAYS MUST BE GROUNDED PER ARTICLE 250 AND 800 OF THE NEC

1. ELECTRICAL WORK DONE MUST MEET OR EXCEED ANY LOCAL AND NATIONAL ELECTRICAL CODES

1. THE POWER DELIVERY CIRCUIT

1. THE OVER CURRENT PROTECTION DEVICE MUST BE MATCHED TO THE FAULT CURRENT THAT IS AVAILABLE

1. THE OVER CURRENT PROTECTION DEVICE(S) MAY HAVE TO BE OVERSIZED

1. PRIMARY FEEDER CIRCUITS TO THE DISPLAY MUST BE UL 489 LISTED

REV	DESCRIPTION	DATE	APPD	REVISED
A	MOVE SMARTLINK TO CONTROL BOX AND REVISE NOTES	04-13-23	CJD	
REV				

THIS MATERIAL IS THE EXCLUSIVE CONFIDENTIAL PROPERTY OF FORMETCO, INC.
ALL RIGHTS, INCLUDING COPYRIGHT AND PATENT RIGHTS, ARE RESERVED BY FORMETCO, INC.

PART NUMBER: FTX-A DBB

APPROVALS: 08-23

2963 Pleasant Hill Rd. Duluth, GA 30096-381

240V - 1Ø ELECTRICAL RISER

Addendum to Sign Permit Application

1. Please note that the online permit submittal portal located at <https://smyrnaga.portal.opengove.com> did not offer an option that matches the type of sign requested. The proposed sign is commonly called a "freestanding sign" or an "off-premise sign."



City of Smyrna

3180 Atlanta Road

Smyrna, Georgia 30080

(678) 631-5387 / Community Development

May 6, 2024

Michael B Fitzgerald, Manager Atlantic Billboards, LLC
3162 Johnson Ferry Rd #260-441
Marietta, GA 30062

RE: Sign Permit: SIGN-24-79
2410 S Cobb Dr
17034600250

The application for permit SIGN-24-79 is denied based on the non-compliance with the regulations established in Chapter 82, Section 15 of the Smyrna Code of Ordinances. The proposed sign exceeds both the maximum area (32 square feet) and maximum height (8 feet) specified by the ordinance, is not a ground based monument sign as required by the ordinance and is a pole sign as prohibited by the ordinance.

Also, this sign would exceed the number of allowable signs at this location because there is already one ground based monument sign at this location.

Due to the non-compliance with these standards established in Chapter 82 of the Smyrna Code of Ordinances, the sign permit is denied.

Joey Staubes
Planner II
Community Development

Mayor – Derek Norton

City Council Ward 1 – Glen Pickens / Ward 2 – Latonia P. Hines / Ward 3 – Travis Lindley / Ward 4 – Charles Welch
Ward 5 – Susan Wilkinson / Ward 6 – Tim Gould / Ward 7 – Ricky Oglesby, Jr.

City Administrator – Joe Bennett / City Clerk – Heather Corn / City Attorney – Scott Cochran
Municipal Court Judge – Phyllis Gingrey Collins

**PROPERTY OWNER AUTHORIZATION**

City of Smyrna Community Development Department, 3180 Atlanta Rd, Smyrna, GA 30080
Office Phone 678-631-5387 / Fax 770-431-2808

I, Kadirali Chunara for FC Enterprises Inc, swear that I am the Property Owner of the property

located at: 2401 South Cobb Drive

as shown in the records of Cobb County, Georgia, which is the subject matter of the attached application.

I authorize the person named below to act as the applicant in pursuit of this application.

Name of Applicant (print clearly): Atlantic Billboards, LLC, Mike Fitzgerald, Manager

Address: 3162 Johnson Ferry Rd, #260-441, Marietta, GA 30062

Telephone: 678-571-8889 Email: Mike@AtlanticBillboards.com

I have read, understood, and answered the aforementioned items to the best of my knowledge. If I am found to have misrepresented myself on this affidavit or the attached application, I am aware I may be in violation of the City Code and run the risk of being issued a citation for violation of the City of Smyrna Code of Ordinances.

(Must be signed by the property owner. If the landowner is a corporation, the form must be signed by an officer of the corporation.)

Signature of Property Owner

2199 Glenmore Lane

Address

Kadirali Chunara

Name of Property Owner (print clearly)

Snellville GA 30078

City, State, Zip



CERTIFICATE OF LIABILITY INSURANCE

DATE (MM/DD/YYYY)

02/13/2024

THIS CERTIFICATE IS ISSUED AS A MATTER OF INFORMATION ONLY AND CONFERS NO RIGHTS UPON THE CERTIFICATE HOLDER. THIS CERTIFICATE DOES NOT AFFIRMATIVELY OR NEGATIVELY AMEND, EXTEND OR ALTER THE COVERAGE AFFORDED BY THE POLICIES BELOW. THIS CERTIFICATE OF INSURANCE DOES NOT CONSTITUTE A CONTRACT BETWEEN THE ISSUING INSURER(S), AUTHORIZED REPRESENTATIVE OR PRODUCER, AND THE CERTIFICATE HOLDER.

IMPORTANT: If the certificate holder is an ADDITIONAL INSURED, the policy(ies) must have ADDITIONAL INSURED provisions or be endorsed. If SUBROGATION IS WAIVED, subject to the terms and conditions of the policy, certain policies may require an endorsement. A statement on this certificate does not confer rights to the certificate holder in lieu of such endorsement(s).

PRODUCER STARR-MATHEWS AGENCY P. O. Box 1990 Cartersville GA 30120		CONTACT NAME: Trung Ly PHONE (A/C, No, Ext): (770) 386-0466 FAX (A/C, No): (770) 386-3164 E-MAIL ADDRESS: tly@starmathews.com	
INSURED Bowen Auger Service, Inc. P O Box 178 Adairsville GA 30103-0178		INSURER(S) AFFORDING COVERAGE INSURER A: Westfield Insurance Co INSURER B: Builders Insurance INSURER C: INSURER D: INSURER E: INSURER F:	
		NAIC # 24112 10704	

COVERAGES**CERTIFICATE NUMBER:** 2023-24**REVISION NUMBER:**

THIS IS TO CERTIFY THAT THE POLICIES OF INSURANCE LISTED BELOW HAVE BEEN ISSUED TO THE INSURED NAMED ABOVE FOR THE POLICY PERIOD INDICATED. NOTWITHSTANDING ANY REQUIREMENT, TERM OR CONDITION OF ANY CONTRACT OR OTHER DOCUMENT WITH RESPECT TO WHICH THIS CERTIFICATE MAY BE ISSUED OR MAY PERTAIN, THE INSURANCE AFFORDED BY THE POLICIES DESCRIBED HEREIN IS SUBJECT TO ALL THE TERMS, EXCLUSIONS AND CONDITIONS OF SUCH POLICIES. LIMITS SHOWN MAY HAVE BEEN REDUCED BY PAID CLAIMS.

INSR LTR	TYPE OF INSURANCE	ADDL SUBR INSD WVD	POLICY NUMBER	POLICY EFF (MM/DD/YYYY)	POLICY EXP (MM/DD/YYYY)	LIMITS
A	<input checked="" type="checkbox"/> COMMERCIAL GENERAL LIABILITY <input type="checkbox"/> CLAIMS-MADE <input checked="" type="checkbox"/> OCCUR GEN'L AGGREGATE LIMIT APPLIES PER: <input type="checkbox"/> POLICY <input checked="" type="checkbox"/> PROJECT <input checked="" type="checkbox"/> LOC OTHER:		3783172	11/04/2023	11/04/2024	EACH OCCURRENCE \$ 1,000,000 DAMAGE TO RENTED PREMISES (Ea occurrence) \$ 1,000,000 MED EXP (Any one person) \$ 10,000 PERSONAL & ADV INJURY \$ 1,000,000 GENERAL AGGREGATE \$ 2,000,000 PRODUCTS - COMP/OP AGG \$ 2,000,000 Property damage-single \$
	<input checked="" type="checkbox"/> AUTOMOBILE LIABILITY <input checked="" type="checkbox"/> ANY AUTO <input type="checkbox"/> OWNED AUTOS ONLY <input checked="" type="checkbox"/> HIRED AUTOS ONLY <input type="checkbox"/> SCHEDULED AUTOS <input checked="" type="checkbox"/> NON-OWNED AUTOS ONLY		3783172	11/04/2023	11/04/2024	COMBINED SINGLE LIMIT (Ea accident) \$ 1,000,000 BODILY INJURY (Per person) \$ BODILY INJURY (Per accident) \$ PROPERTY DAMAGE (Per accident) \$ Medical payments \$ 10,000
	<input checked="" type="checkbox"/> UMBRELLA LIAB <input checked="" type="checkbox"/> OCCUR <input type="checkbox"/> EXCESS LIAB <input type="checkbox"/> CLAIMS-MADE DED RETENTION \$		3783172	11/04/2023	11/04/2024	EACH OCCURRENCE \$ 5,000,000 AGGREGATE \$ 5,000,000 \$
	<input checked="" type="checkbox"/> WORKERS COMPENSATION AND EMPLOYERS' LIABILITY ANY PROPRIETOR/PARTNER/EXECUTIVE OFFICER/MEMBER EXCLUDED? (Mandatory in NH) If yes, describe under DESCRIPTION OF OPERATIONS below Y / N <input checked="" type="checkbox"/> Y N / A		WCV002484820	07/14/2023	07/14/2024	<input checked="" type="checkbox"/> PER STATUTE <input type="checkbox"/> OTH-ER E.L. EACH ACCIDENT \$ 1,000,000 E.L. DISEASE - EA EMPLOYEE \$ 1,000,000 E.L. DISEASE - POLICY LIMIT \$ 1,000,000

DESCRIPTION OF OPERATIONS / LOCATIONS / VEHICLES (ACORD 101, Additional Remarks Schedule, may be attached if more space is required)

(GL) CG 7137 12 17 - Signature Series Commercial General Liability Contractors Endorsement.
(GL) CG 25 04 A 05 09 - Designated Location(s) General Aggregate Limit.
(GL) CG 25 03 05 09 - Designated Construction Project(s) General Aggregate Limit.
(GL) CG 20 37 04 13 - Additional Insured - Owners, Lessees or Contractors - Completed Operations.
(GL) CG 20 10 04 13 - Additional Insured - Owners, Lessees or Contractors - Scheduled Person or Organization.
(AUTO) CA 70 77 10 13 - Signature Series Business Auto Endorsement.
(AUTO) CA 70 75 10 13 - Primary and Noncontributory Insurance.

CERTIFICATE HOLDER**CANCELLATION**

Atlantic Billboards, LLC 3162 Johnson Ferry Rd Ste 260-441 Marietta GA 30062	SHOULD ANY OF THE ABOVE DESCRIBED POLICIES BE CANCELLED BEFORE THE EXPIRATION DATE THEREOF, NOTICE WILL BE DELIVERED IN ACCORDANCE WITH THE POLICY PROVISIONS. AUTHORIZED REPRESENTATIVE
---	---

© 1988-2015 ACORD CORPORATION. All rights reserved.

BARTOW COUNTY, GEORGIA HOME BASED

VALID 01/01/2024 THROUGH 01/01/2025

BUSINESS NAME/ADDRESS	OWNER NAME	BUSINESS DESCRIPTION
BOWEN AUGER SERVICES, INC. 326 PLEASANT VALLEY RD ADAIRSVILLE, GA 30103	BOWEN JEROME D	

LICENSE FEES PAID	LICENSE OFFICIAL	LICENSE NUMBER
180.00		HO14

THIS LICENSE IS GRANTED BY THE BARTOW COUNTY COMMUNITY DEVELOPMENT DEPARTMENT AND ACCEPTED BY LICENSEE SUBJECT TO ALL OF THE TERMS AND CONDITIONS OF THE ORDINANCES GOVERNING THE ISSUANCE AND RETENTION OF THE SAME.

*** Please note, license fee amount does not include an administrative fee of \$30**

DISPLAY IN A CONSPICUOUS LOCATION. MAY BE REVOKED FOR CAUSE.

THE STRUCTURE SHOWN, AS DESIGNED, IS CAPABLE OF SUPPORTING UP TO TWO (2) DIGITAL UNITS WEIGHING UP TO APPROXIMATELY 4,725# EACH.

NOTE: 18" UPPER & LOWER WIDE CHANNELS NOT SHOWN FOR CLARITY

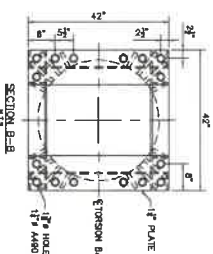
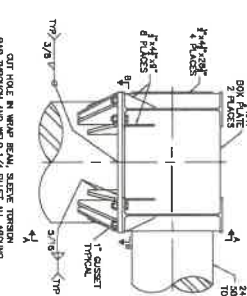
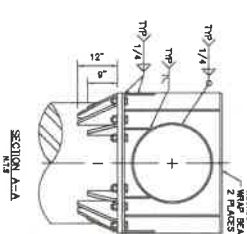
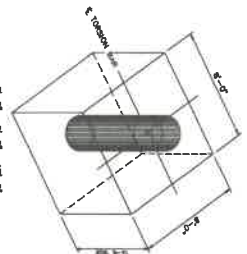
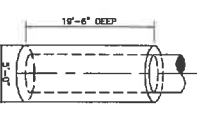
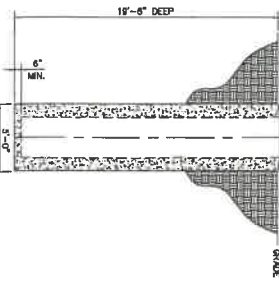
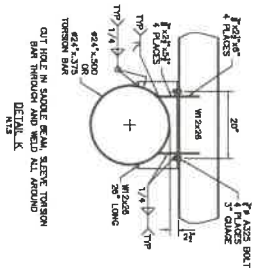
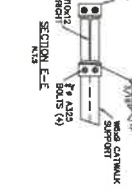
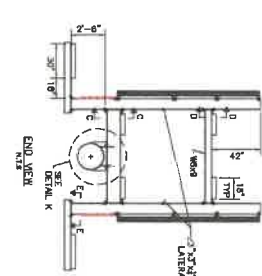
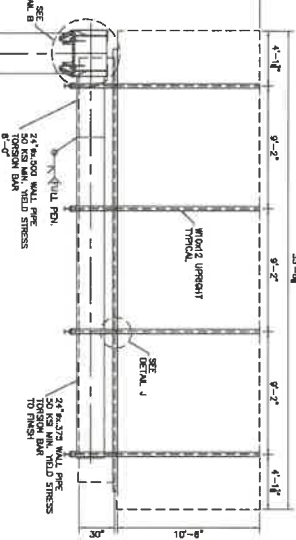
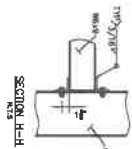
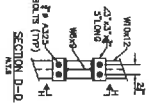
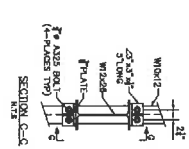
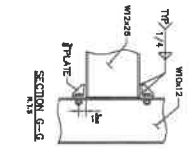
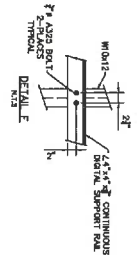
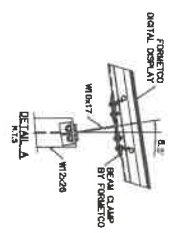
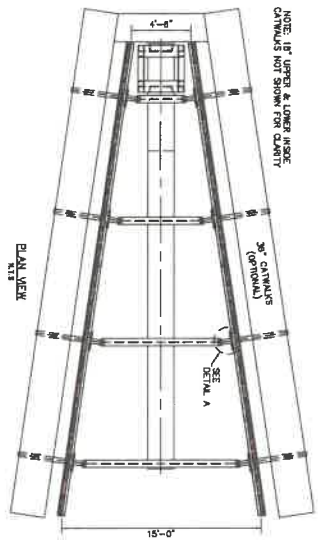

GENERAL NOTES

1. All design, detailing, fabricating and construction shall conform to the following codes and specifications:
 - a. American Institute of Steel Construction (AISC) 13th Edition
 - b. American Society of Testing and Materials (ASTM) specifications
 - c. Building Department (Current Edition)
 - d. Code for Welding in Building Construction of the American Welding Society (AWS) (Current Edition)
 - e. Institute of Steel Construction (ISC) (Current Edition)
2. Concrete shall be 4,000 P.S.I. @ 28 days
3. Reinforcing Steel (Embedded) shall be ASTM A-615 Grade 60.
4. Structural Steel and Plates shall be A-36.
5. All welding shall be up to 3/16 inch thick, except as noted.
6. All welding shall be up to 3/16 inch thick, except as noted.
7. All welding shall be up to 3/16 inch thick, except as noted.
8. All welding shall be up to 3/16 inch thick, except as noted.
9. All welding shall be up to 3/16 inch thick, except as noted.
10. All welding shall be up to 3/16 inch thick, except as noted.
11. All welding shall be up to 3/16 inch thick, except as noted.
12. All welding shall be up to 3/16 inch thick, except as noted.

This drawing is for permitting purposes only, unauthorized use prohibited.

Selective Structures, LLC

811 East Avenue
Athens, TN 37603

10'-6" x 36'-0" FF, 15'V @ 40'-0" O.A.H.
w/Up to Two (2) 4.725# Digital Displays
Located In: Smyrna, GA

GINN ENGINEERING SERVICES, LLC
1971 FLATROCK RD.
WATKINSVILLE, GA 30677
678-323-0872

REVISIONS

DATE	BY	REVISION
02/16/24	TJS	1
02/16/24	TJS	2
02/16/24	TJS	3
02/16/24	TJS	4
02/16/24	TJS	5
02/16/24	TJS	6
02/16/24	TJS	7
02/16/24	TJS	8
02/16/24	TJS	9
02/16/24	TJS	10
02/16/24	TJS	11
02/16/24	TJS	12
02/16/24	TJS	13
02/16/24	TJS	14
02/16/24	TJS	15
02/16/24	TJS	16
02/16/24	TJS	17
02/16/24	TJS	18
02/16/24	TJS	19
02/16/24	TJS	20
02/16/24	TJS	21
02/16/24	TJS	22
02/16/24	TJS	23
02/16/24	TJS	24
02/16/24	TJS	25
02/16/24	TJS	26
02/16/24	TJS	27
02/16/24	TJS	28
02/16/24	TJS	29
02/16/24	TJS	30
02/16/24	TJS	31
02/16/24	TJS	32
02/16/24	TJS	33
02/16/24	TJS	34
02/16/24	TJS	35
02/16/24	TJS	36
02/16/24	TJS	37
02/16/24	TJS	38
02/16/24	TJS	39
02/16/24	TJS	40
02/16/24	TJS	41
02/16/24	TJS	42
02/16/24	TJS	43
02/16/24	TJS	44
02/16/24	TJS	45
02/16/24	TJS	46
02/16/24	TJS	47
02/16/24	TJS	48
02/16/24	TJS	49
02/16/24	TJS	50
02/16/24	TJS	51
02/16/24	TJS	52
02/16/24	TJS	53
02/16/24	TJS	54
02/16/24	TJS	55
02/16/24	TJS	56
02/16/24	TJS	57
02/16/24	TJS	58
02/16/24	TJS	59
02/16/24	TJS	60
02/16/24	TJS	61
02/16/24	TJS	62
02/16/24	TJS	63
02/16/24	TJS	64
02/16/24	TJS	65
02/16/24	TJS	66
02/16/24	TJS	67
02/16/24	TJS	68
02/16/24	TJS	69
02/16/24	TJS	70
02/16/24	TJS	71
02/16/24	TJS	72
02/16/24	TJS	73
02/16/24	TJS	74
02/16/24	TJS	75
02/16/24	TJS	76
02/16/24	TJS	77
02/16/24	TJS	78
02/16/24	TJS	79
02/16/24	TJS	80
02/16/24	TJS	81
02/16/24	TJS	82
02/16/24	TJS	83
02/16/24	TJS	84
02/16/24	TJS	85
02/16/24	TJS	86
02/16/24	TJS	87
02/16/24	TJS	88
02/16/24	TJS	89
02/16/24	TJS	90
02/16/24	TJS	91
02/16/24	TJS	92
02/16/24	TJS	93
02/16/24	TJS	94
02/16/24	TJS	95
02/16/24	TJS	96
02/16/24	TJS	97
02/16/24	TJS	98
02/16/24	TJS	99
02/16/24	TJS	100



NOTE: 16" UPPER & LOWER INSIDE
CATWALKS NOT SHOWN FOR CLARITY

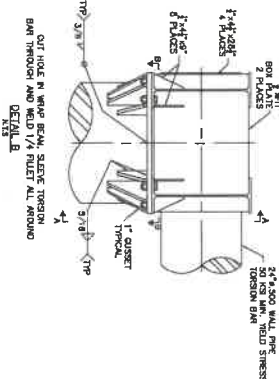
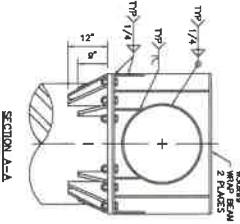
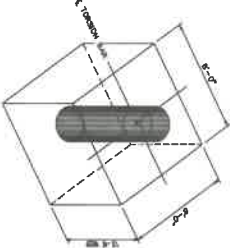
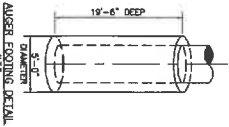
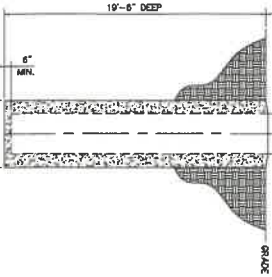
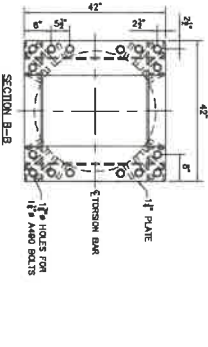
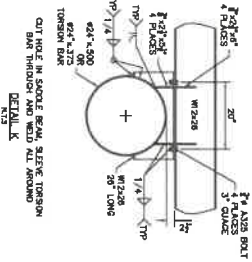
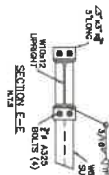
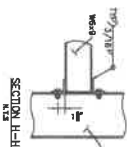
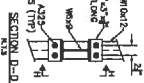
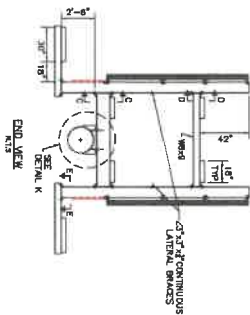
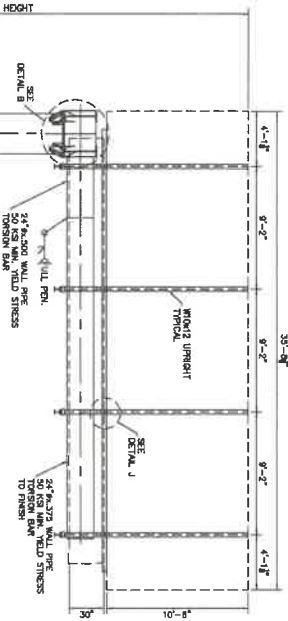
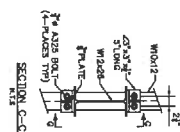
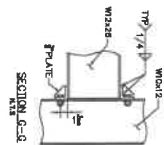
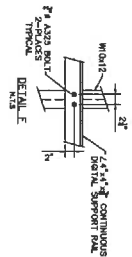
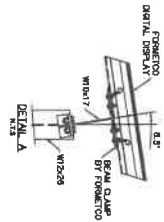
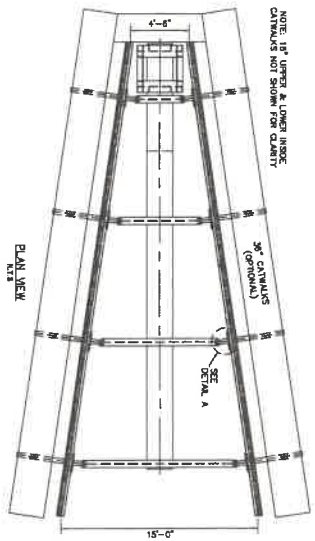

1. All design, detailing, fabrication and construction shall conform to the following codes and specifications:
 - a. The International Building Code (2018 Edition w/Geographic Amendments)
 - b. American Society of Testing and Materials
 - c. Building Code Requirements for Reinforced Concrete (ACI 318—Current Edition)
 - d. Code for Welding in Building Construction of Steel Structures (AWS D1.1B—Current Edition)
 - e. Specification for Structural Steel Fabrication and Erection of Structural Steel by Buildings by the American Institute of Steel Construction (AISC) (Current Edition)
2. Concrete shall be f'c=2800 P.S.I., @ 28 days.
 - a. Compressive Strength, Standard Weight (150 c.c.f.)
3. Reinforcing Steel (Rebar) shall be ASTM A-615 Grade 60,
 - a. Yield strength shall be at least 60,000 psi.
 - b. It shall have a tensile strength of at least 75,000 psi, or certifying that it will produce no distress bond.
 - c. All reinforcing bars shall give 50 diameters minimum, except as follows:
 - d. #4 reinforcement shall be used for all wall reinforcement.
 - e. #5 reinforcement shall be used for all column reinforcement.
4. All bar lap splicing shall be done in accordance with ACI 318-19, Section 17.7.4.2. Splices shall be staggered and shall be located outside of contact with ground; a minimum for embedded surfaces installed against the ground; as noted.

- a. Structural Steel and Pipes shall be $F=50$ and $A=36$ minimum.
- b. Wrought steels shall be $F=50$ and $A=36$ minimum.
- c. Cast steels shall be $F=40$ and $A=24$ minimum.
- d. Structural pipe shall be ASTM A333, Grade B.
- e. Type E or S, ($F=35$ ksi), ASTM A337, Grade 42.
- f. ($F=42$ ksi) or ASTM A337, Grade 50 ($F=50$ ksi) (ksi) (unless otherwise noted).
- g. (see section 9 for additional member specifications).
5. Anchor bolts (Welded) shall be ASTM F1554 Grade 36, unless otherwise specified.
6. High strength bolts for connections shall be ASTM A325, unless otherwise specified.
7. Welding electrodes comply with AWS 11.1 (Joint E6), E70xx.
8. Design Wind Speeds: 110 MPH (I.R.C.)
9. Equivalent Wind Load = 28.7 Psf @ $4.0\text{--}10\text{--}C$ above the ground. (3 Sec Wind) $C=1$
10. Exposure "C" Retell: $G=0.827$
9. Soil Bearing Capacity Requirements:
a. Spread Footings shall be $\frac{1}{3}$ P.S.F.
b. Cais or Pier Foundations shall be $\frac{1}{3}$ Soil Bearing Capacity and $\frac{1}{3}$ (35) $\frac{1}{3}$ (100) $\frac{1}{3}$ (100) $\frac{1}{3}$ (100) of depth.
c. (see section 9 for additional member specifications)
10. Contractor shall verify all dimensions and conditions in the field before erection and install in compliance of any discrepancies.
11. Spacing of pipes shall be equal, dimensioned, and shall be parallel.
12. The structure shall be designed to resist the full design wind load on the structure by a credible wind. Storm wind shall be within one half of the structure design wind speed, unless otherwise noted. The design wind speed shall be the design wind speed for the structure design wind speed, unless otherwise noted.
12. The structure, frame, or designed, is capable of resisting wind to be two (2) equal design windings up to approximately $1/2$ inch each.

811 East Avenue
Athens, TN 37303

Located In: Smyrna, GA



GINN
ENGINEERING
SERVICES

GINN ENGINEERING SERVICES, LLC
1971 FLATROCK RD.
WATKINSVILLE, GA 30677
678-232-0872

REVISIONS

RECEIVED
SECRETARY
No. PED/4301
GOVERNMENT
★

DATE: BT:	TCS
DATE:	02/15/23

PROFESSIONAL
 3-4-24
 ENGINEER
 ALEXANDER JOHNSTON GINN

SCALE:	1/4"=1'-
PROJ. #	####
DWG. #	AC-078
SHEET #	1 OF 1