

Rosalyn & Sterling Shepperd

1153 Rhyne Chase
Smyrna, GA 30082

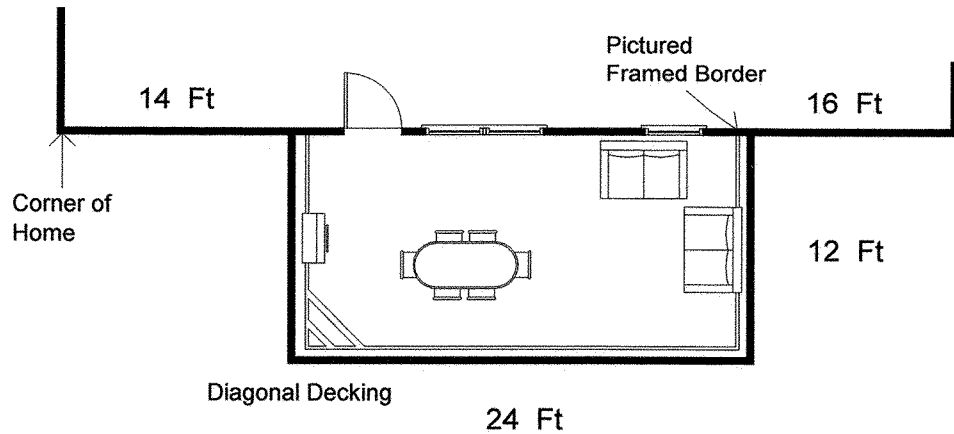

Framing Detail

2 x 10 Floor Joists 12" On Center
Self Supporting Deck Frame

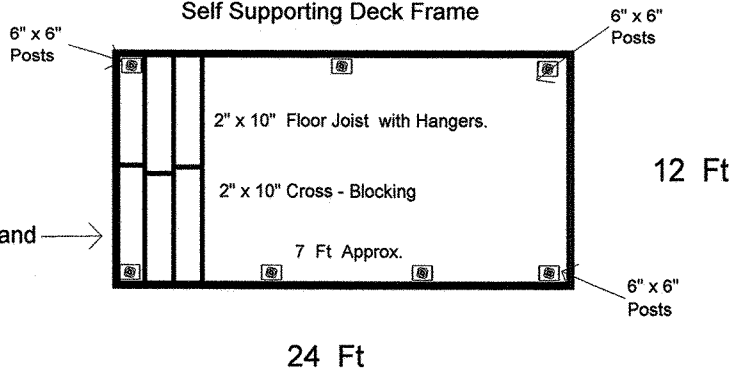

Decks and More, Inc

Frank Pologruto
770-235-6929

1st Drawing

Deck 12' x 24' = 288 Sq ft
Free-Standing Deck

Materials List

6"x6" Main Supports #1 Grade Lumber
2"x10" Floor joists With Joist hangers Spaced 12" O. C.
Pictured Framed Border
5/4"x6" MoistureShield Composite Decking
Fortress Alum. Rails
Double 2" x 10" Band at Perimeter of the Deck.

Handrail Detail

Fortress Black Aluminum Rails
3.5" Spacing between rails / balusters

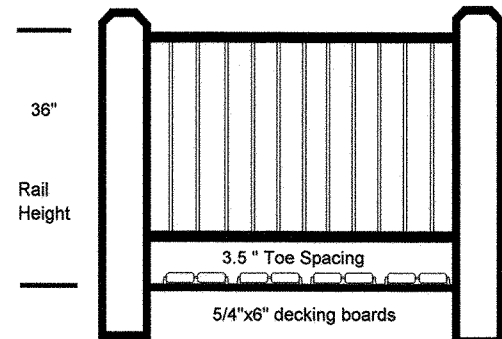

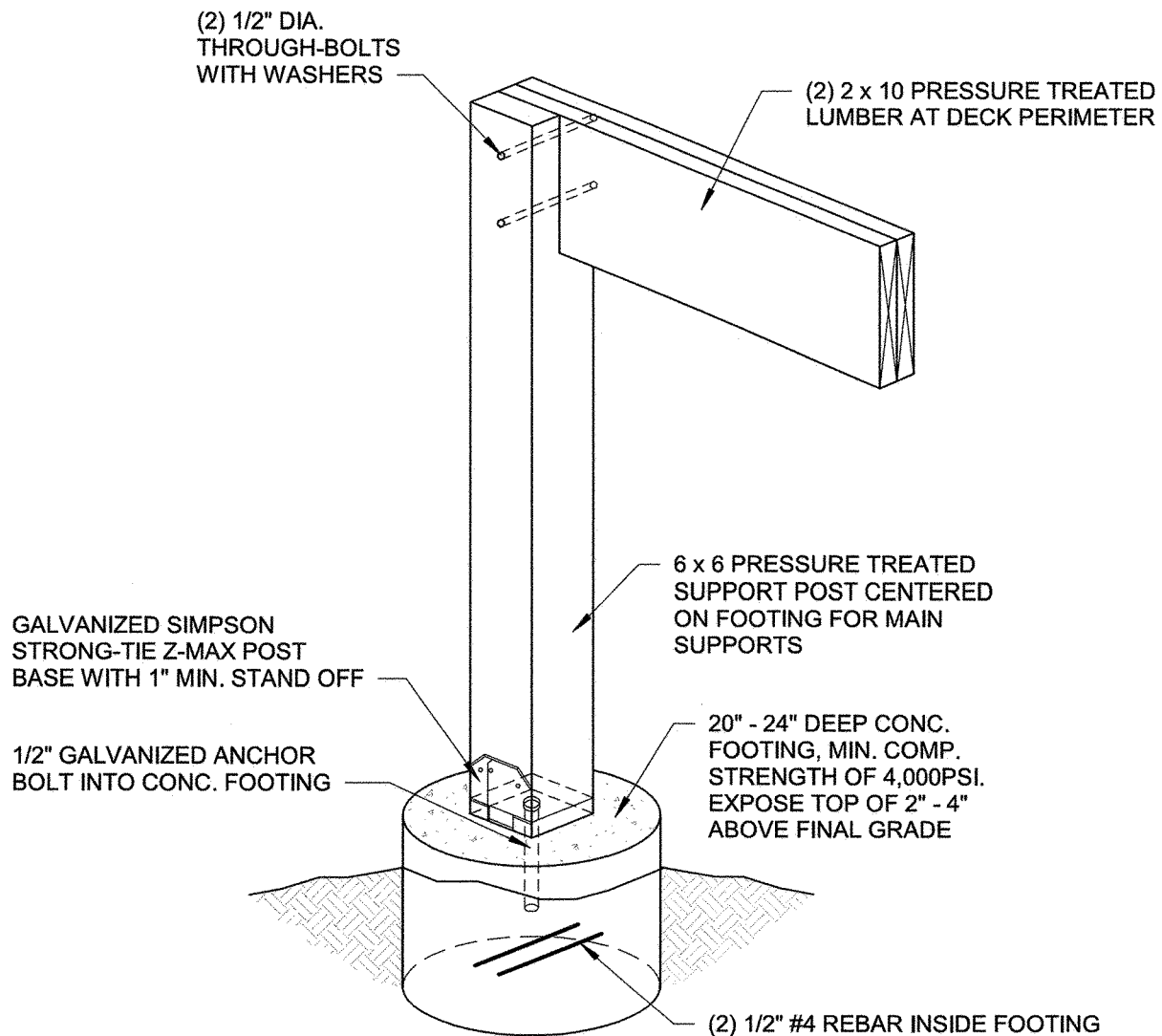

FOOTING AND BEAM CONNECTIONS

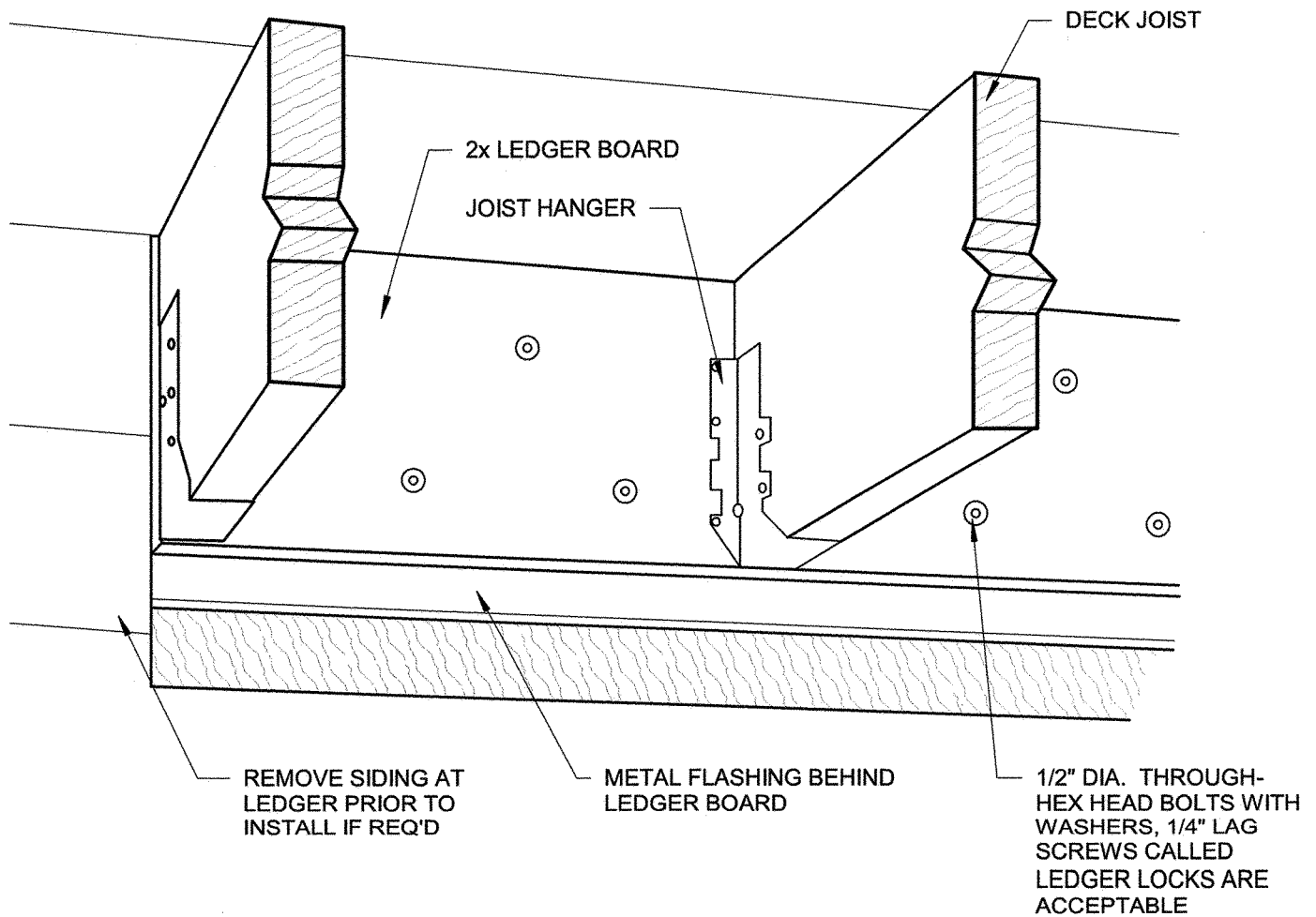

LEDGER CONNECTION DETAIL

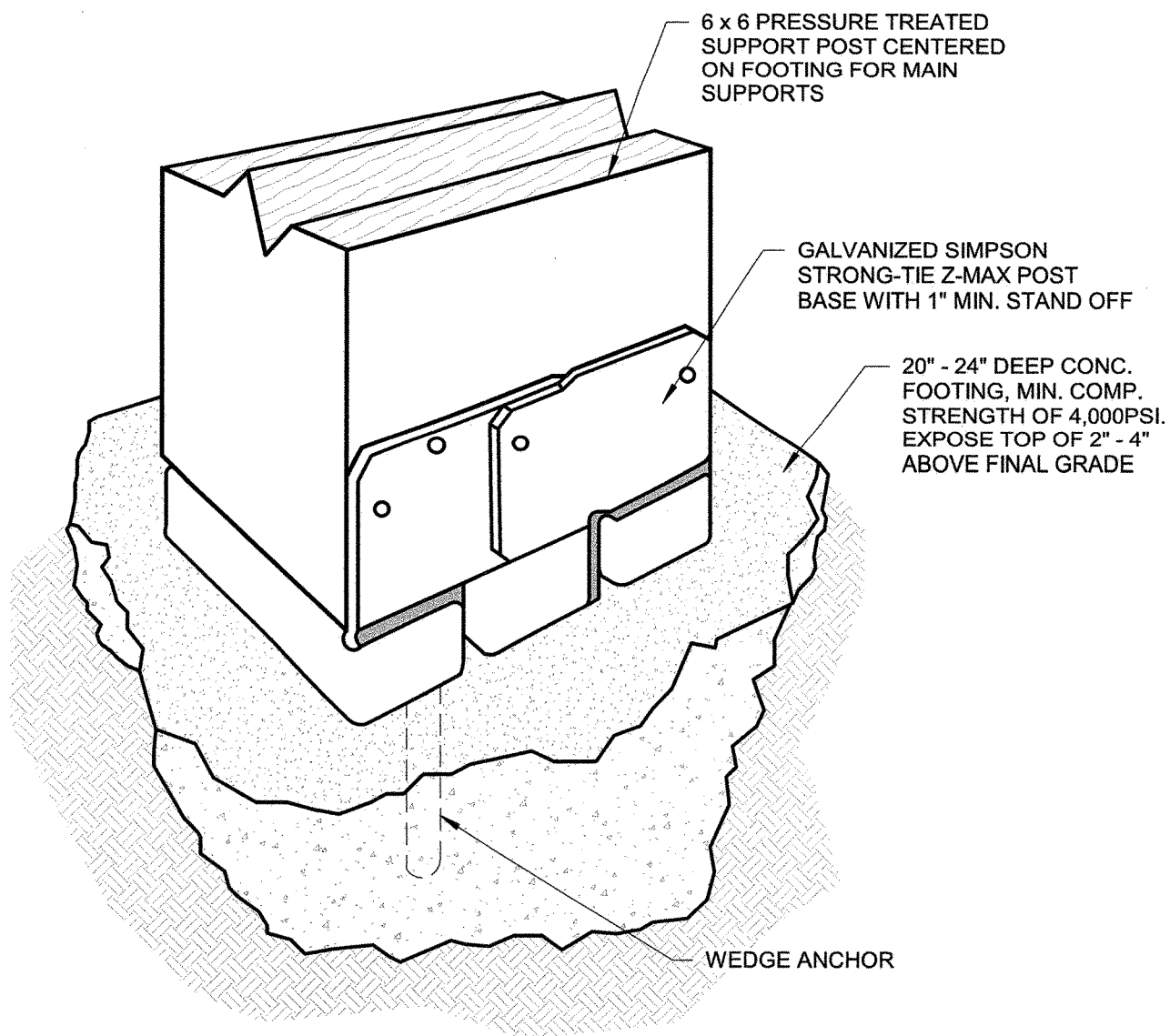

FOOTING DETAIL