



SIGN-24-93

Sign Permit

Status: Active

Submitted On: 5/1/2024

Primary Location

0 HIGHLANDS PKWY SE
SMYRNA, GA 30126

Owner

Norfolk Southern Combined,
Rail Subsidiaries Tax Dept
FRANKLIN RD BLDG 2 110
ROANOKE, VA 24042

Applicant

Michael Fitzgerald
 678-571-8889
 fitzgeraldland@gmail.com
3162 Johnson Ferry Rd, Ste
260-441
Marietta, GA 30062

Internal Only

Additional Comments/Notes

Work without Permit

—

Non-conforming Sign

—

Type of Sign Permit

Sign Type*

Monument

Is this an illuminated sign?*

Yes

Is the sign internally or externally illuminated?*

External

Monument Sign Permit Information

Type of Sign*

Freestanding (General)

Sign Area (sq. ft.)*

375

Height of Sign* ?

70

Number of Sign Faces*

2

Construction Cost of Sign (\$)*

57000

Will sign have electronic messaging?*

Yes

Brief Description of Work*

Install Freestanding Off-Premise Advertising Sign with LED Digital Faces

Property Owner Information

Full Name (i.e., First and Last Name, or Name of Entity):*

Michael B Fitzgerald, Manager Atlantic Billboards, LLC

Street Address*

3162 Johnson Ferry Rd, #260-441

City*

Marietta

State*

GA

Zip Code*

30062

Phone Number

678-571-8889

Email

mike@atlanticbillboards.com

Registered Engineer

Name*

Alexander Ginn

Business Name*

Ginn Engineering Services

Business License Number* ?

OC45301

State License Number*

PE045301

Sign Contractor

Business Name*

Bowen Auger Service, Inc.

Contact Person*

Alishia Bragg

Street Address*

PO Box 178

City*

Adairsville

State*

GA

Zip Code*

30103

Phone Number*

770-386-9724

Email Address*

bowenauger@aol.com

Business License Number* ?

H014

License Expiration Date*

01/01/2025

Insurance Policy Expiration Date*

07/14/2024

Electrical Contractor Information

Business Name*

Paragon Electric, LLC

Contact Person*

John Blue

Street Address*

137 Siena Dr

City*

Cartersville

State*

GA

Zip Code*

30120

Phone Number*

404-409-6597

Email Address*

paragonelectric@gmail.com

GA Contractor License Number*

EN211757

GA Contractor License Expiration Date*

06/30/2024

Certification

Owner and/or agent hereby agrees that he or she will comply with all requirements of the City of Smyrna's Sign Ordinance currently in effect. Also, that the sign will not be located within the street right-of-way or block the view of any intersection.

Applicant Signature*

☒ Michael B. Fitzgerald
May 1, 2024

I have read and understand Chapter 82 of the City's Code of Ordinances and I agree to comply with its regulations.







Applicant Signature*

✓ Michael B. Fitzgerald
May 1, 2024

Acknowledgement**Applicant Signature***

✓ Michael B. Fitzgerald
May 1, 2024

Attachments

- **Oakdale Rd NS.pdf**
Oakdale Rd NS.pdf
Uploaded by Michael Fitzgerald on May 1, 2024 at 3:22 PM
- **Formetco 10 6 x 36 package.pdf**
Formetco 10 6 x 36 package.pdf
Uploaded by Michael Fitzgerald on May 1, 2024 at 3:22 PM
- **Addendum to Sign Permit Application for rail.pdf**
Addendum to Sign Permit Application for rail.pdf
Uploaded by Michael Fitzgerald on May 1, 2024 at 3:23 PM
- **SIGN LOCATION_MABLETON.pdf**
SIGN LOCATION_MABLETON.pdf
Uploaded by Joey Staubes on May 3, 2024 at 4:55 PM
- **Letter and Appendix-SIGN-24-93.pdf**
SIGN-24-93 Letter and Appendix.pdf
Uploaded by Joey Staubes on Jun 7, 2024 at 3:39 PM
- **Property Owner Authorization**
Oakdale Rd and NS signed.pdf
Uploaded by Michael Fitzgerald on May 1, 2024 at 3:21 PM

REQUIRED



Sign Contractor Proof of Insurance

REQUIRED

ACORD Form 20240213-100115.pdf
Uploaded by Michael Fitzgerald on May 1, 2024 at 3:21 PM



Sign Contractor Business License

REQUIRED

Contractor Biz License.pdf
Uploaded by Michael Fitzgerald on May 1, 2024 at 3:21 PM



Dimensioned Sign Rendering

REQUIRED

2 AG-075 10'x36' CM 15'V 70'T LED Smyrna GA 110 IBC_STAMPED Letter.pdf
Uploaded by Michael Fitzgerald on May 1, 2024 at 3:22 PM



Engineering Plan

REQUIRED

2 AG-075 10'x36' CM 15'V 70'T LED Smyrna GA 110 IBC_STAMPED Letter.pdf
Uploaded by Michael Fitzgerald on May 1, 2024 at 3:22 PM

History

Date	Activity
5/14/2024, 10:11:41 AM	Joey Staubes altered approval step Review of Sign Permit Application , changed status from Active to On Hold on Record SIGN-24-93
5/1/2024, 3:23:32 PM	approval step Review of Sign Permit Application was assigned to Joey Staubes on Record SIGN-24-93
5/1/2024, 3:23:31 PM	Michael Fitzgerald submitted Record SIGN-24-93
5/1/2024, 3:16:41 PM	Michael Fitzgerald altered Record SIGN-24-93, changed ownerPhoneNo from "" to "215-357-3908"
5/1/2024, 3:16:41 PM	Michael Fitzgerald altered Record SIGN-24-93, changed ownerState from "e" to "VA"
5/1/2024, 3:16:41 PM	Michael Fitzgerald altered Record SIGN-24-93, changed ownerStreetName from "110 FRANKLIN RD BLDG 2" to "FRANKLIN RD BLDG 2"
5/1/2024, 3:16:41 PM	Michael Fitzgerald altered Record SIGN-24-93, changed ownerStreetNo from "" to "110"
5/1/2024, 3:16:41 PM	Michael Fitzgerald altered Record SIGN-24-93, changed ownerEmail from "" to "rorlandoram@aol.com"
5/1/2024, 3:13:35 PM	Michael Fitzgerald started a draft of Record SIGN-24-93

Timeline

Label	Activated	Completed	Assignee	Due Date	Status
✓ Review of Sign Permit Application	5/1/2024, 3:23:32 PM	-	Joey Staubes	-	On Hold
💰 Payment of Permit Fees	-	-	Michael Fitzgerald	-	Inactive
📄 Issuance of Sign Permit	-	-	-	-	Inactive
🔍 Building Inspection-Sign- Electrical	-	-	-	-	Inactive
🔍 Building Inspection-Sign- Footing	-	-	-	-	Inactive
🔍 Building Inspection-Sign- Final	-	-	-	-	Inactive
✓ Completion of Permit	-	-	-	-	Inactive



City of Smyrna, GA

Jul 12, 2024

SIGN-24-93

Review of Sign Permit Application

Sign Permit

Status: On Hold**Became Active:** May 1, 2024**Assignee:** Joey Staubes**Completed:** May 14, 2024

Applicant

Michael Fitzgerald
fitzgeraldland@gmail.com
3162 Johnson Ferry Rd, Ste 260-441
Marietta, GA 30062
678-571-8889

Primary Location

0 HIGHLANDS PKWY SE
SMYRNA, GA 30126

Owner:

Norfolk Southern Combined, Rail Subsidiaries
Tax Dept
110 FRANKLIN RD BLDG 2 ROANOKE, VA 24042

Comments

Joey Staubes , May 3, 2024

Michael,

This is the same location listed on the previous application. I am uploading an aerial image of where I think you are referencing. This location is not in the Smyrna city limits. Please confirm I am looking at the same property.

Joey Staubes , May 14, 2024

Michael,

I am going to put this on application on hold until the address is verified that it is in the City of Smyrna.

Thank you,
Joey Staubes

Joey Staubes , Jun 7, 2024

Michael,

A letter with an appendix has been uploaded in the attachment section showing the subject property is located in the City Mableton. The letter will be sent via certified mail and email as well.

Thank you,
Joey Staubes

...feet for portions of proposed sign to be over 10 feet from any structure, over 10 feet from the edge of the road if no structure exists, and over 25 feet from any point where right-of-way lines intersect for two streets or roads. No reduction in parking.

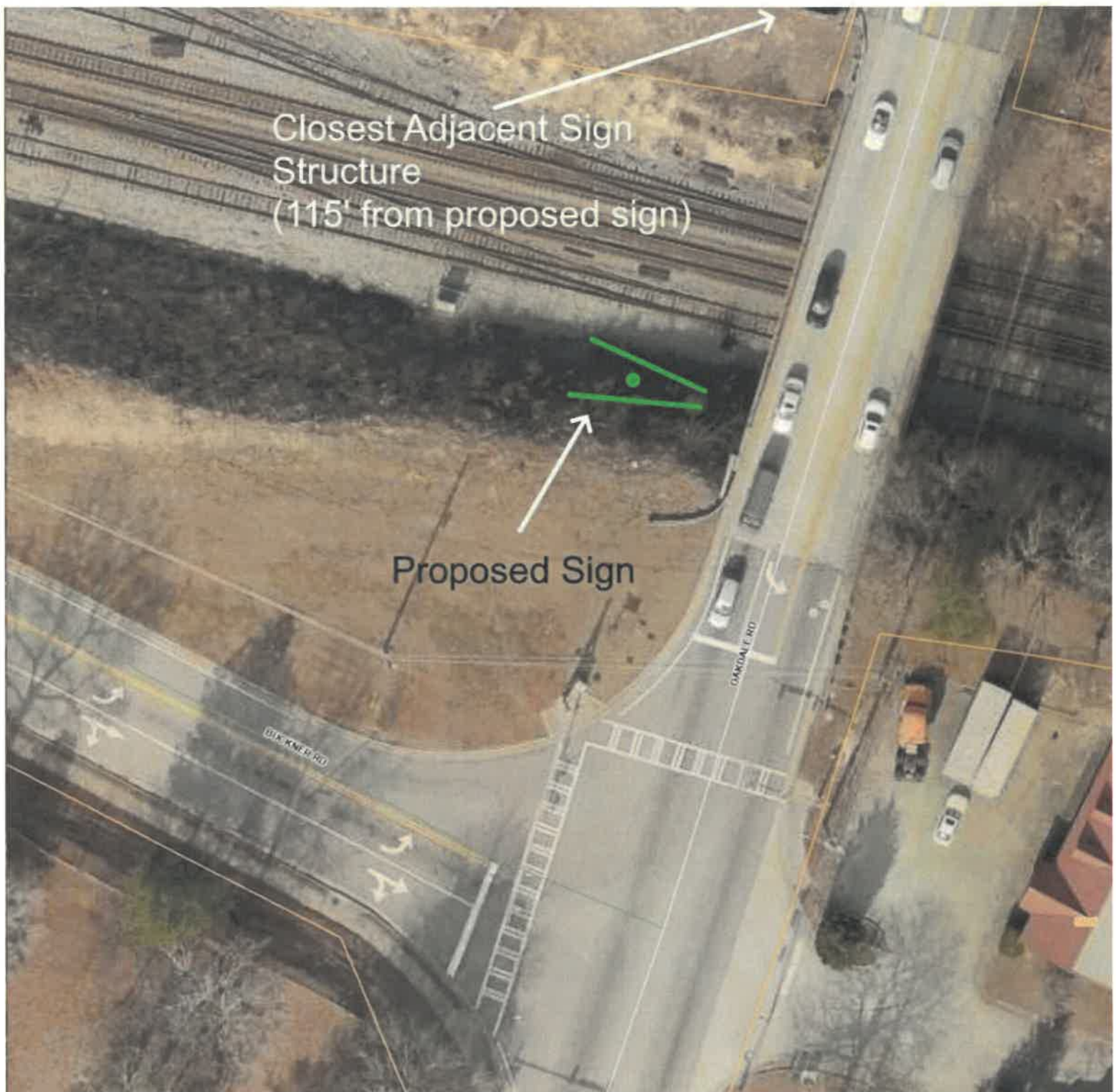

Diagram of Proposed Sign

Size of Subject Parcel: 10+ Acres

Project Address
SW Corner NS RR
ROW & Oakdale Rd
Smarna Georgia

Project Contact
Mike Fitzgerald
(678) 571-8889
Mike@AtlanticBillboards.com

ATLANTIC

STANDARD CONFIGURATION

DESIGN PARAMETERS PER REQUIREMENTS OF
IBC 2018/IBC 2020/ASCE 7-16, 175 mph

MAXIMUM UPRIGHT SPACING: 8'-4 1/8" (2550mm)
ALLOWABLE CANTILEVER: 4'-2 3/4" (1280mm) MAX
CONTINUOUS 4"x4"x8" S.A. LEDGER OR EQUIVALENT

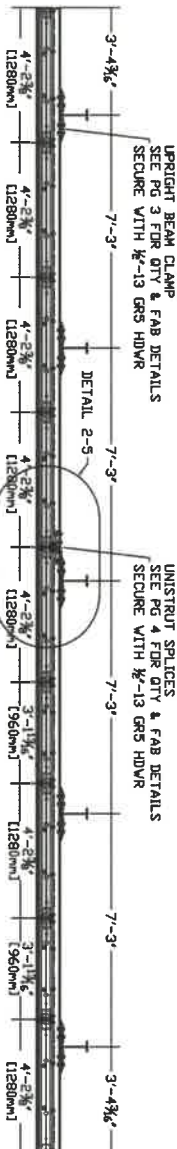

- ## ON-SITE SERVICE REQUIREMENTS
- 1) THE DISPLAY MUST BE ACCESSIBLE THROUGH USE OF A 20 FOOT OR SHORTER LADDER.
 - 2) THERE MUST BE A SECURE CATWALK OR BASE FROM WHICH SERVICE MAY BE PERFORMED.
 - 3) ALL REAR SERVICED DIGITALS REQUIRE CATWALK SPACED AT NO GREATER THAN 7'-6" IN HEIGHT. THERE MUST BE A GUARD RAIL OR A SAFETY LIFELINE SECURELY ATTACHED TO THE SUPPORT STRUCTURE OF THE DISPLAYS AT 6 FEET ACCESSIBLE SITE? IN THE ABSENCE OF AN ACCESSIBLE SITE, THE CUSTOMER IS RESPONSIBLE FOR THE COST OF A BUCKET OR BOOM TRUCK CAPABLE OF PROVIDING SAFE ACCESS TO THE DISPLAY. SERVICE WILL BE PERFORMED ONLY IF THERE IS SAFE ON-SITE ACCESS IN COMPLIANCE WITH APPLICABLE FEDERAL AND LOCAL LAWS AND REGULATIONS.

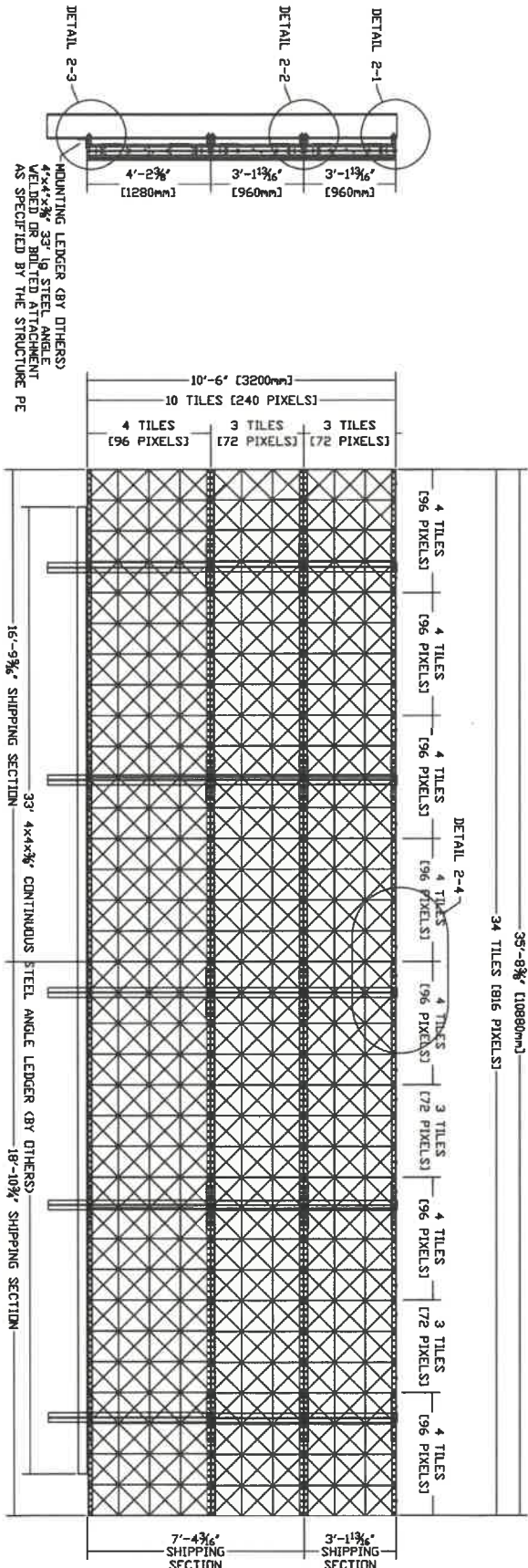

SEE B-2830 FOR POWER RISER AND DATA LAYOUT

PRODUCTION NOTES:

- 1) CABINET POWER PRE-WIRED BY COLUMN
- 2) TRIM COLOR - AS REQ'D
- 3) USE 3/4"-13 GRADE 5 SEPARATED FLANGE BOLTS AND NUTS UNLESS OTHERWISE NOTED
- 4) ALL FABRICATED ALUMINUM AND STEEL PARTS TO BE PAINTED SATIN BLACK.

APPROXIMATE 13.3mm, 16mm, 20mm SIGN WEIGHT - NO TRIM

QUANTITY	DESCRIPTION	UNIT	PRICE
1000	13.3mm		
759#	759#		
150#	150#		
3,935#	3,749#		
0#	0#		
4,944#	4,658#		
4,944#	4,658#		
4,944#	4,658#		

REV	DESCRIPTION	DATE	APPD
A	MISC. UPDATES AND CORRECTIONS	6-29-21	RFV
REV	DESCRIPTION	DATE	APPD
1	DESCRIPTION	DATE	APPD
2	DESCRIPTION	DATE	APPD
3	DESCRIPTION	DATE	APPD
4	DESCRIPTION	DATE	APPD
5	DESCRIPTION	DATE	APPD
6	DESCRIPTION	DATE	APPD
7	DESCRIPTION	DATE	APPD
8	DESCRIPTION	DATE	APPD
9	DESCRIPTION	DATE	APPD
10	DESCRIPTION	DATE	APPD
11	DESCRIPTION	DATE	APPD
12	DESCRIPTION	DATE	APPD
13	DESCRIPTION	DATE	APPD
14	DESCRIPTION	DATE	APPD
15	DESCRIPTION	DATE	APPD
16	DESCRIPTION	DATE	APPD
17	DESCRIPTION	DATE	APPD
18	DESCRIPTION	DATE	APPD
19	DESCRIPTION	DATE	APPD
20	DESCRIPTION	DATE	APPD
21	DESCRIPTION	DATE	APPD
22	DESCRIPTION	DATE	APPD
23	DESCRIPTION	DATE	APPD
24	DESCRIPTION	DATE	APPD
25	DESCRIPTION	DATE	APPD
26	DESCRIPTION	DATE	APPD
27	DESCRIPTION	DATE	APPD
28	DESCRIPTION	DATE	APPD
29	DESCRIPTION	DATE	APPD
30	DESCRIPTION	DATE	APPD
31	DESCRIPTION	DATE	APPD
32	DESCRIPTION	DATE	APPD
33	DESCRIPTION	DATE	APPD
34	DESCRIPTION	DATE	APPD
35	DESCRIPTION	DATE	APPD
36	DESCRIPTION	DATE	APPD
37	DESCRIPTION	DATE	APPD
38	DESCRIPTION	DATE	APPD
39	DESCRIPTION	DATE	APPD
40	DESCRIPTION	DATE	APPD
41	DESCRIPTION	DATE	APPD
42	DESCRIPTION	DATE	APPD
43	DESCRIPTION	DATE	APPD
44	DESCRIPTION	DATE	APPD
45	DESCRIPTION	DATE	APPD
46	DESCRIPTION	DATE	APPD
47	DESCRIPTION	DATE	APPD
48	DESCRIPTION	DATE	APPD
49	DESCRIPTION	DATE	APPD
50	DESCRIPTION	DATE	APPD
51	DESCRIPTION	DATE	APPD
52	DESCRIPTION	DATE	APPD
53	DESCRIPTION	DATE	APPD
54	DESCRIPTION	DATE	APPD
55	DESCRIPTION	DATE	APPD
56	DESCRIPTION	DATE	APPD
57	DESCRIPTION	DATE	APPD
58	DESCRIPTION	DATE	APPD
59	DESCRIPTION	DATE	APPD
60	DESCRIPTION	DATE	APPD
61	DESCRIPTION	DATE	APPD
62	DESCRIPTION	DATE	APPD
63	DESCRIPTION	DATE	APPD
64	DESCRIPTION	DATE	APPD
65	DESCRIPTION	DATE	APPD
66	DESCRIPTION	DATE	APPD
67	DESCRIPTION	DATE	APPD
68	DESCRIPTION	DATE	APPD
69	DESCRIPTION	DATE	APPD
70	DESCRIPTION	DATE	APPD
71	DESCRIPTION	DATE	APPD
72	DESCRIPTION	DATE	APPD
73	DESCRIPTION	DATE	APPD
74	DESCRIPTION	DATE	APPD
75	DESCRIPTION	DATE	APPD
76	DESCRIPTION	DATE	APPD
77	DESCRIPTION	DATE	APPD
78	DESCRIPTION	DATE	APPD
79	DESCRIPTION	DATE	APPD
80	DESCRIPTION	DATE	APPD
81	DESCRIPTION	DATE	APPD
82	DESCRIPTION	DATE	APPD
83	DESCRIPTION	DATE	APPD
84	DESCRIPTION	DATE	APPD
85	DESCRIPTION	DATE	APPD
86	DESCRIPTION	DATE	APPD
87	DESCRIPTION	DATE	APPD
88	DESCRIPTION	DATE	APPD
89	DESCRIPTION	DATE	APPD
90	DESCRIPTION	DATE	APPD
91	DESCRIPTION	DATE	APPD
92	DESCRIPTION	DATE	APPD
93	DESCRIPTION	DATE	APPD
94	DESCRIPTION	DATE	APPD
95	DESCRIPTION	DATE	APPD
96	DESCRIPTION	DATE	APPD
97	DESCRIPTION	DATE	APPD
98	DESCRIPTION	DATE	APPD
99	DESCRIPTION	DATE	APPD
100	DESCRIPTION	DATE	APPD

FORMETCO

2963 Pleasant Hill Rd. Duluth, GA 30096-3811

13.3mm 240 x 816 DBB U-STRUT MT

10'-6" x 35'-8" 13.3mm FTX-A DBB

10'-6" x 35'-8" 13.3mm FTX-A DBB

I-BEAM CLAMPS
FOR SCOREBOARD

The diagram shows a circular structure with a grid of diagonal lines. A horizontal line across the middle is labeled 'I-BEAM CLAMPS FOR SCOREBOARD'. The clamps are represented by small circles along this line.

$2\frac{7}{8} \times 1\frac{1}{2}$ "
 U-STRUT
 I-BEAM
 CLAMP
 $\frac{1}{2}$ "-13x2 $\frac{1}{2}$ " GRS BOLT
 2 PER I-BEAM CLAMP

Diagram illustrating a 1-beam clamp assembly. The assembly includes a 2 7/8" x 1 5/8" U-STRUT, a 1-BEAM CLAMP, a 1/2"-13x2 1/4" GRS BOLT, and 4 PER 1-BEAM CLAMP. The assembly is shown being applied to a SHIPING SPLIT.

Technical drawing of a cabinet channel assembly. The drawing shows a cross-section of the assembly with various components and dimensions labeled:

- 3 1/4" x 1 3/8" U-STRUT**: Dimension for the main U-Strut.
- 1" BEAM CLAMP**: Dimension for the beam clamp.
- 1/2" - 13 x 2 1/2" 2 PER 1'-B**: Dimension for the beam clamp bolts.
- SHIPPING SPLIT**: Label for the shipping split.
- 3/8" - 16 x 1.25" GRS HEX BOLT CONNECTS U-STRUT TO CABINET CHANNEL**: Label for the bolt connecting the U-Strut to the cabinet channel.

DETAIL 2-3
BOTTOM SECTION
COLUMN ATTACHMENT
ASSY IN FIELD BY OTHERS
SCALE 4X

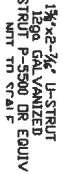

<div> <div>FORMETCO</div> <div> 2963 Pleasant Hill Rd., Duluth, GA 30056-3800 U-STRUT UPRIGHT CONNECTION DETAIL 10'-6" x 35'-8" 13.3mm FTX-A DBB </div> </div>				<div> <div>PART NUMBER</div> <div>FTX-A DBB</div> </div>	
<div> <div>APPROVALS</div> <div> <div>DATE</div> <div>BY</div> </div> </div>				<div> <div>DO NOT SCALE</div> <div>DATE</div> </div>	
<div> <div>REV</div> <div>DESCRIPTION</div> <div>DATE</div> <div>APPD</div> </div>				<div> <div>1</div> <div>U-STRUT UPRIGHT CONNECTION DETAIL</div> <div>08-2-20</div> <div>10-20-20</div> </div>	
<div> <div>THIS MATERIAL IS THE EXCLUSIVE CONFIDENTIAL PROPERTY OF FORMETCO, INC.</div> <div>ALL RIGHTS, INCLUDING COPYRIGHT AND PATENT RIGHTS, ARE RESERVED BY FORMETCO, INC.</div> </div>				<div> <div>2</div> <div>REVISED</div> <div>08-2-20</div> <div>10-20-20</div> </div>	

STANDARD CONFIGURATION

18'-10" STOCK LENGTH

18'-10" USE FULL LENGTH - NO CUT

UNISTRUT CUT PLAN 18 TILES
6 REQUIRED

18'-10" STOCK LENGTH

16'-8 13/16" CUT LENGTH

UNISTRUT CUT PLAN 16 TILES
6 REQUIRED

2'-1 3/16" DROP

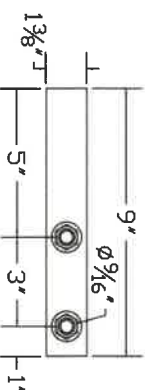
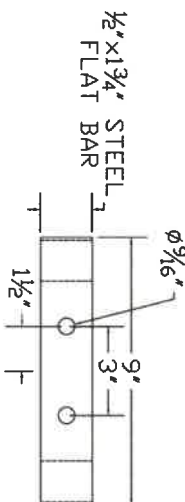
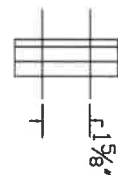
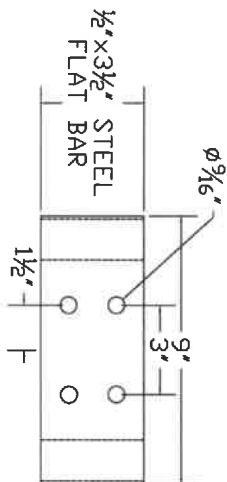
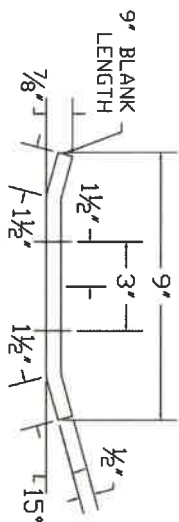
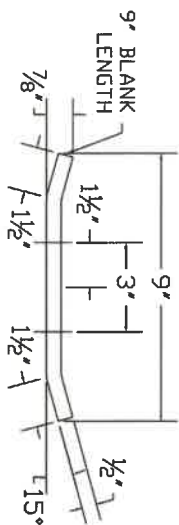
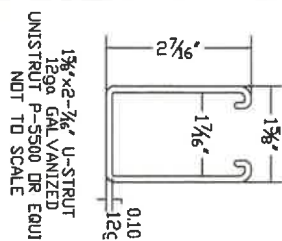

FORMED I-BEAM CLAMP

DOUBLE WIDTH

3 1/2" x 1/2" FLAT BAR

PAINT GRAY

SCALE 4X

QTY = 20 REQ'D

FORMED I-BEAM CLAMP

SINGLE WIDTH

1 3/4" x 1/2" FLAT BAR

PAINT GRAY

SCALE 4X

QTY = 20 REQ'D

UNISTRUT CLAMP BOLT PLATE

1.375" x 9" FLAT

12ga GALVANNEAL

SCALE 4X

QTY = 60 REQ'D

NOTE:
GRAY UPRIGHT BEAM CLAMP - 1/2" THICK

PART NUMBER				FORMETCO			
FTX-A DBB				2963 Pleasant Hill Rd. Duluth, GA 30096-381			
APPROVALS				U-STRUT & I-BEAM CLAMP FABRICATED			
REV	MISC. UPDATES AND CORRECTIONS	DATE	REV	DATE	REV	DATE	REV
REVISIONS				10'-6" x 35'-8" 13.3mm FTX-A DBB			
THIS MATERIAL IS THE EXCLUSIVE CONFIDENTIAL PROPERTY OF FORMETCO, INC.				DWG N 0000			
ALL RIGHTS, INCLUDING COPYRIGHT AND PATENT RIGHTS, ARE RESERVED BY FORMETCO, INC.				DWG N 0000			

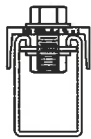
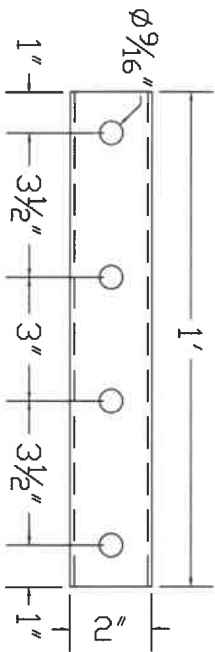

TOP/BOT UNISTRUT SPLICE
2"x1"x $\frac{3}{16}$ " BAR CHANNEL
SCALE 4X
QTY = 2 REQ'D

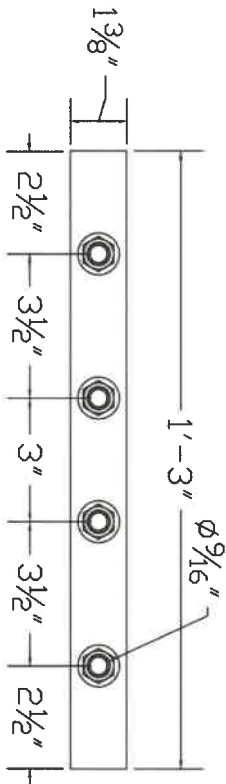

UNISTRUT SPLICE BOLT PLATE
1.375" x 15" FLAT
12ga GALVANNEAL
SCALE 4X
QTY = 6 REQ'D

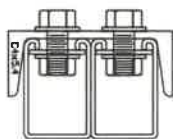
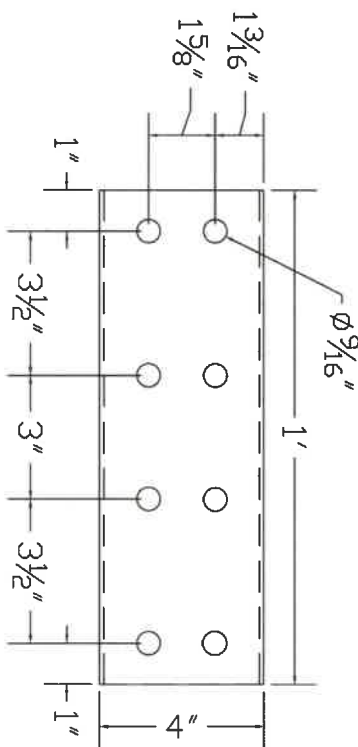

MID DBL UNISTRUT SPLICE
C4 x 5.4 CHANNEL
SCALE 4X
QTY = 2 REQ'D

PART NUMBER				2963 Pleasant Hill Rd. Duluth, GA 30096-38			
FTX-A DBB				U-STRUT SPLICES FABRICATION			
APPROVALS				10'-6"x35'-8" 13.3mm FTX-A DBB			
REV				DATE			
DESCRIPTION				APPD			
REVISIONS				DATE			
THIS MATERIAL IS THE EXCLUSIVE CONFIDENTIAL PROPERTY OF FORMETCO, INC.				8-22-23			
ALL RIGHTS, INCLUDING COPYRIGHT AND PATENT RIGHTS, ARE RESERVED BY FORMETCO, INC.				DWG			

FORMETCO

STANDARD CONFIGURATION

(27) F-TILE CABINETS

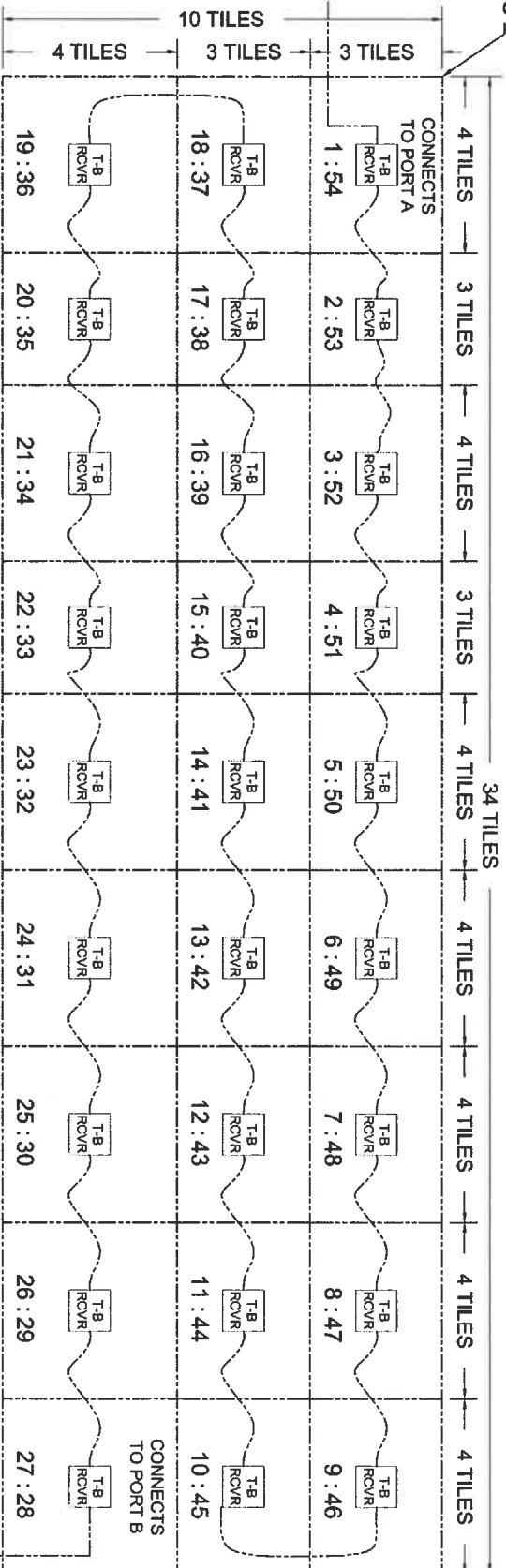

CAT 6-100ft

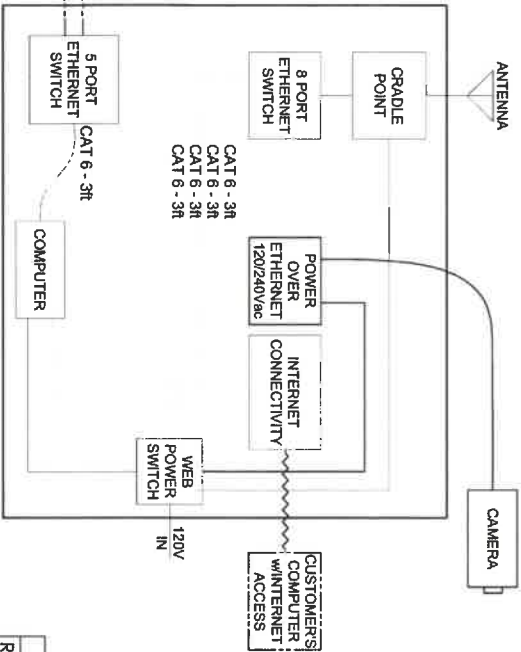

NOTE: CABINETS SHOWN AS VIEWED FROM THE REAR

REV		DESCRIPTION		DATE	APPD	REVISED	6-27-18
<p>THIS MATERIAL IS THE EXCLUSIVE CONFIDENTIAL PROPERTY OF FORMETCO, INC. ALL RIGHTS, INCLUDING COPYRIGHT AND PATENT RIGHTS, ARE RESERVED BY FORMETCO, INC.</p>							
PART NUMBER		FTX-A DBB		APPROVALS		2963 Pleasant Hill Rd. Duluth, GA 30096-381	
FORMETCO							

**POWER CABINET AND BREAKER REQUIREMENTS AND
AMPERAGE AND WATTAGE RATINGS SHOWN
ARE PER DIGITAL DISPLAY UNLESS OTHERWISE INDICATED.**

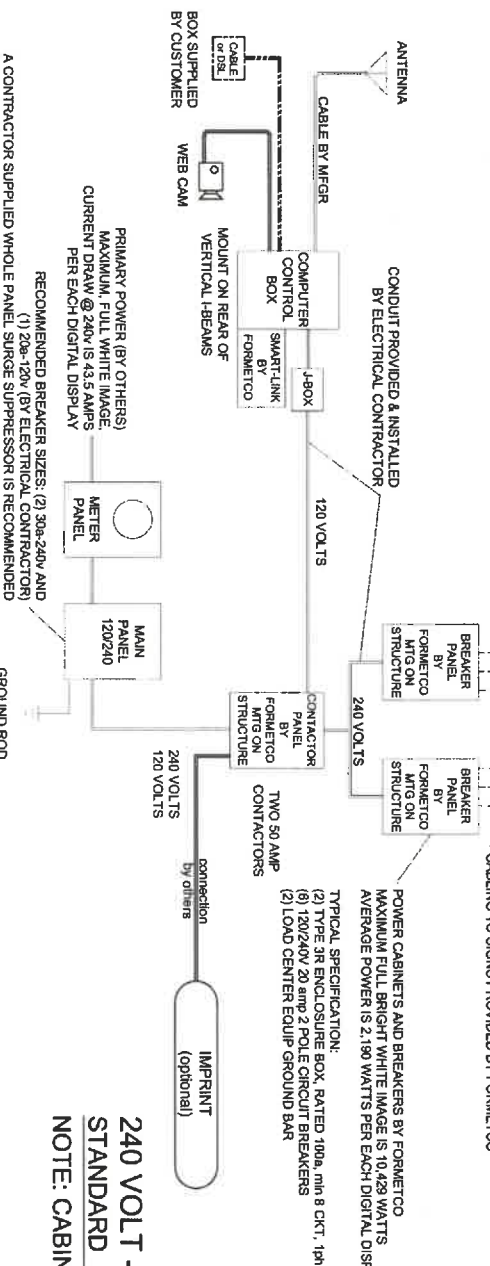
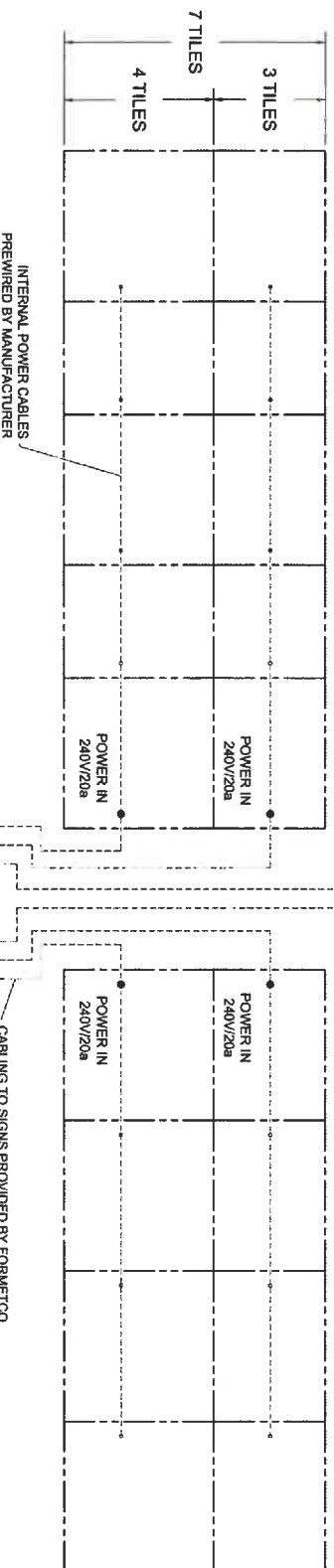
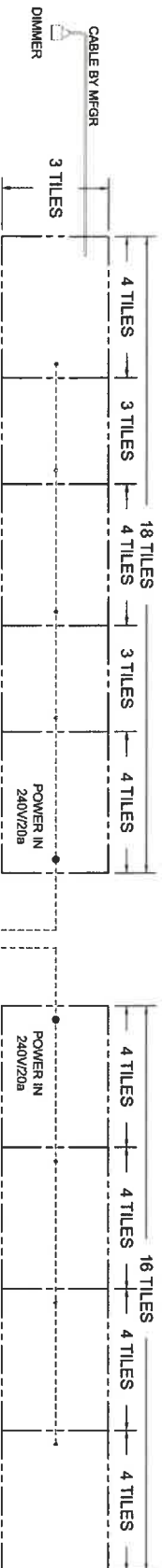

**240 VOLT - 1Ø POWER
STANDARD CONFIGURATION**
NOTE: CABINETS SHOWN AS VIEWED FROM THE REAR

REVISIONS			
REV	DESCRIPTION	DATE	APD
A	MOVE SMARTLINK TO CONTROL BOX AND REVISE NOTES	04-13-23	CJD
REV			

PART NUMBER	FTX-A DBR
APPROVALS	
DESIGNED	08-23
CHECKED	8-22-23
DATE	

2963 Pleasant Hill Rd. Duluth, GA 30096-381	240V - 1Ø ELECTRICAL RISER
240V - 1Ø ELECTRICAL RISER	

Addendum to Sign Permit Application

1. Please note that the online permit submittal portal located at <https://smyrnaga.portal.opengove.com> did not offer an option that matches the type of sign requested. The proposed sign is commonly called a “freestanding sign” or an “off-premise sign.”

Sign Location- Mableton





City of Smyrna

3180 Atlanta Road

Smyrna, Georgia 30080

(678) 631-5387 / Community Development

June 7, 2024

Michael B Fitzgerald, Manager Atlantic Billboards, LLC
3162 Johnson Ferry Rd #260-441
Marietta, GA 30062

RE: Sign Permit: SIGN-24-93
Norfolk Southern ROW at Buckner Rd and Oakdale Rd

The location identified in application SIGN-24-93 is outside the municipal boundaries of the City of Smyrna (See Appendix A); therefore the City of Smyrna cannot issue a permit for the proposed sign and the application is denied. Appendix A reflects the City of Smyrna in yellow and the City of Mableton in blue. The City of Smyrna has no jurisdiction of Oakdale Road between S. Pioneer Drive and Mitchell Road. Additionally, this location was previously referenced in SIGN-24-72 which the applicant acknowledged was outside jurisdiction of the City of Smyrna and subsequently withdrew the application.

Joey Staubes
Planner II
Community Development

Mayor – Derek Norton

City Council Ward 1 – Glen Pickens / Ward 2 – Latonia P. Hines / Ward 3 – Travis Lindley / Ward 4 – Charles Welch
Ward 5 – Susan Wilkinson / Ward 6 – Tim Gould / Ward 7 – Ricky Oglesby, Jr.

City Administrator – Joe Bennett / City Clerk – Heather Corn / City Attorney – Scott Cochran
Municipal Court Judge – Phyllis Gingrey Collins

Appendix A - SIGN-24-93 Location Map



1:9,028

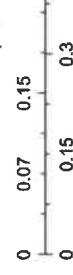

East Community Maps Contributions, City of Atlanta, © OpenStreetMap, Microsoft, Esri, TomTom, Garmin, SafeGraph, GeoTechnologies, Inc., MET/NASA, USGS, EPA, NPS, US Census Bureau, USDA, USFWS, Copyright Cobb County. All rights reserved., Cobb GIS

This map is a user generated static output from an Internet mapping Cobb County GIS

**PROPERTY OWNER AUTHORIZATION**

City of Smyrna Community Development Department, 3180 Atlanta Rd, Smyrna, GA 30080
Office Phone 678-631-5387 / Fax 770-431-2808

I, ROBERT F. ORLANDO AGENT, swear that I am the Property Owner of the property

located at: Norfolk Southern Railroad Southwesterly corner of Oakdale Rd & NS Railroad

as shown in the records of Cobb County, Georgia, which is the subject matter of the attached application.

I authorize the person named below to act as the applicant in pursuit of this application.

Name of Applicant (print clearly): Atlantic Billboards, LLC, Mike Fitzgerald, Manager

Address: 3162 Johnson Ferry Rd, #260-441, Marietta, GA 30062

Telephone: 678-571-8889 Email: Mike@AtlanticBillboards.com

I have read, understood, and answered the aforementioned items to the best of my knowledge. If I am found to have misrepresented myself on this affidavit or the attached application, I am aware I may be in violation of the City Code and run the risk of being issued a citation for violation of the City of Smyrna Code of Ordinances.

(Must be signed by the property owner. If the landowner is a corporation, the form must be signed by an officer of the corporation.)

[Signature] AGENT
Signature of Property Owner

16 SCOTT DRIVE
Address

ROBERT F. ORLANDO AGENT
Name of Property Owner (print clearly)

CHURCHVILLE, PA 18966
City, State, Zip



CERTIFICATE OF LIABILITY INSURANCE

DATE (MM/DD/YYYY)

02/13/2024

THIS CERTIFICATE IS ISSUED AS A MATTER OF INFORMATION ONLY AND CONFERS NO RIGHTS UPON THE CERTIFICATE HOLDER. THIS CERTIFICATE DOES NOT AFFIRMATIVELY OR NEGATIVELY AMEND, EXTEND OR ALTER THE COVERAGE AFFORDED BY THE POLICIES BELOW. THIS CERTIFICATE OF INSURANCE DOES NOT CONSTITUTE A CONTRACT BETWEEN THE ISSUING INSURER(S), AUTHORIZED REPRESENTATIVE OR PRODUCER, AND THE CERTIFICATE HOLDER.

IMPORTANT: If the certificate holder is an ADDITIONAL INSURED, the policy(ies) must have ADDITIONAL INSURED provisions or be endorsed. If SUBROGATION IS WAIVED, subject to the terms and conditions of the policy, certain policies may require an endorsement. A statement on this certificate does not confer rights to the certificate holder in lieu of such endorsement(s).

PRODUCER STARR-MATHEWS AGENCY P. O. Box 1990 Cartersville GA 30120		CONTACT NAME: Trung Ly PHONE (A/C, No, Ext): (770) 386-0466 E-MAIL ADDRESS: tly@starmathews.com FAX (A/C, No): (770) 386-3164	
INSURED Bowen Auger Service, Inc. P O Box 178 Adairsville GA 30103-0178		INSURER(S) AFFORDING COVERAGE INSURER A: Westfield Insurance Co INSURER B: Builders Insurance INSURER C: INSURER D: INSURER E: INSURER F:	
		NAIC # 24112 10704	

COVERAGES**CERTIFICATE NUMBER:** 2023-24**REVISION NUMBER:**

THIS IS TO CERTIFY THAT THE POLICIES OF INSURANCE LISTED BELOW HAVE BEEN ISSUED TO THE INSURED NAMED ABOVE FOR THE POLICY PERIOD INDICATED. NOTWITHSTANDING ANY REQUIREMENT, TERM OR CONDITION OF ANY CONTRACT OR OTHER DOCUMENT WITH RESPECT TO WHICH THIS CERTIFICATE MAY BE ISSUED OR MAY PERTAIN, THE INSURANCE AFFORDED BY THE POLICIES DESCRIBED HEREIN IS SUBJECT TO ALL THE TERMS, EXCLUSIONS AND CONDITIONS OF SUCH POLICIES. LIMITS SHOWN MAY HAVE BEEN REDUCED BY PAID CLAIMS.

INSR LTR	TYPE OF INSURANCE	ADDL SUBR INSD WVD	POLICY NUMBER	POLICY EFF (MM/DD/YYYY)	POLICY EXP (MM/DD/YYYY)	LIMITS
A	<input checked="" type="checkbox"/> COMMERCIAL GENERAL LIABILITY <input type="checkbox"/> CLAIMS-MADE <input checked="" type="checkbox"/> OCCUR GEN'L AGGREGATE LIMIT APPLIES PER: <input type="checkbox"/> POLICY <input checked="" type="checkbox"/> PROJECT <input checked="" type="checkbox"/> LOC OTHER:		3783172	11/04/2023	11/04/2024	EACH OCCURRENCE \$ 1,000,000 DAMAGE TO RENTED PREMISES (Ea occurrence) \$ 1,000,000 MED EXP (Any one person) \$ 10,000 PERSONAL & ADV INJURY \$ 1,000,000 GENERAL AGGREGATE \$ 2,000,000 PRODUCTS - COMP/OP AGG \$ 2,000,000 Property damage-single \$
A	<input checked="" type="checkbox"/> AUTOMOBILE LIABILITY <input checked="" type="checkbox"/> ANY AUTO <input type="checkbox"/> OWNED AUTOS ONLY <input type="checkbox"/> HIRED AUTOS ONLY <input checked="" type="checkbox"/> SCHEDULED AUTOS <input checked="" type="checkbox"/> NON-OWNED AUTOS ONLY		3783172	11/04/2023	11/04/2024	COMBINED SINGLE LIMIT (Ea accident) \$ 1,000,000 BODILY INJURY (Per person) \$ BODILY INJURY (Per accident) \$ PROPERTY DAMAGE (Per accident) \$ Medical payments \$ 10,000
A	<input checked="" type="checkbox"/> UMBRELLA LIAB <input checked="" type="checkbox"/> EXCESS LIAB <input type="checkbox"/> DED <input type="checkbox"/> RETENTION \$		3783172	11/04/2023	11/04/2024	EACH OCCURRENCE \$ 5,000,000 AGGREGATE \$ 5,000,000 \$
B	<input checked="" type="checkbox"/> WORKERS COMPENSATION AND EMPLOYERS' LIABILITY ANY PROPRIETOR/PARTNER/EXECUTIVE OFFICER/MEMBER EXCLUDED? (Mandatory in NH) If yes, describe under DESCRIPTION OF OPERATIONS below	Y/N Y	WCV002484820	07/14/2023	07/14/2024	<input checked="" type="checkbox"/> PER STATUTE <input type="checkbox"/> OTH-ER E.L. EACH ACCIDENT \$ 1,000,000 E.L. DISEASE - EA EMPLOYEE \$ 1,000,000 E.L. DISEASE - POLICY LIMIT \$ 1,000,000

DESCRIPTION OF OPERATIONS / LOCATIONS / VEHICLES (ACORD 101, Additional Remarks Schedule, may be attached if more space is required)

(GL) CG 7137 12 17 - Signature Series Commercial General Liability Contractors Endorsement.
(GL) CG 25 04 A 05 09 - Designated Location(s) General Aggregate Limit.
(GL) CG 25 03 05 09 - Designated Construction Project(s) General Aggregate Limit.
(GL) CG 20 37 04 13 - Additional Insured - Owners, Lessees or Contractors - Completed Operations.
(GL) CG 20 10 04 13 - Additional Insured - Owners, Lessees or Contractors - Scheduled Person or Organization.
(AUTO) CA 70 77 10 13 - Signature Series Business Auto Endorsement.
(AUTO) CA 70 75 10 13 - Primary and Noncontributory Insurance.

CERTIFICATE HOLDER**CANCELLATION**

Atlantic Billboards, LLC
3162 Johnson Ferry Rd
Ste 260-441
Marietta

GA 30062

SHOULD ANY OF THE ABOVE DESCRIBED POLICIES BE CANCELLED BEFORE THE EXPIRATION DATE THEREOF, NOTICE WILL BE DELIVERED IN ACCORDANCE WITH THE POLICY PROVISIONS.

AUTHORIZED REPRESENTATIVE

© 1988-2015 ACORD CORPORATION. All rights reserved.

BARTOW COUNTY, GEORGIA HOME BASED

VALID 01/01/2024 THROUGH 01/01/2025

BUSINESS NAME/ADDRESS	OWNER NAME	BUSINESS DESCRIPTION
BOWEN AUGER SERVICES, INC. 326 PLEASANT VALLEY RD ADAIRSVILLE, GA 30103	BOWEN JEROME D	

LICENSE FEES PAID	LICENSE OFFICIAL	LICENSE NUMBER
180.00		HO14

THIS LICENSE IS GRANTED BY THE BARTOW COUNTY COMMUNITY DEVELOPMENT DEPARTMENT AND ACCEPTED BY LICENSEE SUBJECT TO ALL OF THE TERMS AND CONDITIONS OF THE ORDINANCES GOVERNING THE ISSUANCE AND RETENTION OF THE SAME.

* Please note, license fee amount does not include an administrative fee of \$30

DISPLAY IN A CONSPICUOUS LOCATION. MAY BE REVOKED FOR CAUSE.

NOTE: 18" UPPER & LOWER INSIDE CATWALKS NOT SHOWN FOR CLARITY

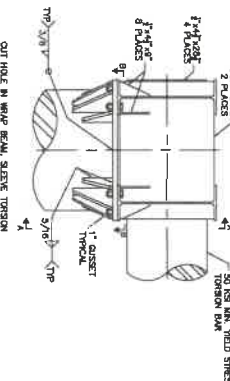
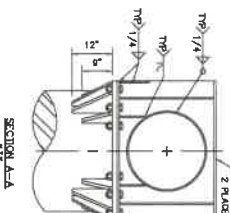
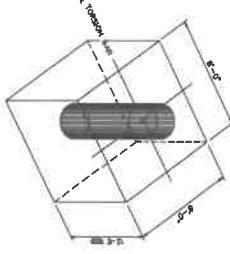
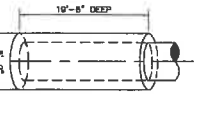
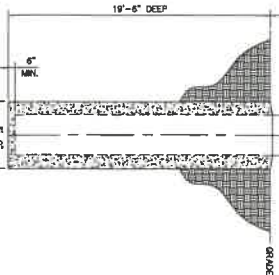
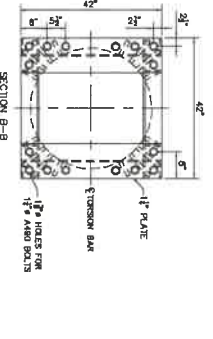
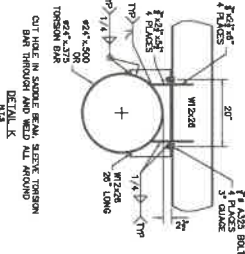
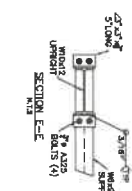
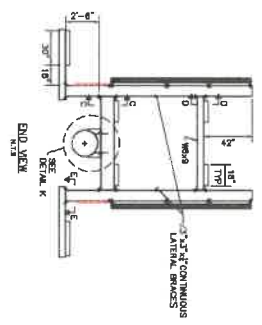
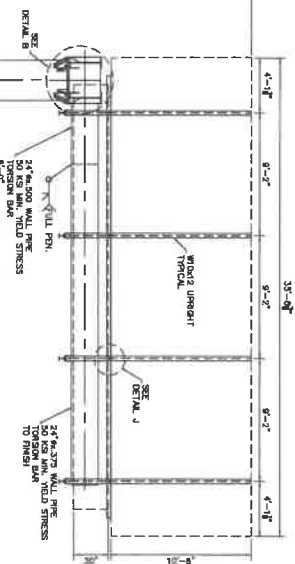
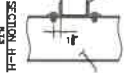
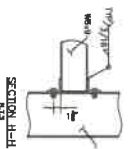
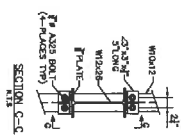
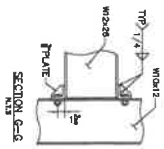
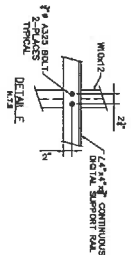
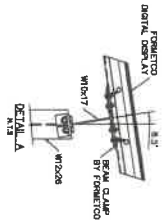

NOTE: 15" UPPER & LOWER INSIDE
CATWALKS NOT SHOWN FOR CLARITY

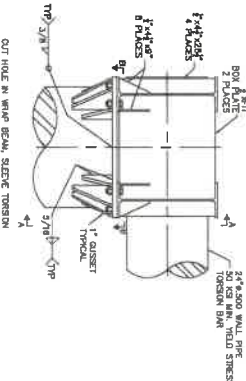
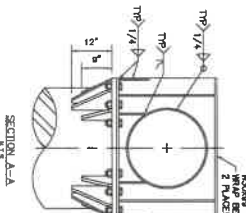
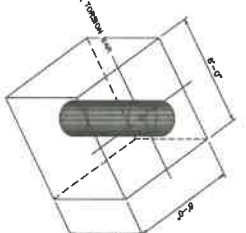
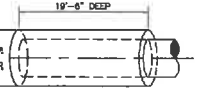
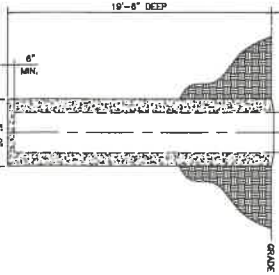
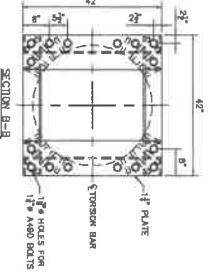
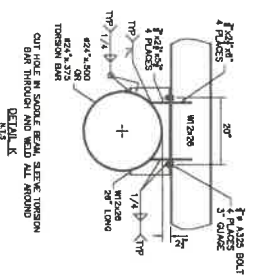
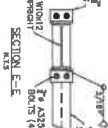
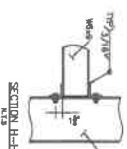
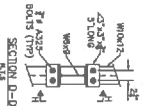
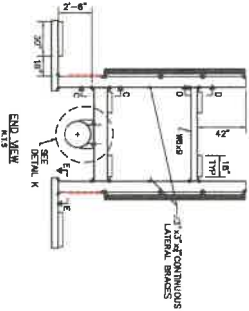
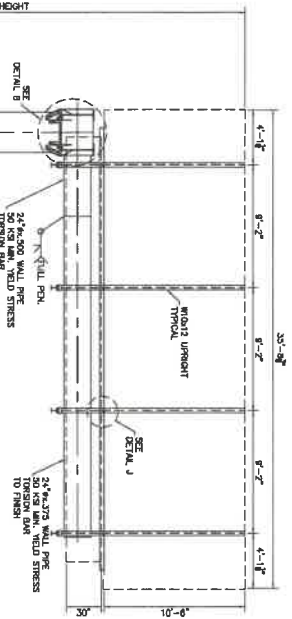
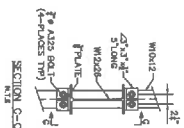
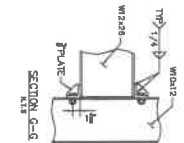
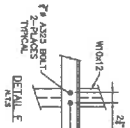
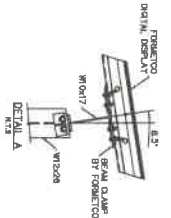
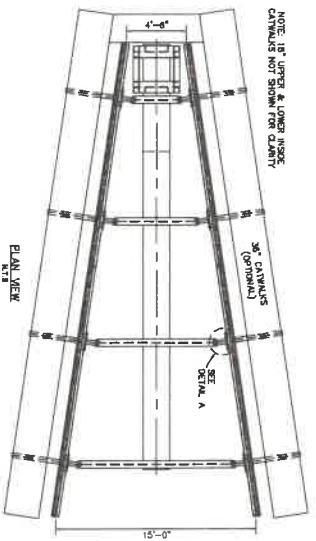

above sweeping space. Urban noted that while

UNIT 1	AC-076
UNIT 2	AC-077
UNIT 3	AC-078
UNIT 4	AC-079
UNIT 5	AC-080
UNIT 6	AC-081
UNIT 7	AC-082
UNIT 8	AC-083
UNIT 9	AC-084
UNIT 10	AC-085
UNIT 11	AC-086
UNIT 12	AC-087
UNIT 13	AC-088
UNIT 14	AC-089
UNIT 15	AC-090
UNIT 16	AC-091
UNIT 17	AC-092
UNIT 18	AC-093
UNIT 19	AC-094
UNIT 20	AC-095
UNIT 21	AC-096
UNIT 22	AC-097
UNIT 23	AC-098
UNIT 24	AC-099
UNIT 25	AC-100

1. NAME	2. ADDRESS	3. CITY	4. STATE	5. ZIP
6. PHONE	7. FAX	8. E-MAIL	9. COMMENTS	10. SIGNATURE
11. DATE	12. TIME	13. BY	14. FOR	15. TOTAL

REMARKS:	TCS
DATE:	02/10/24
SUBJECT:	Permitting
SCALE:	1/4" = 1'-0"
PROJ. #	#####
DATE	AC-076
DRW	1-08