

ALCOHOLIC BEVERAGE LICENSE SURVEY  
PREPARED FOR:  
**KEYSAC ENTERPRISES, LLC/DBA:  
EL ENCANTO**  
LAND LOT 378, 17TH DISTRICT  
2ND SECTION, COBB COUNTY, GEORGIA

**SURVEY NOTES: NEAREST DISTANCE TO:**

- Private Residence: 600 Plaza Dr SE, Smyrna, GA 30082 (216 Yards)
- Church: Smyrna Church of the Nazarene, 531 Plaza Dr SE, Smyrna, GA 30082 (704 Yards)
- Public School: Belmont Hills Elementary School, 605 Glendale Pl, Smyrna, GA 30080 (1,056 Yards)
- Package Store: First Choice Beer, Wine & Spirits, 2900 S Cobb Dr SE Suite B1, Smyrna, GA 30082 (37.4 Yards)
- College: Chattahoochee Technical College - Marietta Campus, 980 S Cobb Dr SE, Marietta, GA 30060 (6,160 Yards)
- Daycare: Compass Academy Preschool and Childcare, 2820 Cobb Ln, Smyrna, GA 30082 (190 Yards)
- Public Park: Cobb Park and Kidscape Village I & II, 2776 Sanford Rd SE, Smyrna, GA 30080 (1,056 Yards)
- Public Library: Smyrna Public Library, 100 Village Green Cir SE, Smyrna, GA 30080 (2,112 Yards)
- Alcohol Treatment Center: Rebos Inc, 304 Poplar St, Marietta, GA 30060 (4,048 Yards)
- Public Pool: Wolfe Aquatic Center, 884 Church St, Smyrna, GA 30080 (1,408 Yards)

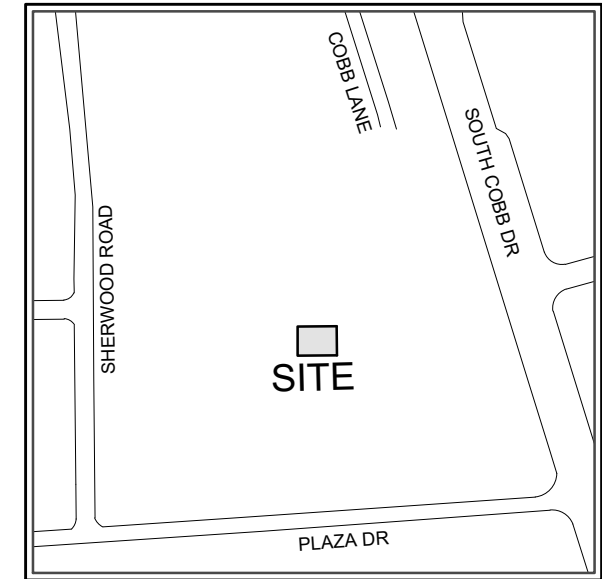
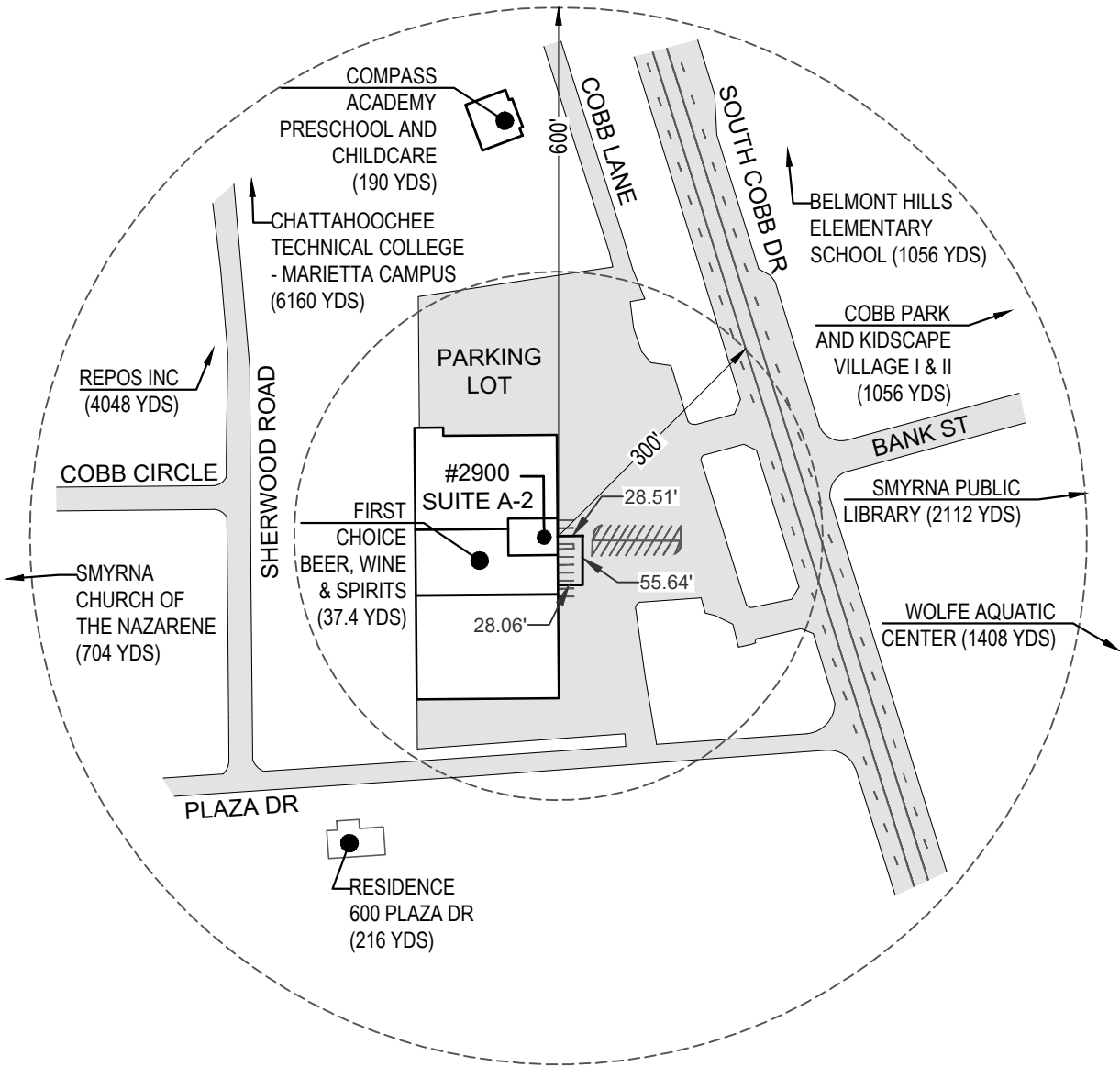

**VICINITY MAP**

N.T.S.

**MEASUREMENT METHOD:**  
DISTANCES SHALL BE MEASURED BY THE MOST  
DIRECT ROUTE OF TRAVEL ON THE GROUND.

**GRAPHIC SCALE**

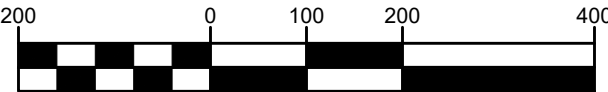

( IN FEET )  
1 inch = 200 ft.

UNITED LAND SURVEYING, LLC. ALL RIGHTS ARE RESERVED. ANY POSSESSION, REPRODUCTION OR OTHER USE OF THIS DOCUMENT WITHOUT PRIOR WRITTEN PERMISSION FROM UNITED LAND SURVEYING, LLC. IS EXPRESSLY PROHIBITED.

JOB NUMBER:  
**24-439**

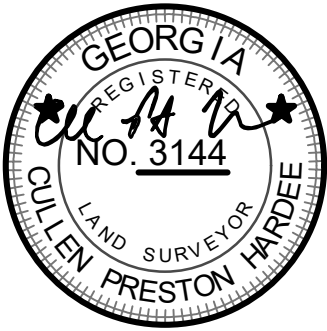

PLAT DATE: 9/27/2024  
FIELD DATE: 9/12/2024  
SCALE: 1"=200'  
DRAWN BY: C.E.M.  
REVIEWED BY: C.P.H.

REVISIONS	
1.	
2.	
3.	
4.	
LEGAL REFERENCE:	
DEED BOOK: 13610	PAGE: 6181
PLAT BOOK: 32	PAGE: 78

SHEET 1 OF 1

ALCOHOLIC BEVERAGE LICENSE SURVEY  
KEYSAC ENTERPRISES, LLC/DBA: EL ENCANTO  
LAND LOT 378, 17TH DISTRICT  
2ND SECTION, COBB COUNTY  
GEORGIA

1258 CONCORD ROAD SE SUITE 103  
SMYRNA, GEORGIA 30080  
Ph. (678) 293-5232

VISIT US ON OUR WEBSITE:  
[www.united-uls.com](http://www.united-uls.com)

**UNITED LAND SURVEYING**  
COA NO. LSF 001321