

Storm water mitigation plan

3036 Lee st
Smyrna, GA 30080

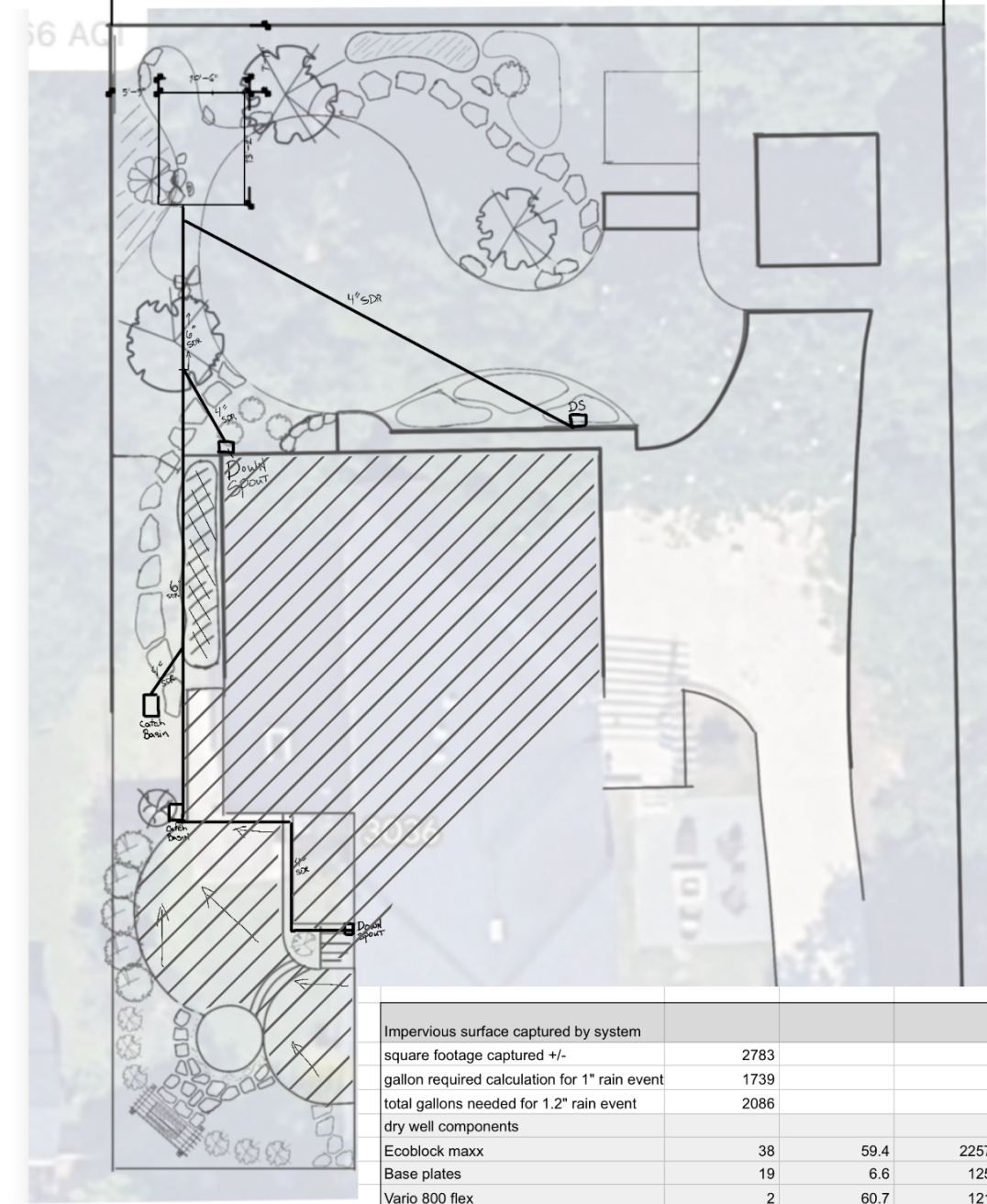

Impervious surface captured by system			
square footage captured +/-	2783		
gallon required calculation for 1" rain event	1739		
total gallons needed for 1.2" rain event	2086		
dry well components			
Ecobloc maxx	38	59.4	2257.2
Base plates	19	6.6	125.4
Vario 800 flex	2	60.7	121.4
Total gallon capacity not including 6" gravel base			2504

Total lot size. .4445 acre	19362	30.01%
Total new impervious sq ft with deduction for storm water capture	5810	
house	3522	18.19%
existing concrete patio included in new patio	0	0.00%
existing driveway	2767	14.29%
existing sidewalk	421	2.17%
existing shed	106	0.55%
New patio	604	3.12%
slate patio by firepit	300	1.55%
existing stepping stones	33	0.17%
existing gravel behind shed	558	2.88%
existing brick column	28	0.14%
New stepping stones/boulders	162	0.84%
wood deck with landscape below	92	0.48%
Sq ft storm water captured. (hashed area)	-2783	-14.37%

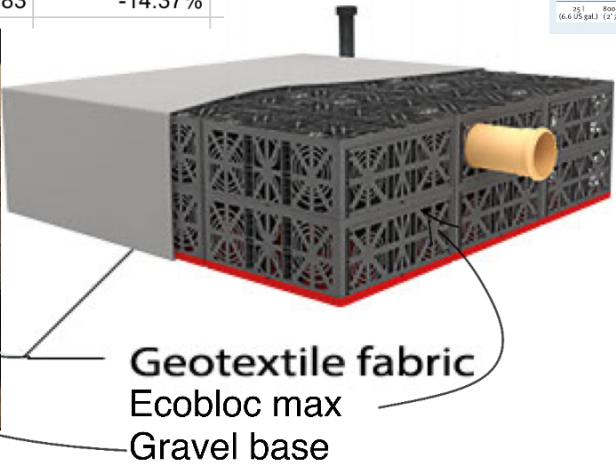
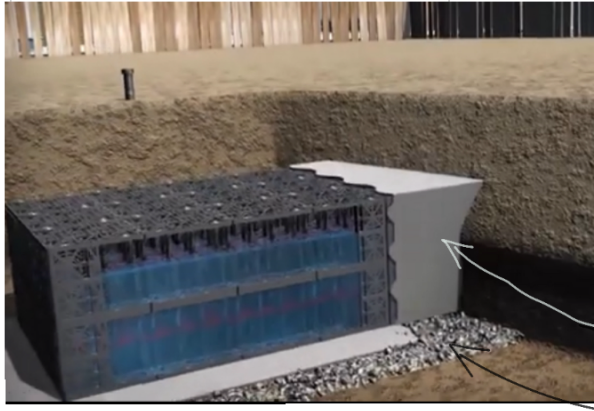

GRAF EcoBloc Configurator

08/2024

Otto Graf GmbH
Kunststoffereignisse
Carl-Zeiss-Straße 2-6
D-79331 Teningen
Tel.: +49 7641 589-0
Fax: +49 7641 589-50
www.graf.info
mail@graf.info

Project address:
Surrounding Landscapes
3306 Lee St.
30080 Smyrna
United States

Provided:
Russell Jackson
4475 Alicia Lane
GA 30028 Cumming
United States
Tel.: +1 770-889-2533
Fax:
E-Mail: russ@rainharvest.com

Data:

Application
Infiltration

Loading
Pedestrian

Installation parameters
Min. earth covering: 2" 0.0" (0.61 m)
Max. earth covering: 2" 11.8" (0.91 m)

Product selection
Ecobloc maxx

Tank sizes
Length: 13' 1.5" (4.00 m) (5 Pieces)
Width: 10' 6.0" (3.20 m) (4 Pieces)
Height: 2' 5.5" (0.75 m) (2 Pieces)
Layers: 2

Tank volume
Gross: 2,527.8 US gal. (9.57 m³ / 338 ft³)
Net: 2,411.4 US gal. (9.13 m³ / 322 ft³)

Inspection and cleaning
No inspection and cleaning

Shafts
Inlet shafts: 1

Inlets
Number: 1
Largest inlet: DN (nominal width) 160

The Ecobloc inspect flex crates are furnished with an inspection channel, which allows access by commercially available inspection vehicles as well as the possibility of high pressure jetting. The access is ideally created with the Vario 800 shaft system.

Installation instruction

Installation scheme

Surrounding Landscapes

Base layer

Top view

Front view

1. Layer to 2. Layer

Top view

Front view

Ecobloc maxx

Ecobloc maxx base plate

38 blocks

19 ->

Vario 800 flex shaft system

Vario 800 flex, type 1
shaft body for one or more layers of Ecobloc system

Vario 800 flex, type 2
shaft body for one or more layers of Ecobloc system

Vario 800 flex, base/cover set
base and cover for Vario 800 flex shaft



Existing impervious surfaces

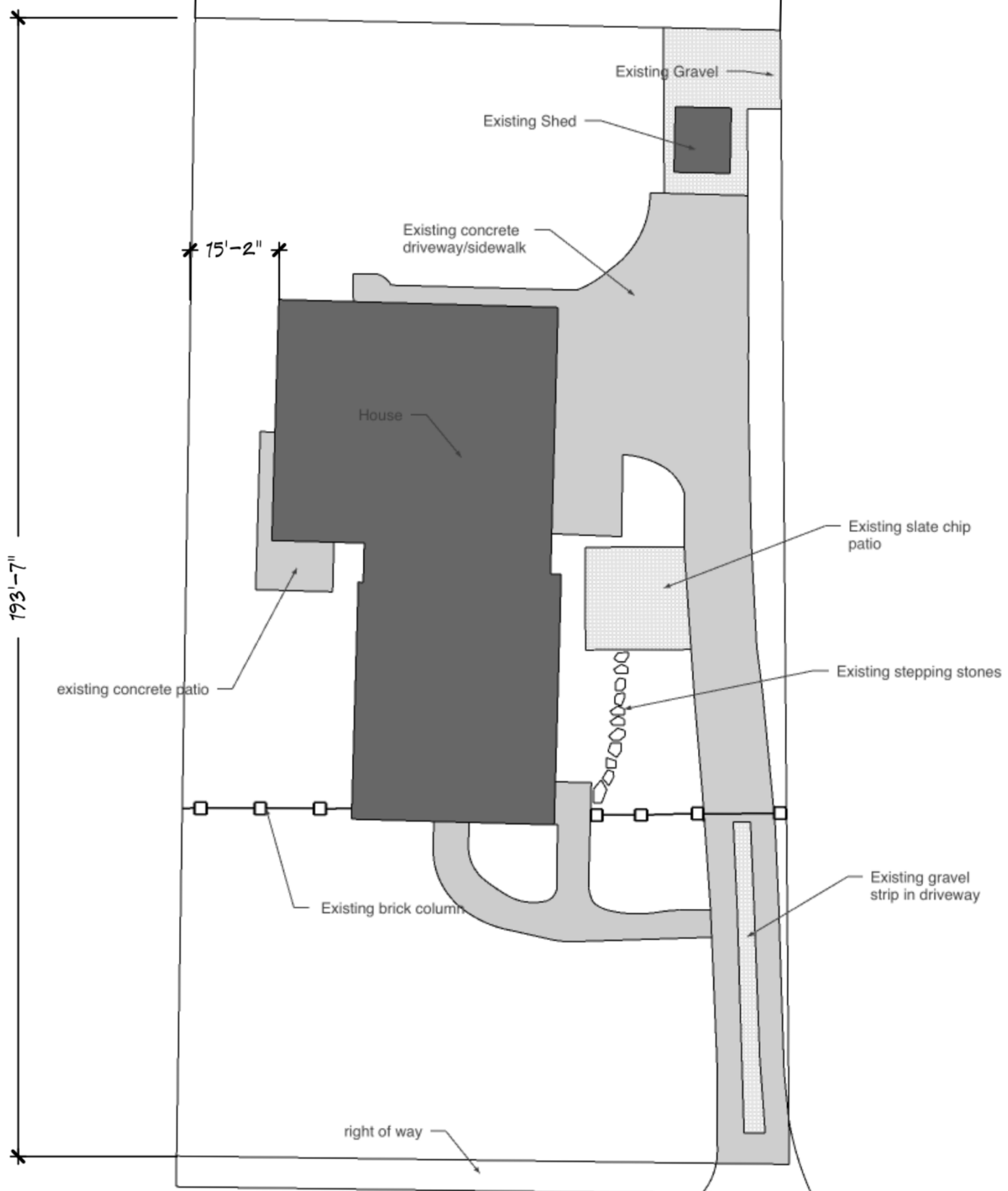

	Square footage		% of property
Total lot size. .4445 acre	19362	+/-	41.00%
Total impervious	7890	+/-	
house	3522	+/-	18.19%
existing concrete patio	155	+/-	0.80%
existing driveway	2767	+/-	14.29%
existing sidewalk	421	+/-	2.17%
existing shed	106	+/-	0.55%
slate patio by firepit	300	+/-	1.55%
existing stepping stones	33	+/-	0.42%
existing gravel behind shed	558	+/-	2.88%
Existing brick columns	28	+/-	0.14%

3036 Lee st
Smyrna, GA