

City of Smyrna - Ray's Park

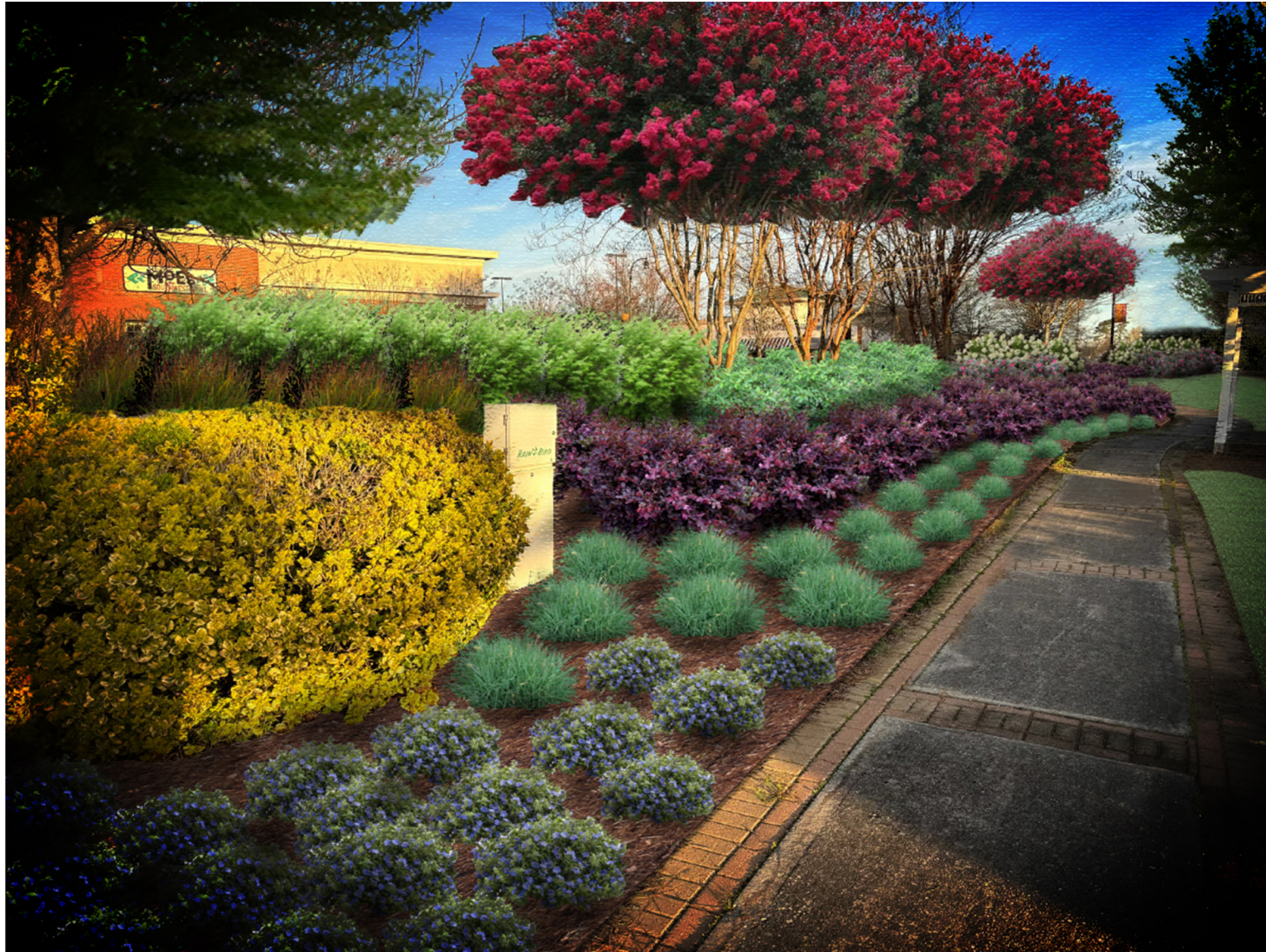

Remove juniper on left side of sidewalk, and throughout the park, and replace with evergreen and deciduous shrubs providing color and texture year round. Incorporate perennials on the ground plane to accent shrubs and provide additional color



Add in pockets of turf to reduce the amount of bed space and required plant material, also reducing the need for pine straw. These pockets of turf will accent all plantings and accentuate the movement within the landscape.